

BENCHMARKS:

"□" Cut in top of curb south end of east curb return 10th St. & Forestview adjacent to Lot 9, Block A, Liberty Park 3rd Addition Elev. = 168.43 (City Datum)

"□" Cut in top of curb 10' east of end of existing pavement adjacent to Lot 52, Block C, Liberty Park 3rd Addition Elev. = 164.21 (City Datum)

C.O.W. Benchmark Disk. 56' E and 55' N of @ 135th St. W. & 13th St. N. Elev. = 167.83 (City Datum)

C.O.W. Benchmark Disk. 1/2 mile south of 13th St. 39' east of @ 135th St. 18' south of hedge row. Elev. = 159.71 (City Datum)

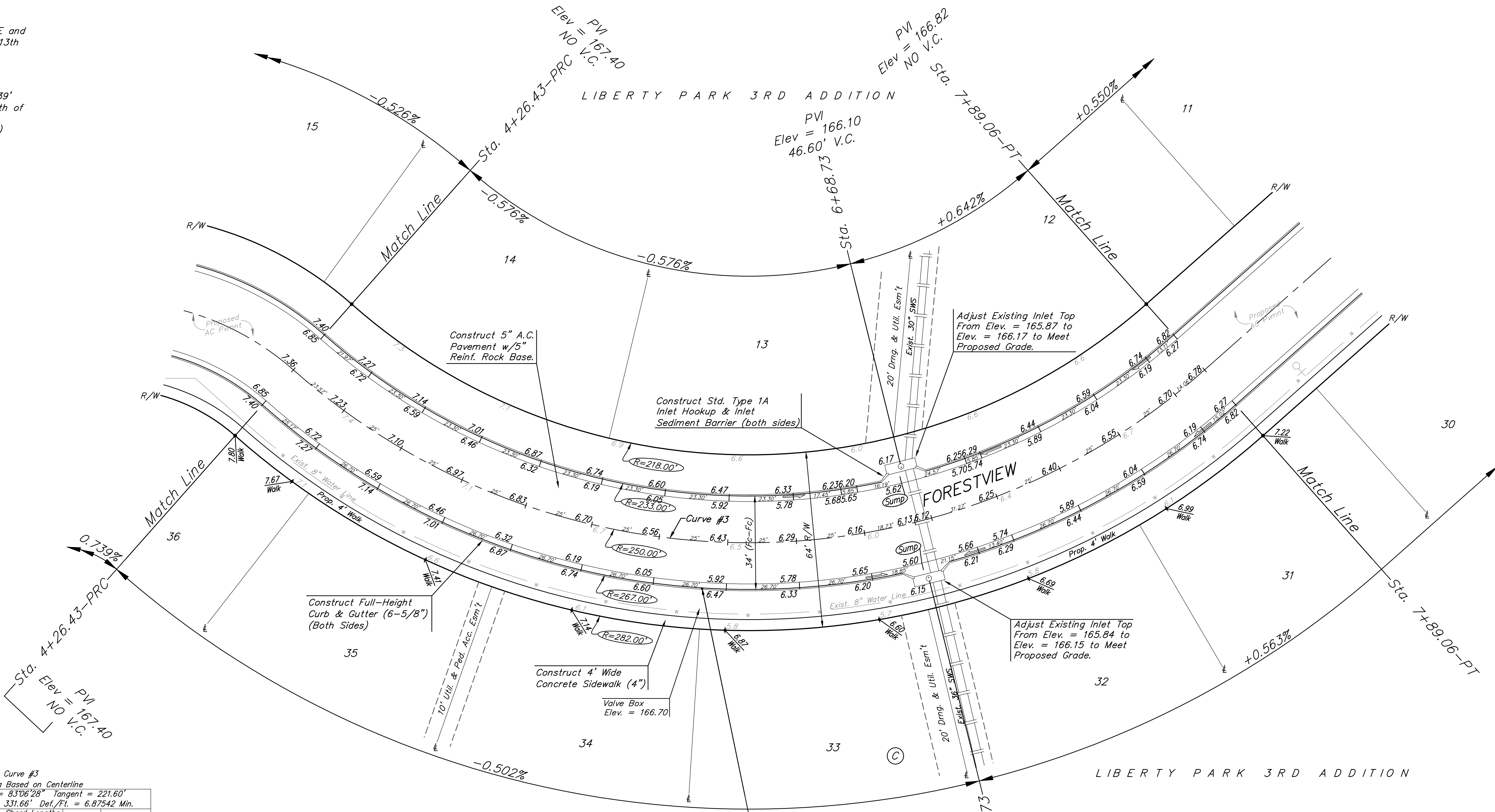
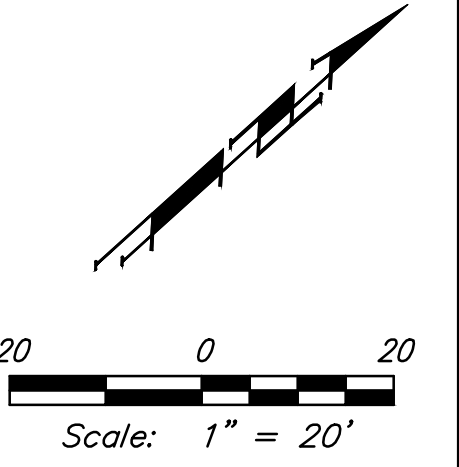

Curve #3
Curve Data Based on Centerline
Rad. = 250' Delta = 83°06'28" Tangent = 221.60'
Arc = 362.63' L.C. = 331.66' Def./Fl. = 6.87542 Min.

Station	Face Chord Lengths			Total Defl.
	Arc	8' Left	8' Right	
4+26.43	-	-	-	0°00'00"
4+50.00	23.57'	21.20'	25.92'	2°42'03"
4+75.00	25.00'	22.49'	27.49'	5°33'56"
5+00.00	25.00'	22.49'	27.49'	8°25'49"
5+25.00	25.00'	22.49'	27.49'	11°17'43"
5+50.00	25.00'	22.49'	27.49'	14°09'36"
5+75.00	25.00'	22.49'	27.49'	17°01'29"
6+00.00	25.00'	22.49'	27.49'	19°53'22"
6+25.00	25.00'	22.49'	27.49'	22°45'15"
6+50.00	25.00'	22.49'	27.49'	25°37'08"
6+75.00	25.00'	22.49'	27.49'	28°29'01"
7+00.00	25.00'	22.49'	27.49'	31°20'55"
7+25.00	25.00'	22.49'	27.49'	34°12'48"
7+50.00	25.00'	22.49'	27.49'	37°04'41"
7+75.00	25.00'	22.49'	27.49'	39°56'34"
7+89.06	14.06'	12.65'	15.46'	41°33'14"

Sta. 5+91.75, 17.25' Rt. Install Subdivision Benchmark (Flat survey marker No. 8134-08 3" top diameter) in top of curb. Cost shall be incidental to L.F. Curb & Gutter.

		Liberty Park 3rd Addition - Phase 2B	
		FORESTVIEW STA. 4+26.23 to STA. 7+89.06	
Baughman Company, P.A. 315 Ellis St. Wichita, KS 67211 P 316-262-7271 F 316-262-0149 ENGINEERING SURVEYING PLANNING LANDSCAPE ARCHITECTURE			
PROJECT NUMBER 472-84069	DESIGN JAK	DRAWN JAK	DATE 3/11/14
REVISIONS:	APPROVED AEG	NOTED AEG	SHEET 6 OF 24