

PLOT DATE: Monday, March 17, 2014 @ 01:35PM

CURVE TABLE - C8					
$\Delta = 17'34.40"$ R = 350.00' T = 54.11' L = 107.38' LC = 106.96'					
CURVE DATA BASED ON CENTERLINE $\Delta/2 = 08'47.20"$					
STATION	ARC	8'Off LtCb	8'Off RtCb	DEFLECTION	TOTAL DEFLECTION
30+32.59	-	-	-	00'00'00"	00'00'00"
30+50.00	17.41'	16.31'	18.50'	01'25'30"	01'25'30"
30+75.00	25.00'	23.42'	26.57'	02'02'47"	03'28'17"
31+00.00	25.00'	23.42'	26.57'	02'02'47"	05'31'03"
31+14.50	14.50'	13.59'	15.41'	01'11'13"	06'42'16"
31+25.00	10.50'	9.84'	11.16'	00'51'34"	07'33'50"
31+39.97	14.97'	14.03'	15.91'	01'13'30"	08'47'20"
Def/Ft = 4.91107 Min.					

CURVE TABLE - C9					
$\Delta = 35'04.42"$ R = 200.00' T = 63.21' L = 122.45' LC = 120.54'					
CURVE DATA BASED ON CENTERLINE $\Delta/2 = 17'32.21"$					
STATION	ARC	8'Off LtCb	8'Off RtCb	DEFLECTION	TOTAL DEFLECTION
31+39.97	-	-	-	00'00'00"	00'00'00"
31+50.00	10.03'	11.13'	8.93'	01'26'12"	01'26'12"
31+52.00	2.00'	2.22'	1.78'	00'17'11"	01'43'23"
31+53.21	1.21'	1.34'	1.08'	00'10'24"	01'53'47"
31+75.00	21.79'	24.17'	19.38'	03'07'16"	05'01'04"
31+77.14	2.14'	2.38'	1.90'	00'18'24"	05'19'27"
31+89.50	12.36'	13.72'	11.00'	01'46'14"	07'05'41"
32+00.00	10.50'	11.65'	9.34'	01'30'14"	08'35'55"
32+08.29	8.29'	9.20'	7.38'	01'11'15"	09'47'10"
32+25.00	16.71'	18.54'	14.87'	02'23'37"	12'10'47"
32+36.06	11.06'	12.28'	9.84'	01'35'03"	13'45'50"
32+50.00	13.94'	15.47'	12.40'	01'59'48"	15'45'38"
32+62.42	12.42'	13.78'	11.05'	01'46'43"	17'32'21"
Def/Ft = 8.59437 Min.					

CURVE TABLE - C10					
$\Delta = 22'06.14"$ R = 300.00' T = 58.60' L = 115.74' LC = 115.02'					
CURVE DATA BASED ON CENTERLINE $\Delta/2 = 11'03'07"$					
STATION	ARC	8'Off LtCb	8'Off RtCb	DEFLECTION	TOTAL DEFLECTION
33+24.23	-	-	-	00'00'00"	00'00'00"
33+50.00	25.77'	23.87'	27.65'	02'27'39"	02'27'39"
33+75.00	25.00'	23.16'	26.83'	02'23'14"	04'50'53"
33+83.00	8.00'	7.41'	8.59'	00'45'50"	05'36'44"
33+87.78	4.78'	4.43'	5.13'	00'27'23"	06'04'07"
34+00.00	12.22'	11.32'	13.12'	01'10'01"	07'14'08"
34+12.50	12.50'	11.58'	13.42'	01'11'37"	08'25'45"
34+25.00	12.50'	11.58'	13.42'	01'11'37"	09'37'22"
34+39.97	14.97'	13.87'	16.06'	01'25'45"	11'03'07"
Def/Ft = 5.72958 Min.					

CURVE TABLE - C11					
$\Delta = 18'23.31"$ R = 163.29' T = 26.44' L = 52.42' LC = 52.19'					
CURVE DATA BASED ON CENTERLINE $\Delta/2 = 09'11'46"$					
STATION	ARC	8'Off LtCb	8'Off RtCb	DEFLECTION	TOTAL DEFLECTION
34+77.52	-	-	-	00'00'00"	00'00'00"
34+98.26	20.74'	23.52'	17.93'	03'38'19"	03'38'19"
35+00.00	1.74'	1.97'	1.51'	00'18'19"	03'56'38"
35+25.00	25.00'	28.34'	21.61'	04'23'10"	08'19'48"
35+27.47	2.47'	2.80'	2.14'	00'26'00"	08'45'48"
35+29.94	2.47'	2.80'	2.14'	00'25'58"	09'11'46"
Def/Ft = 10.52651 Min.					

LEGEND
 ▨ - 10' CURB TRANSITION (SEE NOTE 3)
 + * - STREET SIGN (SEE NOTE 4)

NOTES

- TOP OF CURB ELEVATIONS SHOWN ARE FOR FULL CURB. CONSTRUCT CURB AND GUTTER AS NOTED.
- SIDEWALKS TO BE CONSTRUCTED AT 5' WIDTH EXCEPT AT THOSE LOCATIONS ACROSS ENDS OF PARKING WHERE THEY SHALL BE 6' WIDTH.
- CONSTRUCT CURB AND GUTTER, FULL (6 5/8") WITH 10' TRANSITION TO ROLL CURB (3 5/8").
- SEE SIGN ASSEMBLY TABLE ON SHEET 08 FOR SIGN TYPE AND LOCATION.

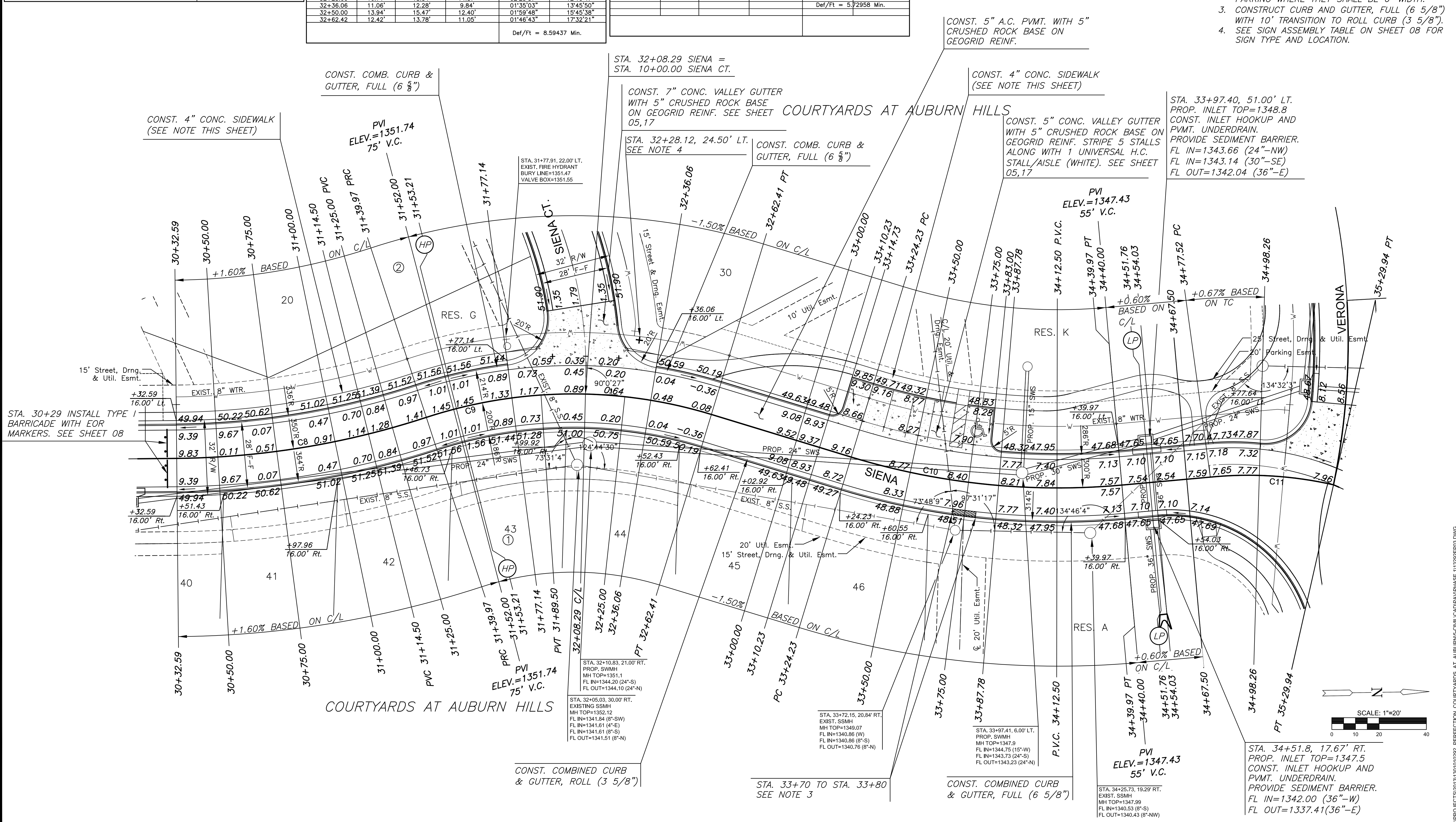

PAVING & INCIDENTAL DRAINAGE FOR
COURTYARDS AT AUBURN HILLS
 PHASE 1

©2013 MKEC Engineering
 All Rights Reserved
 www.mkec.com
 These drawings and their contents, including, but not limited to, all concepts, designs, & ideas are the exclusive property of MKEC Engineering (MKEC), and may not be used or reproduced in any way without the express consent of MKEC.

SIENA PAVING PLAN 30+32.59 TO 35+29.94	
PROJECT NO.	472-85128
DATE	MAR. 2014
SCALE	1"=20'
DESIGNED	DRAWN
SPE	WNJ
CHECKED	JTC
#	###/###
NO.	REVISION
SHEET NO.	
13 OF 52	