

FHWA NO./REGION	STATE	PROJECT NO.	FISCAL YEAR	SHEET NO.	TOTAL SHEETS
7	KANSAS	87N-0548-01	2014	1	61

HSIP-N054(801)

Index

1	Title Sheet	
2	Keysheet	
3	General Notes	
4	Typical Sections	
5	Wheelchair Ramp & Pavement Details	
6	Drive Detail	
7	Bus Stop Pad Detail	
8	Joint Dowel Detail	
9-10	Mt Vernon Paving Plans	
11-12	Oliver Paving Plans	GRADING
13	V.G. Details	SURFACING
14	Intersection Joint Plan	STORM SEWER
15	Intersection Grading Plan	SEEDNG
16-17	Mt. Vernon Joint Plan	TRAFFIC SIGNALS
18-19	Oliver Joint Plan	
20-21	Mt. Vernon Marking Signing	
22-23	Oliver Marking Signing	
24	Sign Details	
25-26	Signalization Details	
27	Signalization Plan	
28	Wiring Plan	
29	Summary of Quantities	
30	Recap of Quantities	
31-36	Construction Sequence	
37-39	Traffic Control Details	
40	Erosion Control Plan	
41	Sodding Plan	
42-43	Erosion Control BMP's	
44-51	Mt Vernon Cross Sections	
52-61	Oliver Cross Sections	

STATE OF KANSAS
DEPARTMENT OF TRANSPORTATION
CONSTRUCTION PLANS FOR PROPOSED
Mt VERNON & OLIVER INTERSECTION
FEDERAL AID URBAN SYSTEM PROJECT
FOR
THE CITY OF WICHITA,
SEDGWICK COUNTY, KANSAS
Gary Janzen, P.E., City Engineer
March, 2014
FINAL PLANS

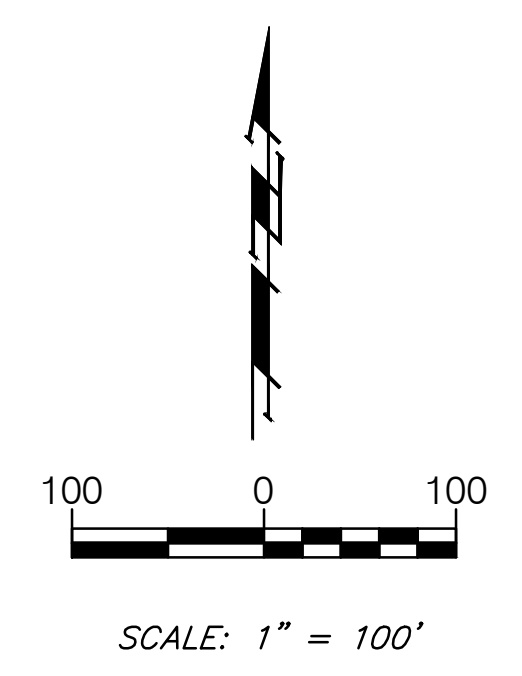
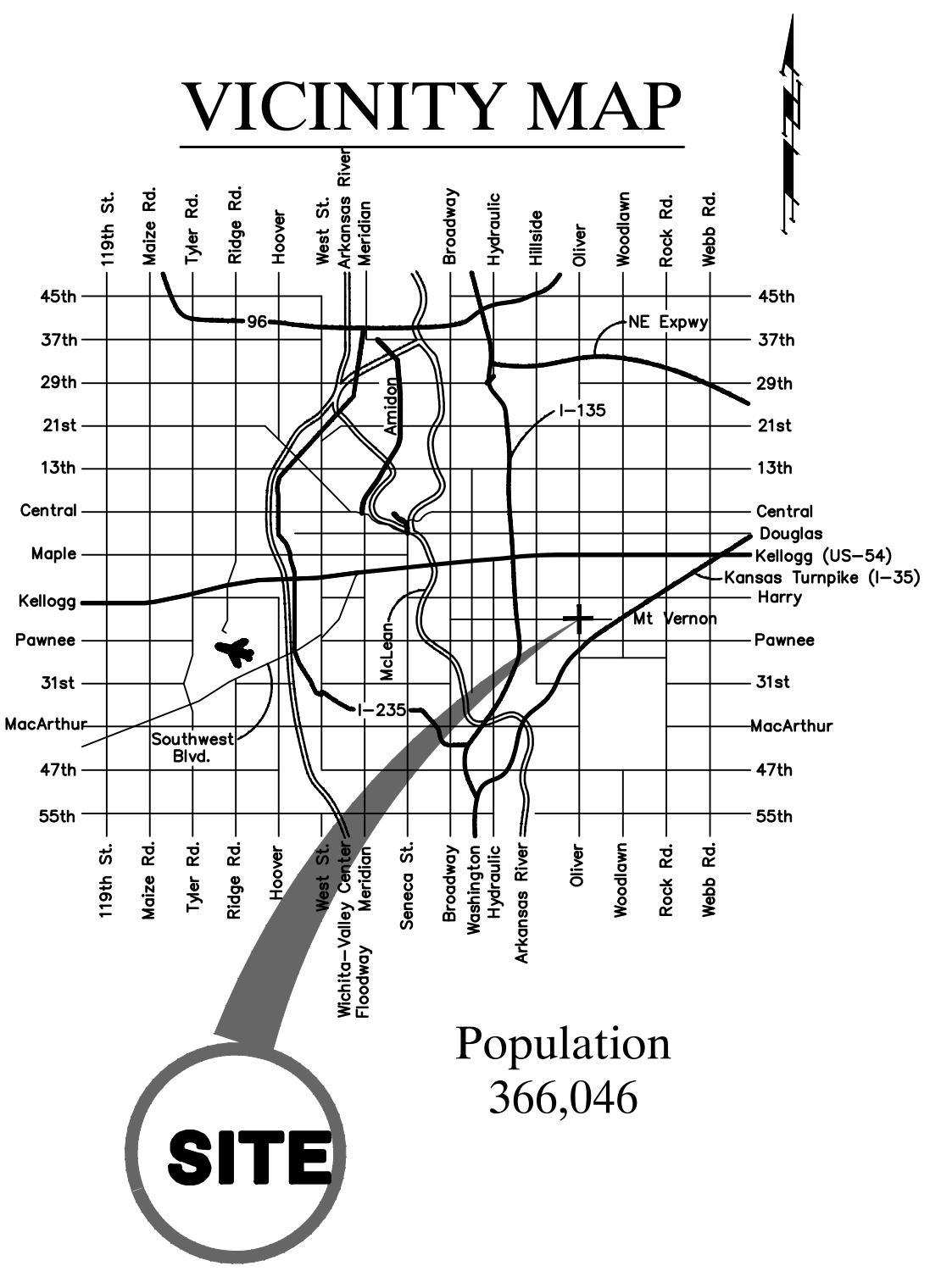

Paving Project
City Project No. 472-85042
O.C.A. No. 707037

Water Project
City Project No. 448-90628
O.C.A. No. 636302

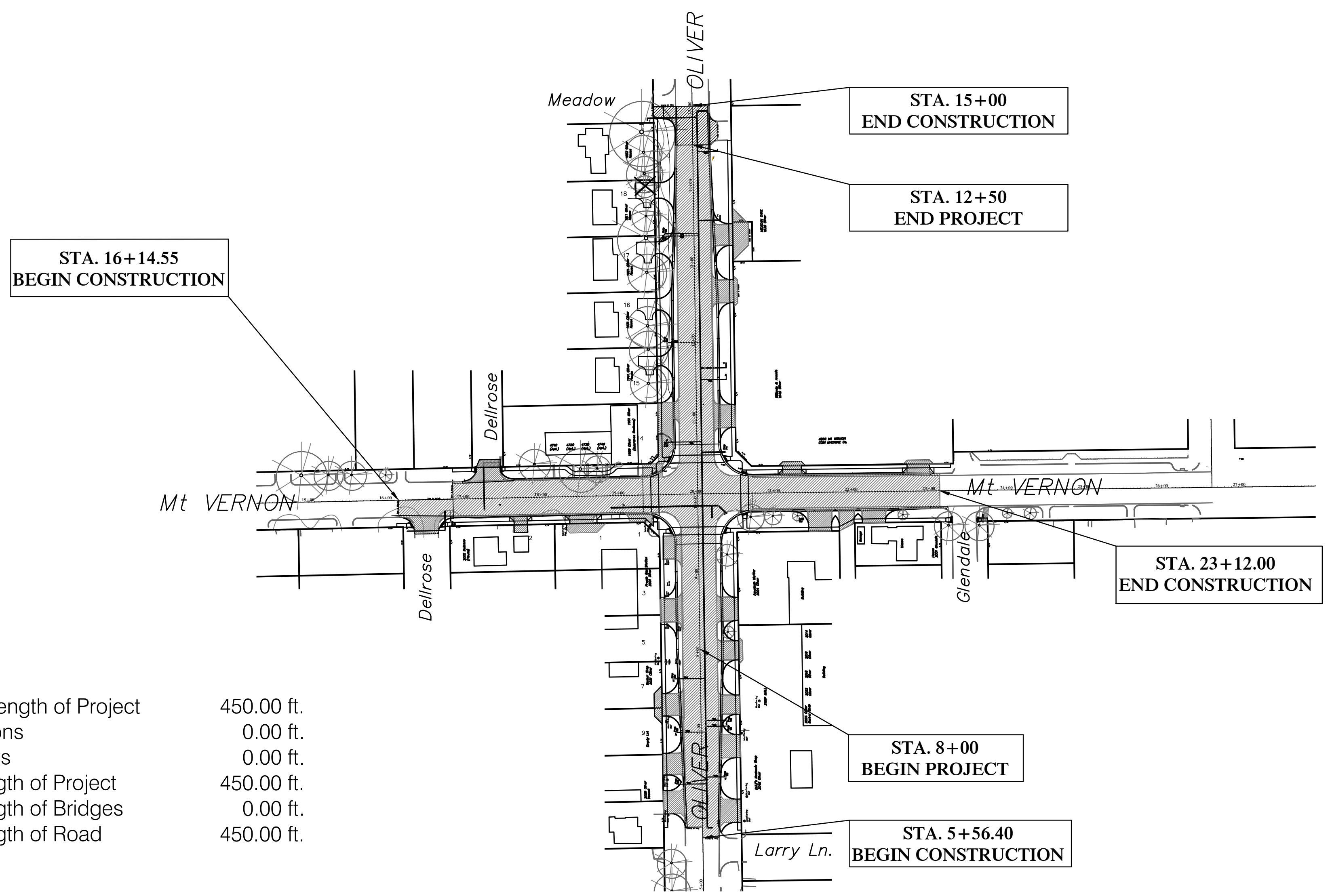

DESIGN DATA

AADT (2006)	17,480
AADT (2030)	20,042
DHV	8%
T	3%
V	35 mph
C of A	N/A
Clear Zone	6'

Gross Length of Project	450.00 ft.
Exceptions	0.00 ft.
Additions	0.00 ft.
Net Length of Project	450.00 ft.
Net Length of Bridges	0.00 ft.
Net Length of Road	450.00 ft.

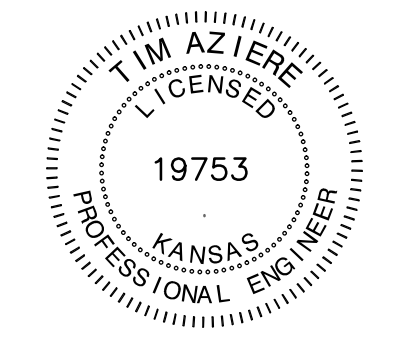

APPROVED -- DATE

GARY JANZEN, P.E., CITY ENGINEER
CITY OF WICHITA, KANSAS