

PRINTS ISSUED		
DATE	PURPOSE	NO.
04.29.13	FIELD CHECK	
05.31.13	OFFICE CHECK	
12.23.13	FOR CONSTRUCTION	

DOUGLAS AVE. BUS
FACILITY IMPROVEMENTS
(472-85080)
WICHITA, KS

LawKington Architecture
Engineering · Planning · Interiors · Landscapes

LawKington Architecture
345 RIVERVIEW WICHITA, KS 67203
Phone (316) 268-0230 Fax: (316) 268-0205

CONTACT: Jeffrey A. Best, ASLA
PROJECT NUMBER:
12856
SHEET TITLE:
**INTERSECTION DETAIL
DOUGLAS & TOPEKA**

SHEET NUMBER:
C11

PEC PROFESSIONAL ENGINEERING CONSULTANTS, P.A.
303 SOUTH TOPEKA WICHITA, KS 67202
316-262-2691 www.pec1.com

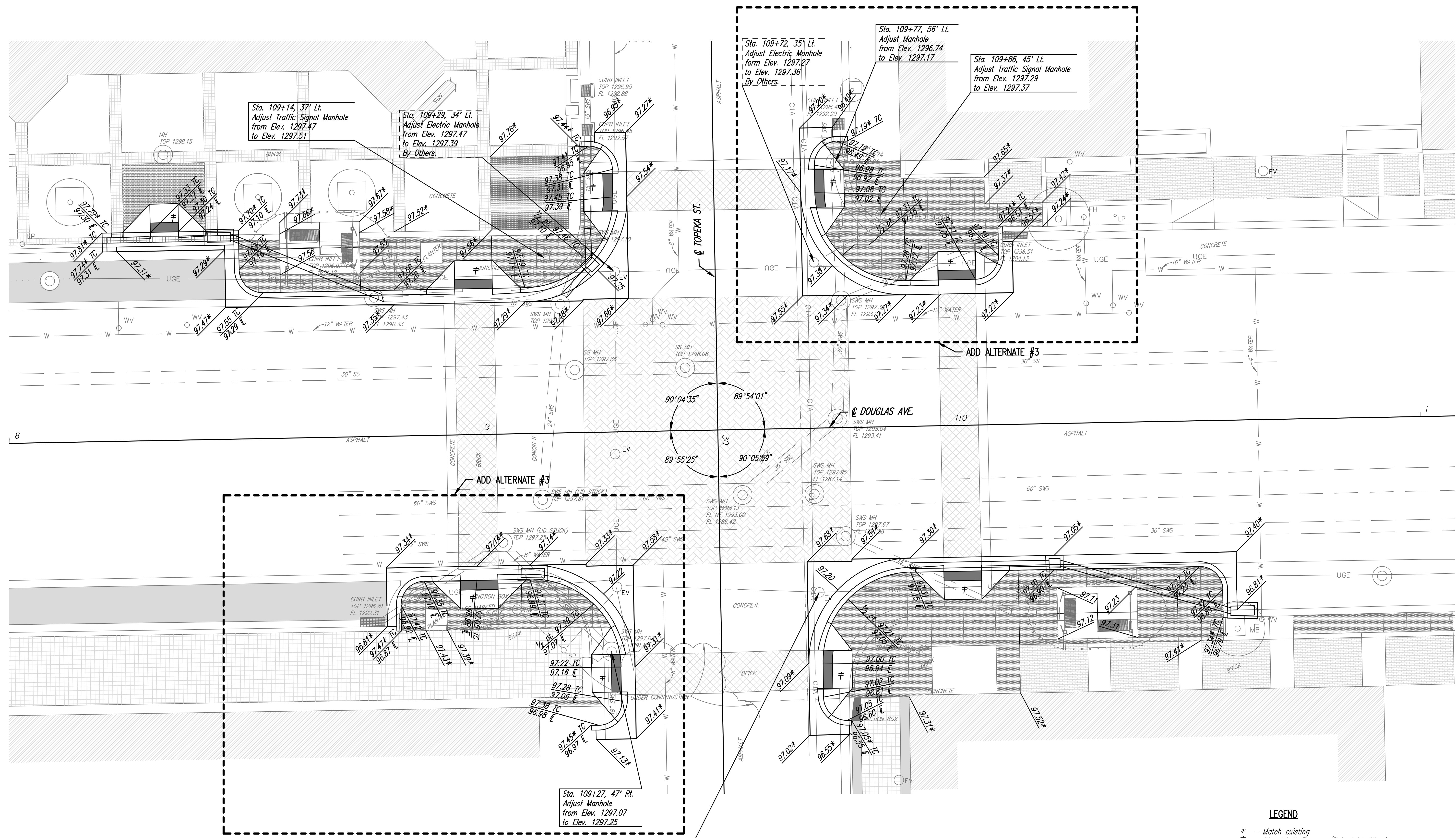

CIVIL PLAN
1"=10'-0"
NORTH

Note:
Sidewalk Maximum Allowable Cross-Slope = 2.0%

REMOVAL OF EXISTING STRUCTURES **		
STATION	SIDE	ITEM
108+69.74	Lt.	Curb Inlet and 11 L.F. 18" RCP (SE)
108+77.98	Lt.	Manhole
109+23.67	Lt.	Manhole
110+15.06	Rt.	Curb Inlet and 24 L.F. 15" RCP (NW)
110+16.61	Rt.	Sign

**For Information only.

Saved 10-19-2013 2:05:17 PM by CP
 Plot Scale: 1"=10'-0" 12-19-2013 2:05:42 PM by CP
 I:\2012\12738\FINAL PLANS\12856-SA - C11-13