

PRINTS ISSUED		
DATE	PURPOSE	NO.
04.29.13	FIELD CHECK	
05.31.13	OFFICE CHECK	
12.23.13	FOR CONSTRUCTION	

DOUGLAS AVE. BUS
FACILITY IMPROVEMENTS
(472-85080)
WICHITA, KS

LawKingdon Architecture
Engineering · Planning · Interiors · Landscapes

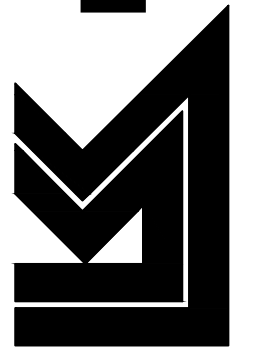

LawKingdon Architecture
345 RIVERVIEW WICHITA, KS 67203
Phone (316) 268-0230 Fax: (316) 268-0205

CONTACT: Jeffery A. Best, AIA
PROJECT NUMBER:

12856

SHEET TITLE:
**INTERSECTION DETAIL
DOUGLAS & ST.**

FRANCIS
SHEET NUMBER:

C12

Sta. 116+06, 48' Lt.
Install 1" Service Line
and Meter per City Standards.
Reconnect Exist. Service
(Routing as Approved by the Engineer.)

Sta. 116+80, 58' Lt.
Adjust Fire Hydrant
from Elev. 1299.38
to Elev. 1299.54

Sta. 116+91, 59' Lt.
Adjust Water Valve
from Elev. 1299.33
to Elev. 1299.51

Sta. 117+27, 38' Lt.
Adjust Electric Manhole
from Elev. 1299.60
to Elev. 1299.59
By Others.

Sta. 116+88, 35' Lt.
Adjust Electric Manhole
from Elev. 1299.36
to Elev. 1299.38
By Others.

Sta. 116+97, 29' Lt.
Adjust Water Valve
from Elev. 1299.65
to Elev. 1299.57

Sta. 117+37, 41' Lt.
Adjust Manhole
from Elev. 1299.22
to Elev. 1299.60

Sta. 117+47, 44' Lt.
Adjust Traffic Signal Manhole
from Elev. 1299.35
to Elev. 1299.43

Abandon Exist.
Service Line and Meter
per City Standards

Bench Mark 354: Chiseled square on the top of curb on the north side of Douglas, 150.5'± west of centerline of St. Francis, in front of building #518
Elevation = 1298.96 (NAVD88)

Bench Mark 355: Chiseled square on the top of curb on the north side of Douglas, 180'± east of centerline of St. Francis, in front of building #612
Elevation = 1299.85 (NAVD88)

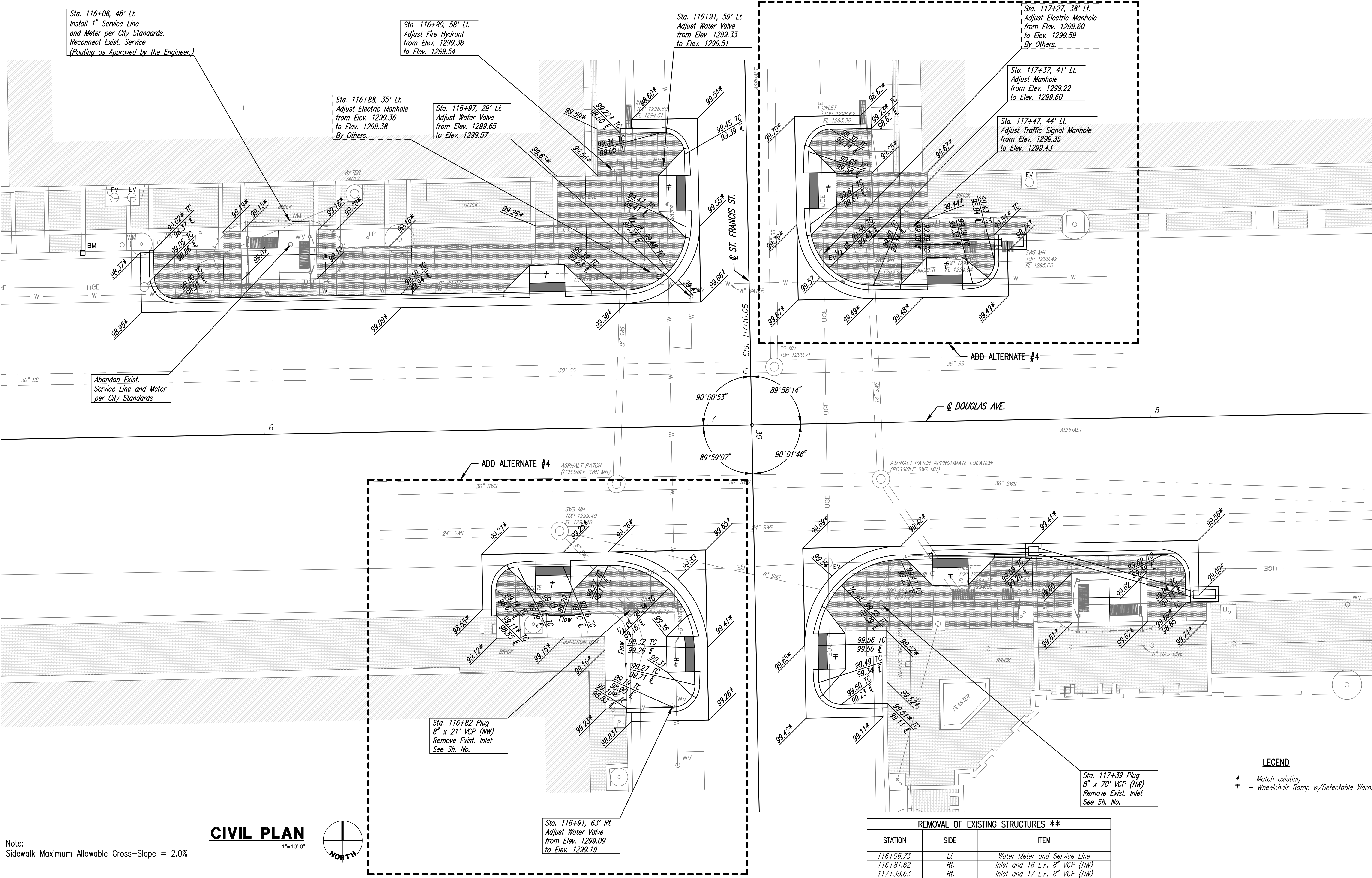

Note:
Sidewalk Maximum Allowable Cross-Slope = 2.0%

CIVIL PLAN
1"=10'-0"
NORTH

REMOVAL OF EXISTING STRUCTURES **		
STATION	SIDE	ITEM
116+06.73	Lt.	Water Meter and Service Line
116+81.82	Rt.	Inlet and 16 L.F. 8" VCP (NW)
117+38.63	Rt.	Inlet and 17 L.F. 8" VCP (NW)
117+57.13	Rt.	Curb Inlet and 12 L.F. 18" RCP (NW)
117+67.20	Rt.	Curb Inlet and 15" RCP (W)
117+60.19	Lt.	Curb Inlet and 20 L.F. 15" RCP (W)
117+68.54	Lt.	Curb Inlet and 6 L.F. 15" RCP (W)

**For Information only.

LEGEND
* - Match existing
- Wheelchair Ramp w/Detectable Warning

Served 12-19-2013 2:08:17 PM by CP
 Plot Scale: 1"=10'-0" 12-19-2013 2:35:48 PM by CP
 I:\2012\12738\FINAL PLANS\12856-SA - 4-17-13