

PRINTS ISSUED		
DATE	PURPOSE	NO.
04.29.13	FIELD CHECK	
05.31.13	OFFICE CHECK	
12.23.13	FOR CONSTRUCTION	

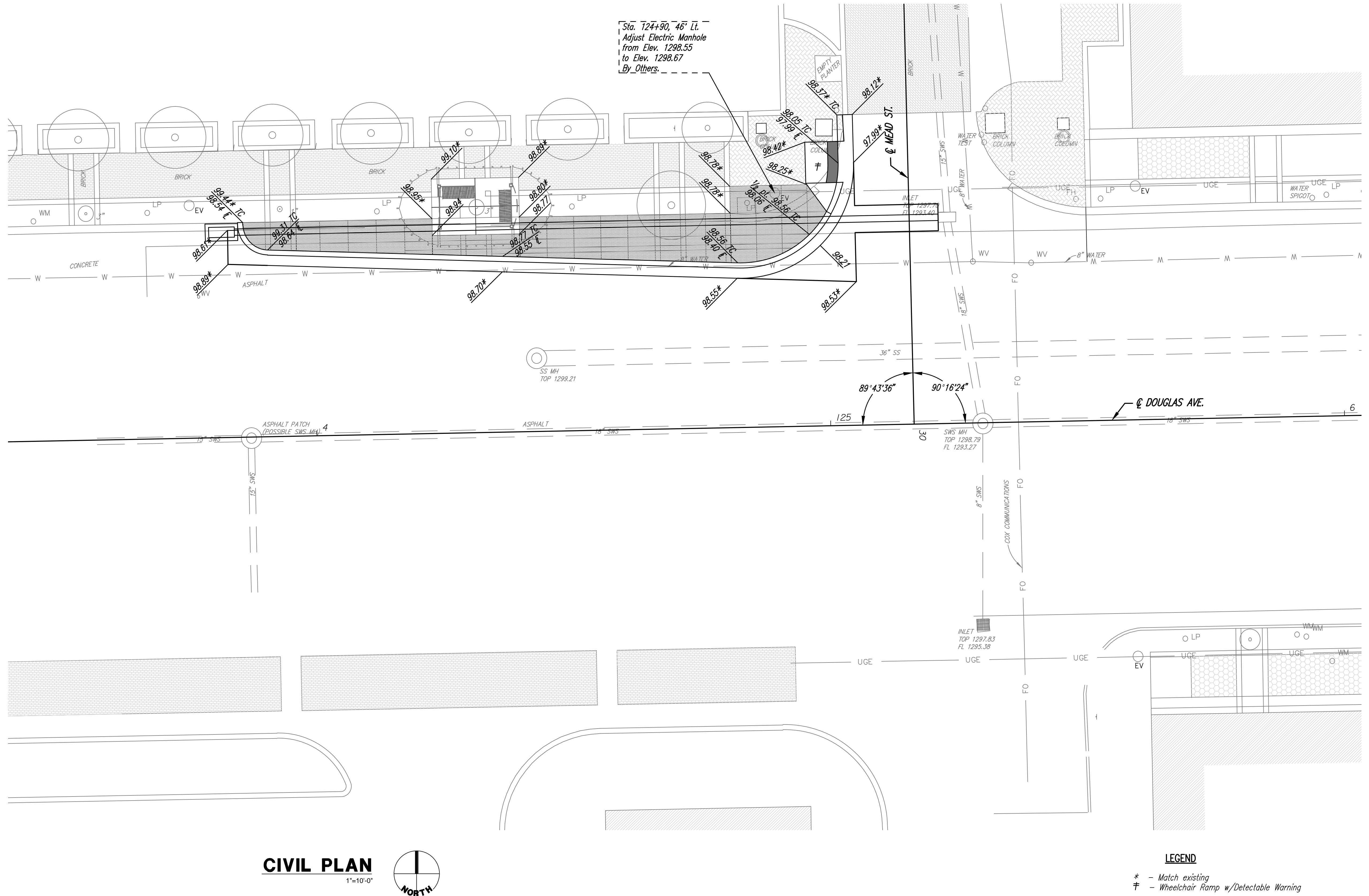

CIVIL PLAN
1"=10'-0"
NORTH

Note:
Sidewalk Maximum Allowable Cross-Slope = 2.0%

Bench Mark 356: Chiseled square on the top of curb at the west curb return at the northwest corner of drive entrance on the south side of Douglas, 129'± east of east face of railroad bridge over Douglas
Elevation = 1299.21 (NAVD88)

Bench Mark 357: Chiseled square on the top of curb on the north side of Douglas, 92.5'± west of centerline of rock island, in front of west entrance to building #804
Elevation = 1298.16 (NAVD88)

PEC PROFESSIONAL ENGINEERING CONSULTANTS, P.A.
303 SOUTH TOPEKA WICHITA, KS 67202
316-262-2691 www.pec1.com

DOUGLAS AVE. BUS
FACILITY IMPROVEMENTS
(472-85080)
WICHITA, KS

LawKingdon Architecture
Engineering • Planning • Interiors • Landscapes



LawKingdon Architecture
345 RIVERVIEW WICHITA, KS 67203
Phone (316) 268-0230 Fax: (316) 268-0205

CONTACT: Jeffrey A. Best, ASLA

PROJECT NUMBER:

12856

SHEET TITLE:
**INTERSECTION DETAIL
DOUGLAS & MEAD**

SHEET NUMBER:

C13

Sheet 10-19-2013 2:08:17 PM by CP
Plot Scale: 1"=10'-0" 12:49:2013 2:45:52 PM by CP
E:\2012\12738\FINAL PLANS\12856-SA-A-17-13