

# A AMENITIES PLAN

1"=50'-0"

**NOTE:**

- THIS PLAN REPRESENTS AMENITIES TO BE INSTALLED BY CONTRACTOR ALONG DOUGLAS AVE. THIS PLAN DOES NOT INCLUDE BENCHES TO BE INSTALLED WITHIN BUS SHELTER - NICS, OR THOSE TO BE LOCATED ON ST FRANCIS.
- FOR MORE DETAILS ABOUT SITE AMENITIES REFERENCE SHEETS GNS & SA.
- MID BLOCK BIKE RACKS - LOCATE 30IN ON CENTER FROM BOC & CENTER BETWEEN EXISTING STREET AMENITIES. VERIFY LOCATION W/ PROJECT ENGINEER & LANDSCAPE ARCHITECT.

**NOTE:**

- CONTACT PROJECT ENGINEER FOR FINAL FIELD LOCATION FOR ALL AMENITIES PRIOR TO INSTALLATION

**NOTE: ADD ALTERNATE # 5**  
16 BACKLESS BENCHES TO BE CHANGED WITH BACKED BENCHES ON ST FRANCIS ST. BETWEEN 2ND & 1ST ST. COORDINATE BENCH CHANGES WITH PROJECT ENGINEER.

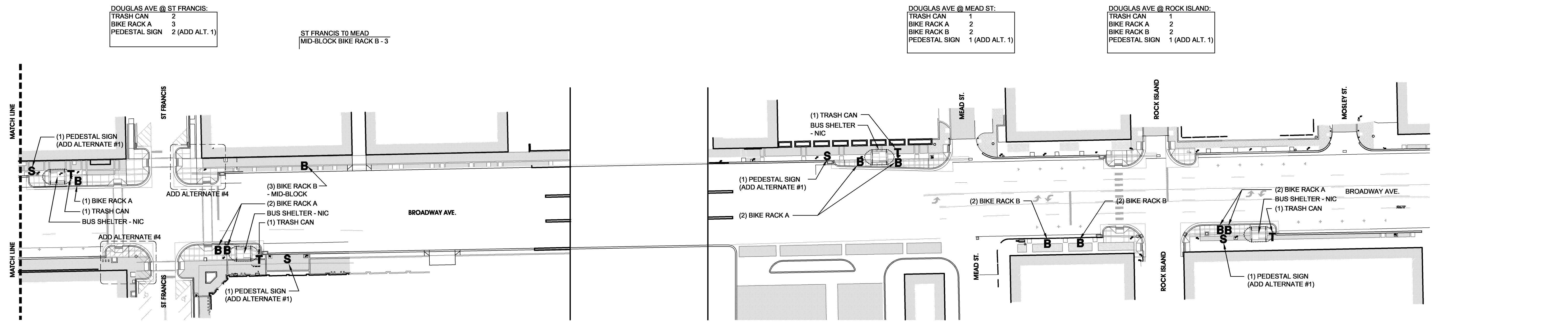

# B AMENITIES PLAN

1"=50'-0"

**NOTE:**

- THIS PLAN REPRESENTS AMENITIES TO BE INSTALLED BY CONTRACTOR ALONG DOUGLAS AVE. THIS PLAN DOES NOT INCLUDE BENCHES TO BE INSTALLED WITHIN BUS SHELTER - NICS, OR THOSE TO BE LOCATED ON ST FRANCIS.
- FOR MORE DETAILS ABOUT SITE AMENITIES REFERENCE SHEETS GNS & SA.
- MID BLOCK BIKE RACKS - LOCATE 30IN ON CENTER FROM BOC & CENTER BETWEEN EXISTING STREET AMENITIES. VERIFY LOCATION W/ PROJECT ENGINEER & LANDSCAPE ARCHITECT.

**NOTE:**

- CONTACT PROJECT ENGINEER FOR FINAL FIELD LOCATION FOR ALL AMENITIES PRIOR TO INSTALLATION

**DOUGLAS AVE. BUS FACILITY IMPROVEMENTS**  
(472-85080)  
WICHITA, KS

**LawKington Architecture**  
Engineering · Planning · Interiors · Landscapes

LawKington Inc. ©  
345 RIVERVIEW, WICHITA, KS 67203  
Phone (316) 268-0230 Fax: (316) 268-0200

CONTACT: Jeffrey A. Best, ASLA  
PROJECT NUMBER:

**12856**

SHEET TITLE:  
**AMENITIES PLAN**

SHEET NUMBER:  
**SA2.1**