

PRINTS ISSUED

DATE	PURPOSE	NO.
04.29.13	FIELD CHECK	
05.31.13	OFFICE CHECK	
12.23.13	FOR CONSTRUCTION	

DOUGLAS AVE. BUS
FACILITY IMPROVEMENTS
(472-85080)
WICHITA, KS

LawKingdon Architecture
Engineering · Planning · Interiors · Landscapes

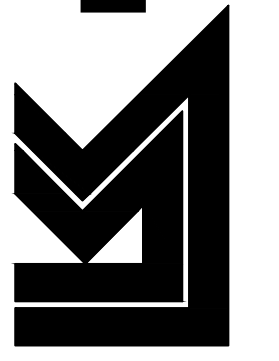

LawKingdon Architecture
345 RIVERVIEW WICHITA, KS 67203
Phone (316) 268-0230 Fax: (316) 268-0205

CONTACT: Jeffery A. Best, ASLA

PROJECT NUMBER:

12856

SHEET TITLE:

**COORDINATE
GEOMETRY**

SHEET NUMBER:

C5

PEC PROFESSIONAL ENGINEERING CONSULTANTS, P.A.
303 SOUTH TOPEKA WICHITA, KS 67202
316-262-2691 www.pec1.com

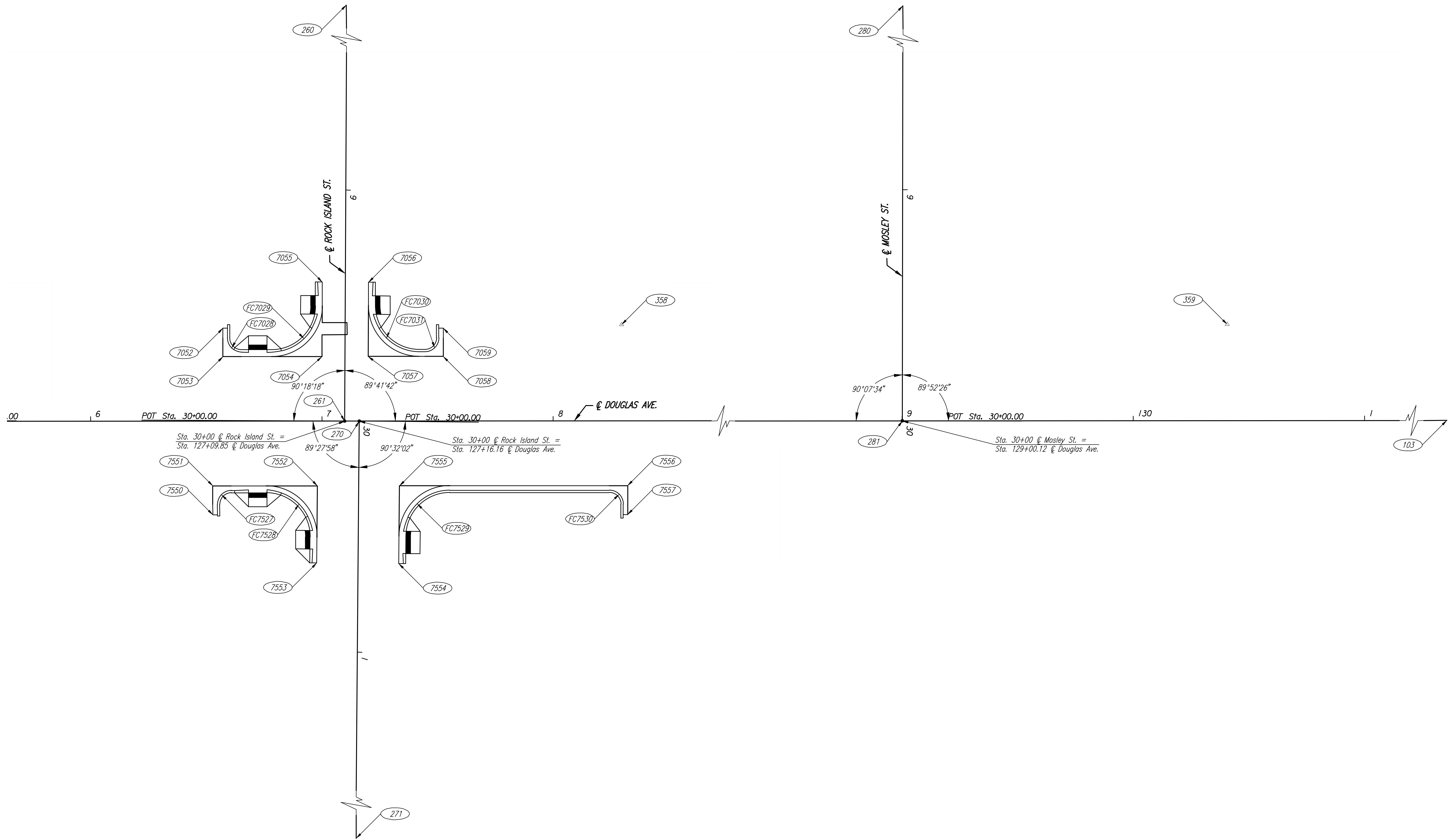

Saved 10-10-2013 2:57:45 PM by CP
 Plot Scale: 1" = 12'-0" 10/13 3:01:54 PM
 I:\2012\12738\FINAL PLANS\PEC PROPOSED GEOMETRY LAYOUT