

# GENERAL NOTES

- Existing utilities, both above and below ground, and their locations as shown on the plans, represent the best information available for design. The locations of utilities as shown on the plans are not guaranteed and the Contractor shall verify all utilities and their locations before beginning construction. Additional utilities, including relocated utilities, which are not shown on the plans may be encountered. In this event, the Contractor shall adjust his schedule and cooperate with the utility companies to ensure that their facilities be adjusted as required to clear construction. The Contractor shall exercise extreme caution while working near utilities.
- The Contractor shall not start work on the project until the Project Inspector assigned to the project is present. Any work done without inspection will be required to be uncovered for inspection.
- Sewage Flow Shall be Uninterrupted Around Work Zones. Bypass Pumping shall be paid at the Lump Sum Bid Price for "Bypass Pumping". Engineer shall approve any Bypass Pumping Plan before Pumping Operations begin.
- All pipe trench under new pavement shall be back filled with sand, which shall be flushed with water and vibrated. To be paid as the Bid Item "Fill, Sand (Flushed and Vibrated)".
- All pipe trench in pavement or driveways which will be required to carry traffic until permanent replacement shall be topped with 6" thick temporary asphalt to be paid as a Measured Quantity Bid Item (SY).
- All New Manholes Constructed with this Project shall be lined with one of the following liner systems: Raven 405, Sauereisen 2105, Warren Environmental 5301, or Zebtron per City of Wichita Specifications. Cost to be INCIDENTAL to the Installation of the Manhole.

# PAWNEE and BROADWAY SANITARY SEWER RECONSTRUCTION

## Index

	Sanitary Sewer Plans
1	Title Sheet
2 - 3	Plan / Profile

## Along PAWNEE Across BROADWAY

Project Number  
468-84784

O.C.A. Number  
620574

Cornejo/Wildcat - Contractors  
J. Terhune - City of Wichita, Field Project Engineer  
L. Wilson - City of Wichita, Inspector  
As-built  
Release Date: 06/01/2013  
pdf: APRosas 06/18/2014

CITY OF WICHITA, KANSAS  
James L. Armour, P.E. City Engineer  
JUNE, 2011  
FINAL PLANS

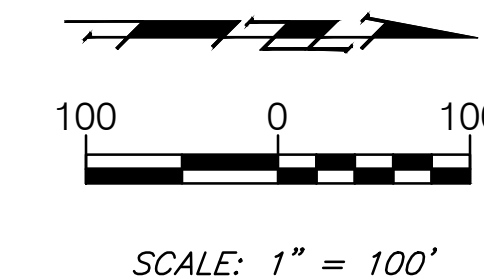

### VICINITY MAP

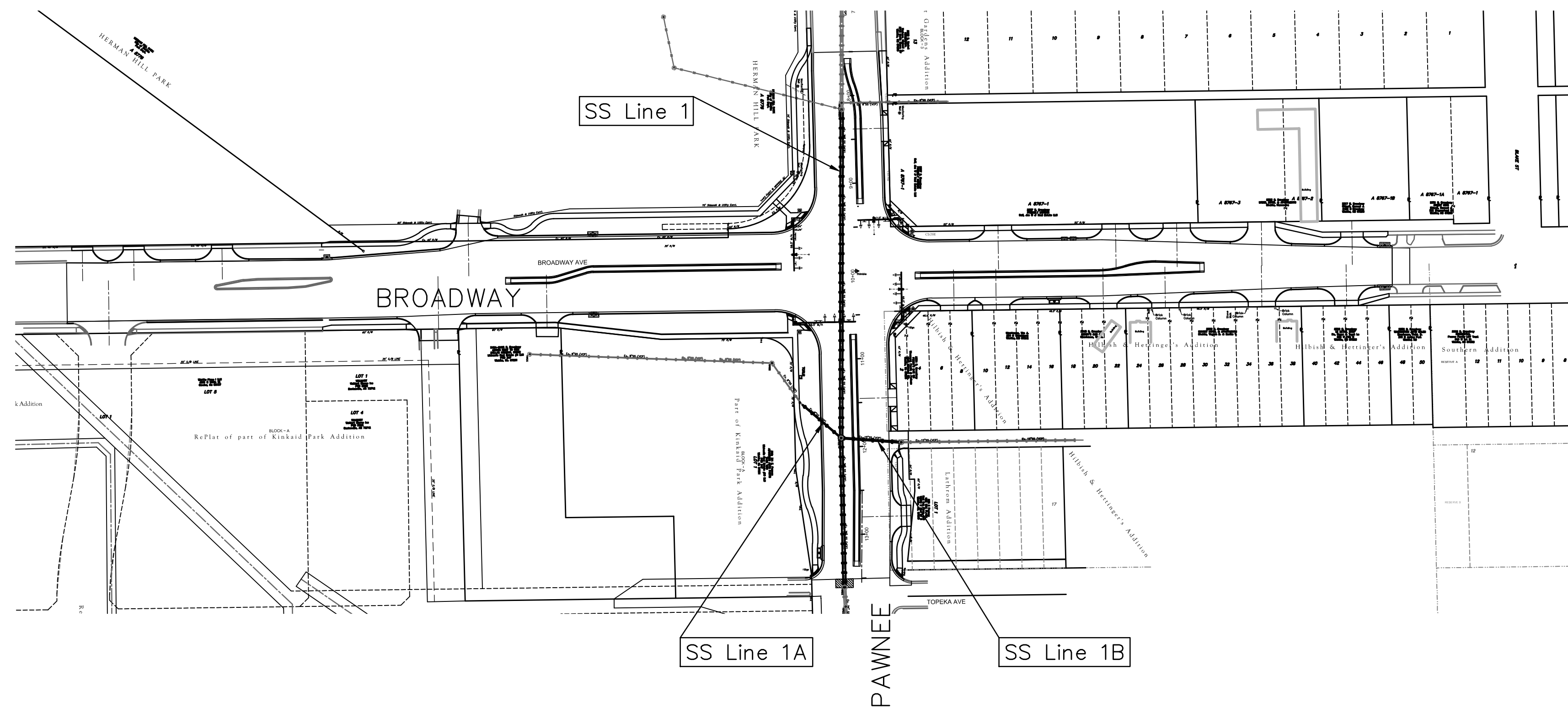
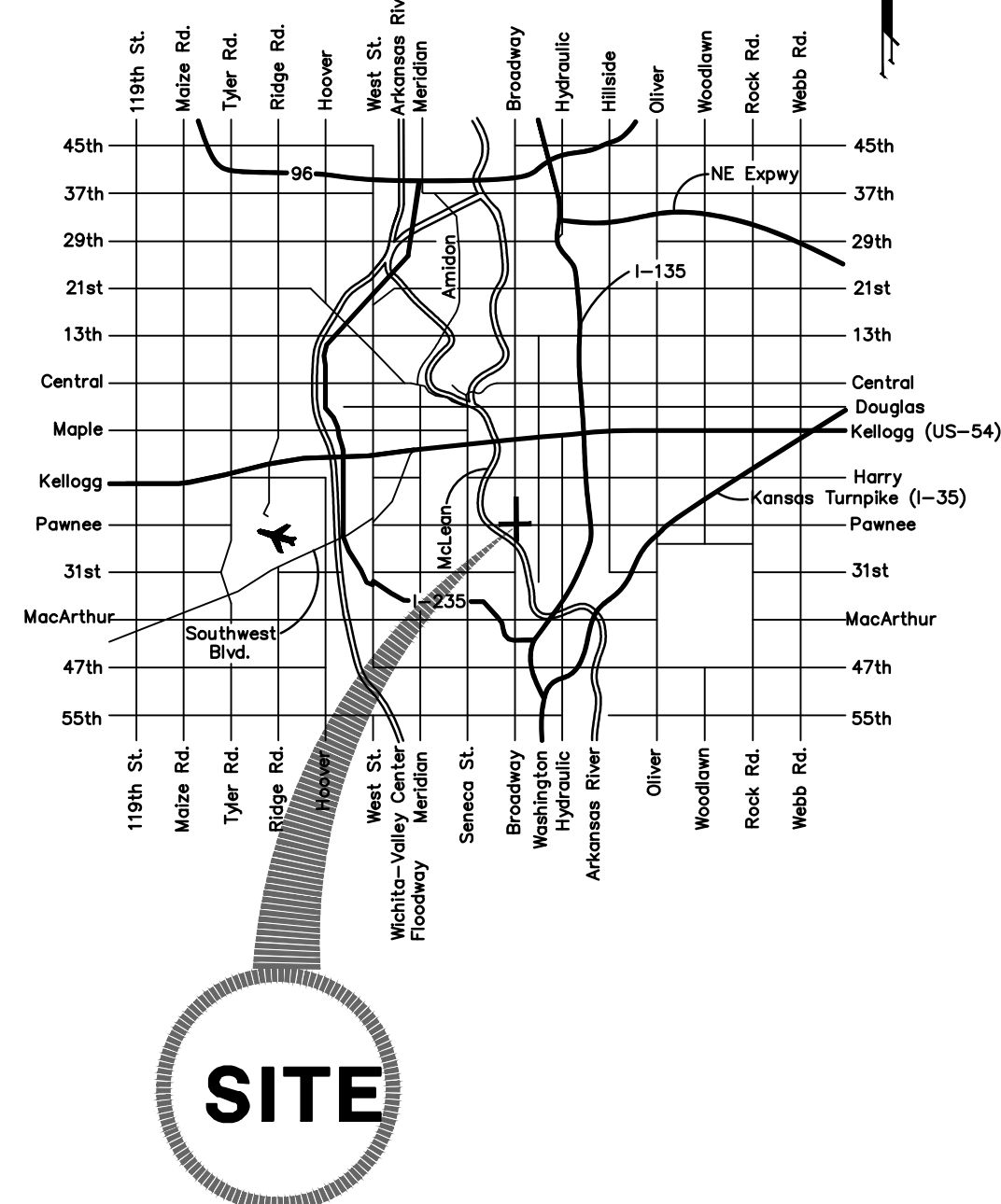

Project Location