

Sta. 65+00.0 SWS Line No. 1A=
 Sta. 60+00.0 SWS Line No. 1=
 Sta. 70+00.0 SWS Line No. 1B=
 Sta. 13+19.00 @ Parkdale, 17.67' Rt.
 Reinf. Conc. Manhole

Sta. 66+22.0 SWS Line No. 1A=
 Sta. 11+97.00 @ Parkdale, 17.67' Rt.
 Const. Std. Type 1A Curb Inlet
 L=5'-0", W=3'-0"
 Top Elev.=173.49
 Install 35.3 L.F. 15" RCP (W)
 See Sheet No. 10.

Prop. SS MH
 Top Elev.=175.50
 In=164.31 (W)
 Out=164.31 (E)

CAUTION!!!
 Prop. 8" San. Sewer
 (City of Wichita)

Install 31 L.F.
 Excavatable Flowable
 Fill to Elev. 172.4

Sta. 66+57.3 SWS Line No. 1A=
 Sta. 11+97.00 @ Parkdale, 17.67' Lt.
 Const. Std. Type 1A Curb Inlet
 L=5'-0", W=3'-0"
 Top Elev.=173.49
 See Sheet No. 10.



SWS COORDINATES		
POINT NO.	N	E
156	9276.8346	3112.0108
159	9154.8354	3111.5587
160	9154.9664	3076.2189

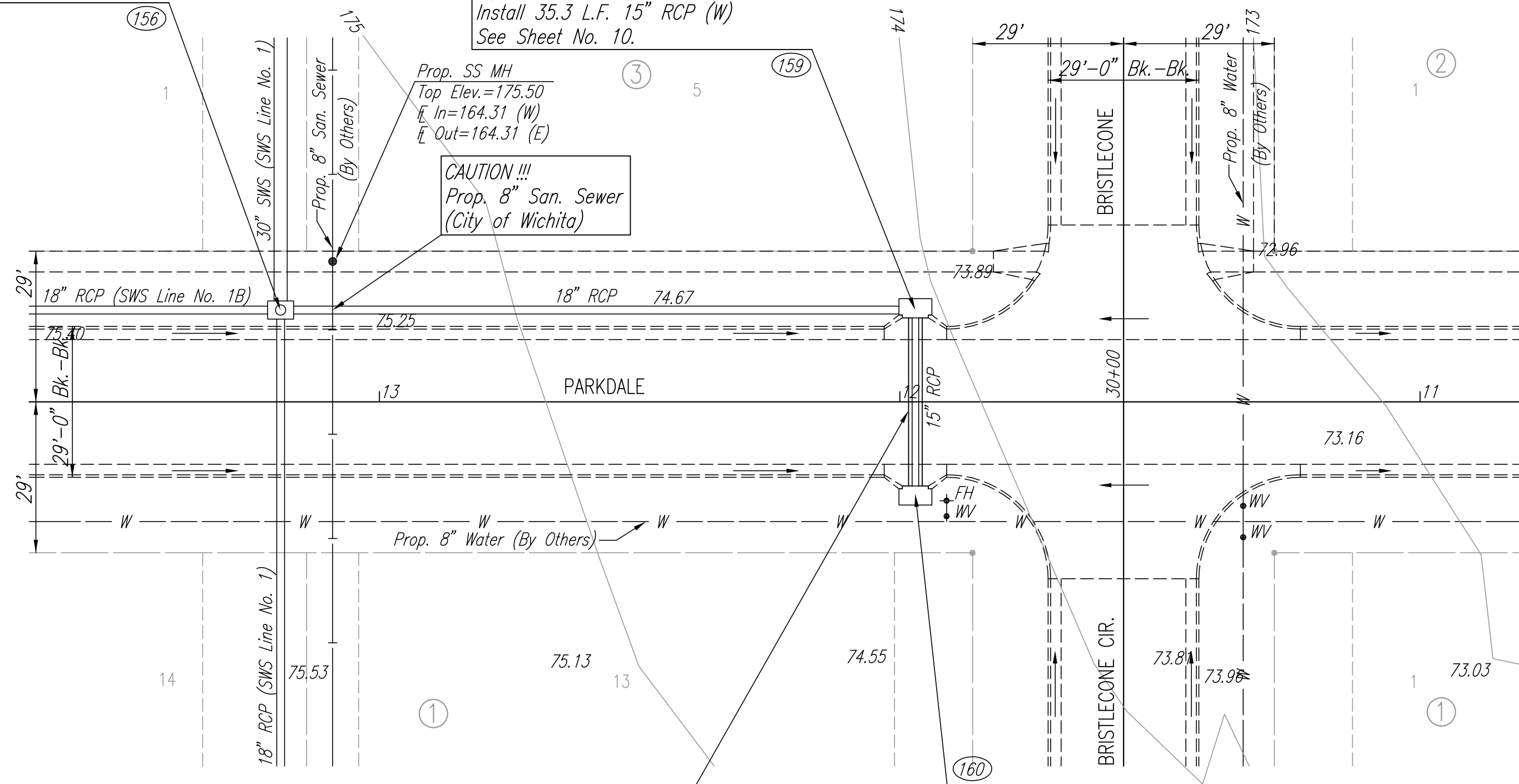

PROFILE CHECKED BY DATE

DSNR: BOB OPER: BJS SCALE: 1"=20.00
 Q:\2003\03123\000\SWS\SWSLN1A_02-03-2004 12:21:32 am

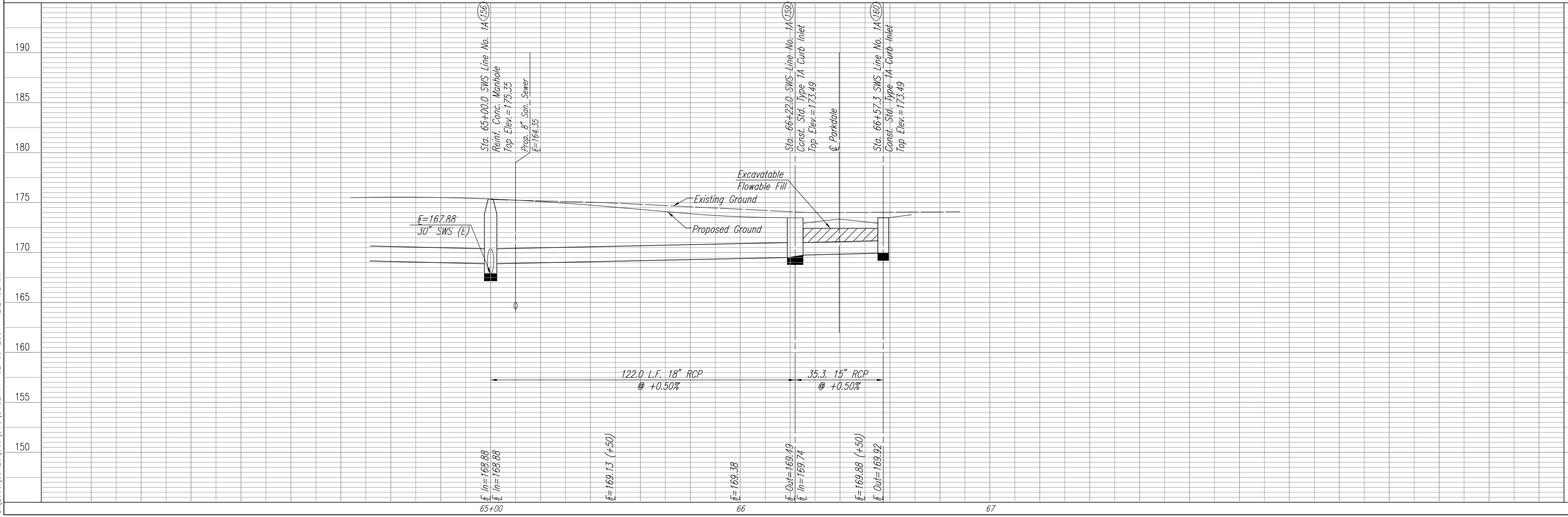

EVERGREEN 4TH
 STORM WATER SEWER NO. 589
SWS LINE NO. 1A
 JAMES L. ARMOUR, P.E.—ACTING CITY ENGINEER
 CITY OF WICHITA PROJECT NO. 468-83640

Professional Engineering Consultants, P.A.
 303 S. TOPKA • WICHITA, KANSAS 67202
 316-262-2691 • FAX 316-262-3003

Designed By: BOB BJS
 Drawn By: BJS
 Job No.: 35-03123
 Date: March 2003