

P.I. @ Sta. 45+20.00=
 E 1/4 Cor. Sec. 34, T26S, R1E
 N 1,707,175.2219 E 1,659,550.5173
 1. See References below

P.I. @ Sta. 71+92.65=
 SE Cor. Sec. 34, T26S, R1E
 N 1,704,503.6824 E 1,659,627.6440
 1. See References below

POINT NO.	NORTH COORDINATE	EAST COORDINATE
100	1,707,175.2219	1,659,550.5173
101	1,704,503.6824	1,659,627.6440
360	1,706,695.4201	1,659,564.3673
864	1,706,853.3904	1,659,559.8068
865	1,706,537.4497	1,659,568.9279

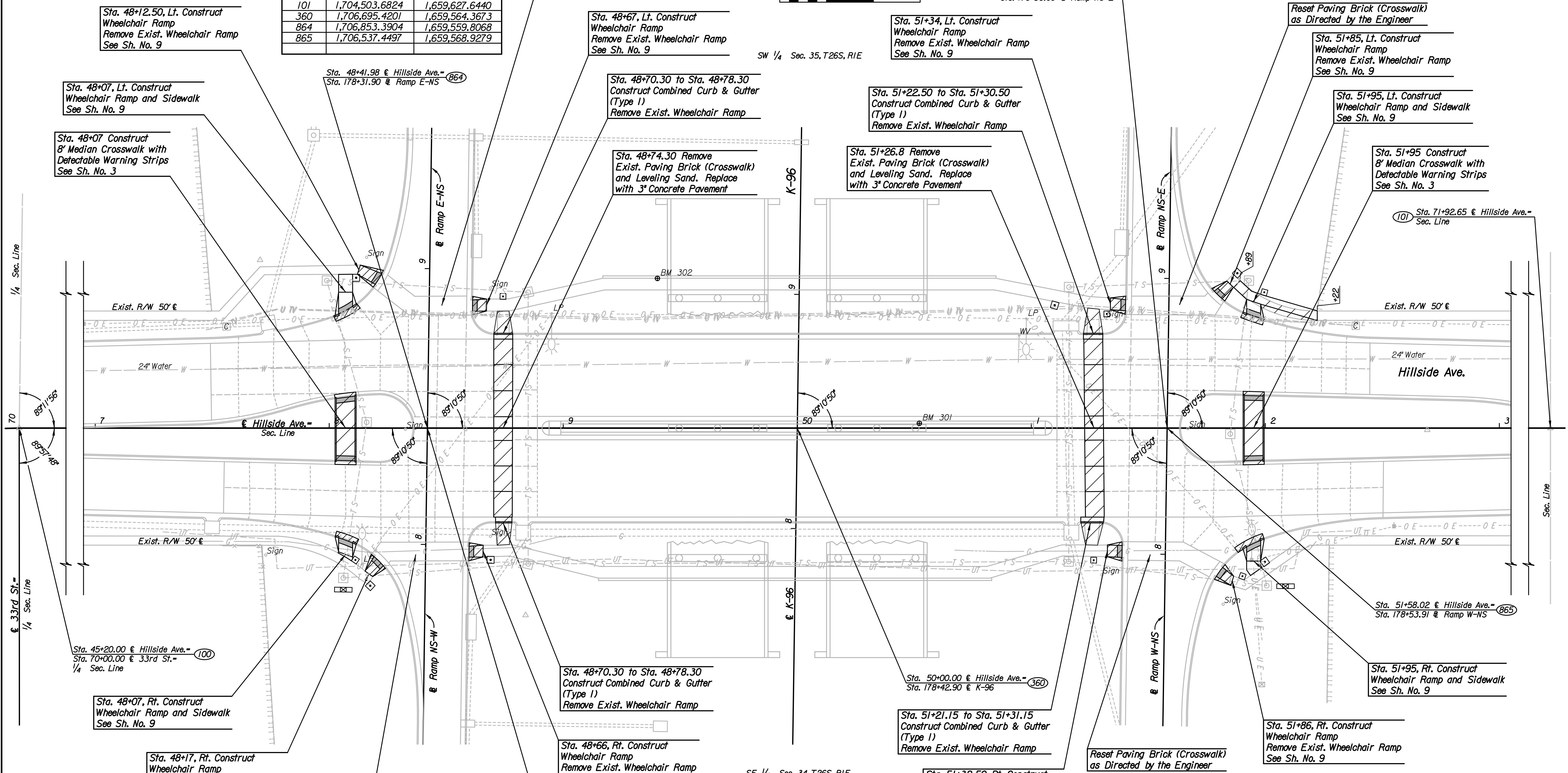
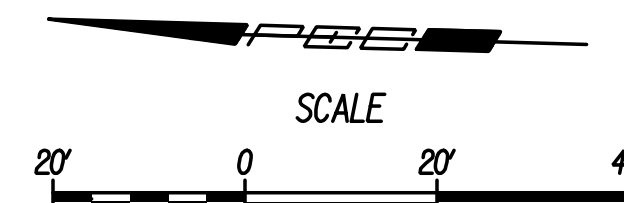

Sta. 48+12.50, Lt. Construct Wheelchair Ramp
 Remove Exist. Wheelchair Ramp
 See Sh. No. 9

Sta. 48+07, Lt. Construct Wheelchair Ramp and Sidewalk
 See Sh. No. 9

Sta. 48+07 Construct 8' Median Crosswalk with Detectable Warning Strips
 See Sh. No. 3

Sta. 48+41.98 @ Hillside Ave. = 864
 Sta. 178+31.90 @ Ramp E-NS

Reset Paving Brick (Crosswalk) as Directed by the Engineer

Sta. 48+67, Lt. Construct Wheelchair Ramp
 Remove Exist. Wheelchair Ramp
 See Sh. No. 9

Sta. 48+70.30 to Sta. 48+78.30 Construct Combined Curb & Gutter (Type 1)
 Remove Exist. Wheelchair Ramp

Sta. 48+74.30 Remove Exist. Paving Brick (Crosswalk) and Leveling Sand. Replace with 3" Concrete Pavement

Sta. 51+34, Lt. Construct Wheelchair Ramp
 Remove Exist. Wheelchair Ramp
 See Sh. No. 9

Sta. 51+22.50 to Sta. 51+30.50 Construct Combined Curb & Gutter (Type 1)
 Remove Exist. Wheelchair Ramp

Sta. 51+26.8 Remove Exist. Paving Brick (Crosswalk) and Leveling Sand. Replace with 3" Concrete Pavement

Reset Paving Brick (Crosswalk) as Directed by the Engineer

Sta. 51+85, Lt. Construct Wheelchair Ramp
 Remove Exist. Wheelchair Ramp
 See Sh. No. 9

Sta. 51+95, Lt. Construct Wheelchair Ramp and Sidewalk
 See Sh. No. 9

Sta. 51+95 Construct 8' Median Crosswalk with Detectable Warning Strips
 See Sh. No. 3

101 Sta. 71+92.65 @ Hillside Ave. = Sec. Line

Sta. 51+58.02 @ Hillside Ave. = 865
 Sta. 178+53.91 @ Ramp W-NS

Sta. 51+95, Rt. Construct Wheelchair Ramp and Sidewalk
 See Sh. No. 9

Sta. 51+86, Rt. Construct Wheelchair Ramp
 Remove Exist. Wheelchair Ramp
 See Sh. No. 9

Sta. 51+21.15 to Sta. 51+31.15 Construct Combined Curb & Gutter (Type 1)
 Remove Exist. Wheelchair Ramp

Sta. 51+32.50, Rt. Construct Wheelchair Ramp
 Remove Exist. Wheelchair Ramp
 See Sh. No. 9

Reset Paving Brick (Crosswalk) as Directed by the Engineer

Sta. 45+20.00 @ Hillside Ave. = 100
 Sta. 70+00.00 @ 33rd St. = 1/4 Sec. Line

Sta. 48+07, Rt. Construct Wheelchair Ramp and Sidewalk
 See Sh. No. 9

Sta. 48+17, Rt. Construct Wheelchair Ramp
 Remove Exist. Wheelchair Ramp
 See Sh. No. 9

Reset Paving Brick (Crosswalk) as Directed by the Engineer

Sta. 48+70.30 to Sta. 48+78.30 Construct Combined Curb & Gutter (Type 1)
 Remove Exist. Wheelchair Ramp

Sta. 48+66, Rt. Construct Wheelchair Ramp
 Remove Exist. Wheelchair Ramp
 See Sh. No. 9

Sta. 48+41.98 @ Hillside Ave. = 864
 Sta. 178+49.71 @ Ramp NS-W

Sta. 50+00.00 @ Hillside Ave. = 360
 Sta. 178+42.90 @ K-96

SE 1/4 Sec. 34, T26S, R1E

- Utilities
- Kansas Gas Service
 - Westar Energy
 - AT&T, Wichita Central Unit
 - Cox Communications
 - Wichita Water Utilities

- SE Cor. Sec. 34, T26S, R1E
- 60d Nail in Thimble at Corner
 - Nail & Shiner in SW Face of Light Pole
 - 3 Nails in N Face of Power Pole
 - Chiseled ** in Top of E Bolt at base of Power Pole
 - Center Top of Fire Hydrant
 - Centerline of Hillside Ave.
- 83.37' SE
 40.82' E
 47.73' W
 45.79' NE
 5.50' W

LEGEND

Pavement Removal

- E 1/4 Cor. Sec. 34, T26S, R1E
- 1/2" Bar at Corner of 33rd St. & Hillside Ave.
 - 3 Nails in Power Pole
 - 3 Nails in SW Face of High Line Pole
 - 3 Nails in Fence Post
 - Nail & Shiner in Wood Sign Post
 - W Face of R/W Marker
 - 3 Nails in Fence Post
- 58.83' SW
 47.25' SE
 47.50' NE
 63.86' NW
 40.05' E
 39.91' ESE

BM #302 - Chiseled ** on Retaining Wall, North side of K-96 Bridge, East side of Hillside.
 64' Lt. @ Sta. 49+40
 NAVD 88 Elev. = 1346.17

BM #301 - Chiseled ** on South side of K-96 Bridge, Center of Hillside on Median Wall.
 2' Lt. @ Sta. 50+52
 NAVD 88 Elev. = 1345.87

Plotted By: svb Date: 7/21/2014 9:52:14 AM
 FILE: U:\Wichita-Civil\2013\13675\000\Trans\Road\DN Project\Plan\13675-Hillside Plan.dgn

CITY OF WICHITA		By	Date
HILLSIDE PLAN STA. 47+00 TO STA. 53+00 GARY JANZEN, P.E.-CITY ENGINEER CITY OF WICHITA PROJECT NO. 472-85174			
PROFESSIONAL ENGINEERING CONSULTANTS, P.A. 303 SOUTH TOPEKA WICHITA, KS 67202 316-262-2691 www.pec1.com			
Designed by	SAC	Job No.	13675
Drawn by	SVB	Date	May, 2014
			Sh. 4 of 28