

PLOTTED: Wednesday, August 27, 2014 @ 07:47 AM



**STORM WATER SEWER PLAN FOR**  
**GREENWICH BUSINESS CENTER ADDITION**  
**DETENTION**

©2014 MKEC Engineering All Rights Reserved  
 www.mkec.com  
 These drawings and their contents, including, but not limited to, all concepts, designs, & ideas are the exclusive property of MKEC Engineering (MKEC), and may not be used or reproduced in any way without the express consent of MKEC.

**GRADING PLAN (NORTH)**

PROJECT NO.	468-84745	
DATE	AUGUST 2014	
SCALE	AS SHOWN	
DESIGNED	DRAWN	CHECKED
SLF	KKL	GJA
NO.	REVISION	DATE
SHEET NO.		

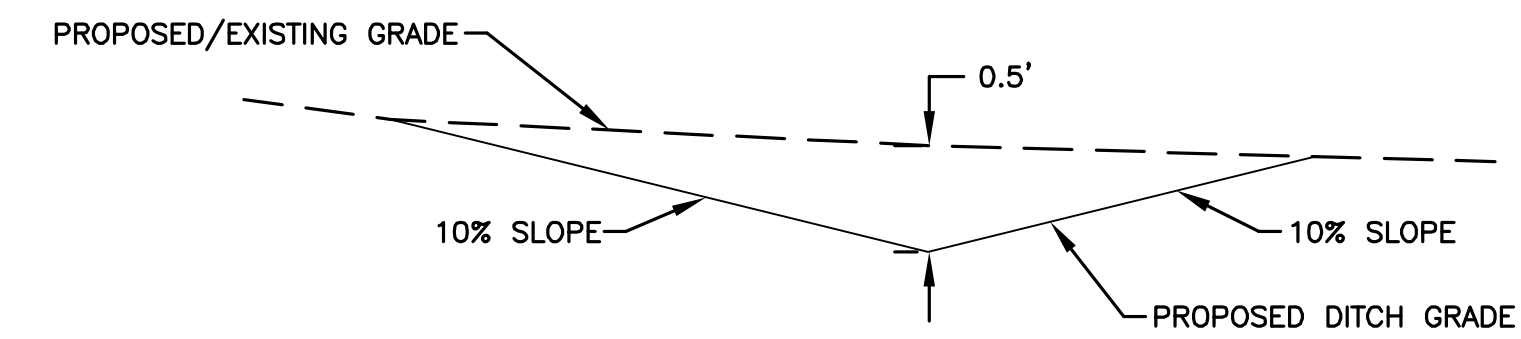

**TEMPORARY EROSION CONTROL DITCH**  
 (NON-DISCHARGING, MUST OVERTOP)

CHANNEL FLOWLINE POINTS			
STATION	Northing	Easting	ELEVATION
10+00	1704783.74	1687169.91	1381.80
10+25	1704808.73	1687169.41	1381.99
10+50	1704833.72	1687168.91	1382.78
10+75	1704858.72	1687168.41	1382.88
11+00	1704883.72	1687167.91	1382.90
11+25	1704908.71	1687167.41	1382.91
11+50	1704933.71	1687166.92	1382.93
11+75	1704958.70	1687166.42	1382.95
12+00	1704983.68	1687165.92	1382.97
12+25	1705008.65	1687165.46	1382.99
12+50	1705033.13	1687160.69	1383.72
12+75	1705054.26	1687147.87	1383.91
13+00	1705064.29	1687125.25	1383.95
13+25	1705076.96	1687104.75	1383.97
13+35.5 (PT)	1705087.01	1687102.26	1383.50
PC	1705003.65	1687165.52	1382.98
PCC1	1705046.40	1687154.58	1383.89
PCC2	1705060.93	1687136.60	1383.92
PCC3	1705065.14	1687122.31	1383.95
PCC4	1705079.39	1687103.54	1383.97

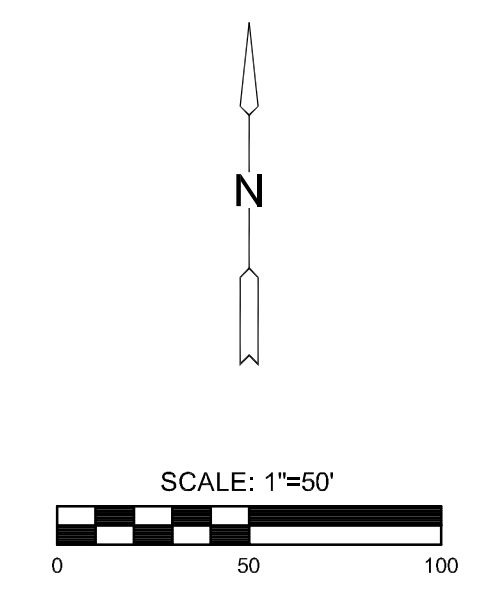

- NOTE:**
- NORTH EXTENT OF SURVEY DOES NOT DEPICT NEW 29TH STREET IMPROVEMENTS. FOR INFORMATION RELATED TO THE ROAD AND DITCHES SEE: 29TH STREET NORTH ROAD PLANS (K.E. MILLER ENGINEERING) PROJECT NO. 472-84983 OCA: 766283 OCTOBER 2012
  - POND #1, AS SHOWN ON THIS SHEET, WAS BUILT UNDER PRIVATE CONTRACT. THE GRADES ASSOCIATED WITH THIS POND AND SHOWN IN THIS SHEET ARE THE DESIGN CONTOURS, NOT SURVEYED CONTOURS.

EARTHWORK SUMMARY	
EXCAVATION	1825 C.Y.
EXCAVATION (ON SITE BORROW)	1565 C.Y.
COMPACTED FILL (95%)	2825 C.Y.
20% SHRINK/SWELL FACTOR ADDED IN DETERMINE OF NEED FOR ADDITIONAL EXCAVATION FOR FILL.	
CONTRACTOR MAY BORROW ADDITIONAL EXCAVATION AS REQUIRED FROM HILL ON SITE TO WEST. COORDINATE WITH FIELD ENGINEER.	

**LEGEND**

—1374—	PROPOSED CONTOUR
- - -1374 - - -	EXISTING CONTOUR
— W —	WATERLINE
— SS —	SANITARY SEWER
— SWS —	STORMWATER SEWER
— UGT —	EXISTING UNDERGROUND TELEPHONE
— UGE —	EXISTING UNDERGROUND ELECTRICAL
— G —	EXISTING GAS LINE
— TV —	EXISTING CABLE LINE
➔	DRAINAGE FLOW ARROW
▬▬▬▬▬▬	LIMITS OF GRADING
—+—+—+—	TEMPORARY EROSION CONTROL DITCH
⊕	DITCH CHECK

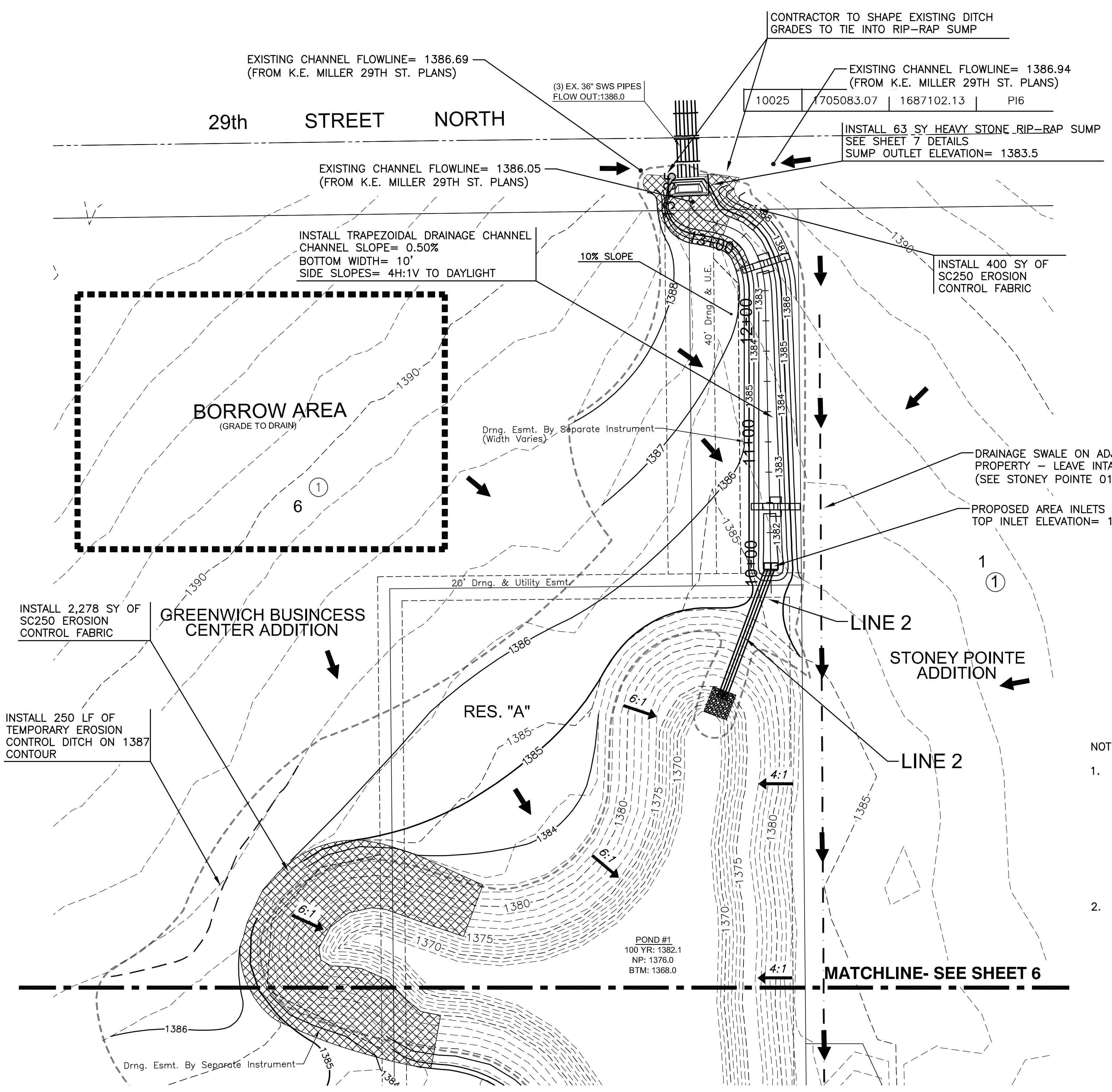

CONTRACTOR TO SHAPE EXISTING DITCH GRADES TO TIE INTO RIP-RAP SUMP

EXISTING CHANNEL FLOWLINE= 1386.69  
 (FROM K.E. MILLER 29TH ST. PLANS)

EXISTING CHANNEL FLOWLINE= 1386.94  
 (FROM K.E. MILLER 29TH ST. PLANS)

10025	1705083.07	1687102.13	PI6
-------	------------	------------	-----

INSTALL 63 SY HEAVY STONE RIP-RAP SUMP  
 SEE SHEET 7 DETAILS  
 SUMP OUTLET ELEVATION= 1383.5

EXISTING CHANNEL FLOWLINE= 1386.05  
 (FROM K.E. MILLER 29TH ST. PLANS)

INSTALL TRAPEZOIDAL DRAINAGE CHANNEL  
 CHANNEL SLOPE= 0.50%  
 BOTTOM WIDTH= 10'  
 SIDE SLOPES= 4H:1V TO DAYLIGHT

INSTALL 400 SY OF  
 SC250 EROSION CONTROL FABRIC

**BORROW AREA**  
 (GRADE TO DRAIN)

DRAINAGE SWALE ON ADJACENT PROPERTY - LEAVE INTACT  
 (SEE STONEY POINTE 0141 PPD 607861)

PROPOSED AREA INLETS  
 TOP INLET ELEVATION= 1371.8

INSTALL 2,278 SY OF  
 SC250 EROSION CONTROL FABRIC

**GREENWICH BUSINESS CENTER ADDITION**

INSTALL 250 LF OF  
 TEMPORARY EROSION CONTROL DITCH ON 1387 CONTOUR

LINE 2

STONEY POINTE ADDITION

LINE 2

**MATCHLINE- SEE SHEET 6**

POND #1  
 100 YR: 1382.1  
 NP: 1376.0  
 BTM: 1368.0

Drng. Esmt. By Separate Instrument

RES. "A"

20' Drng. & Utility Esmt.

Drng. Esmt. By Separate Instrument  
 (Width Varies)

(3) EX. 36" SWS PIPES  
 FLOW OUT: 1386.0