

PAVING PLANS FOR
MESSIAH BAPTIST CHURCH 4TH ADDITION
21ST STREET RIGHT TURN LANE

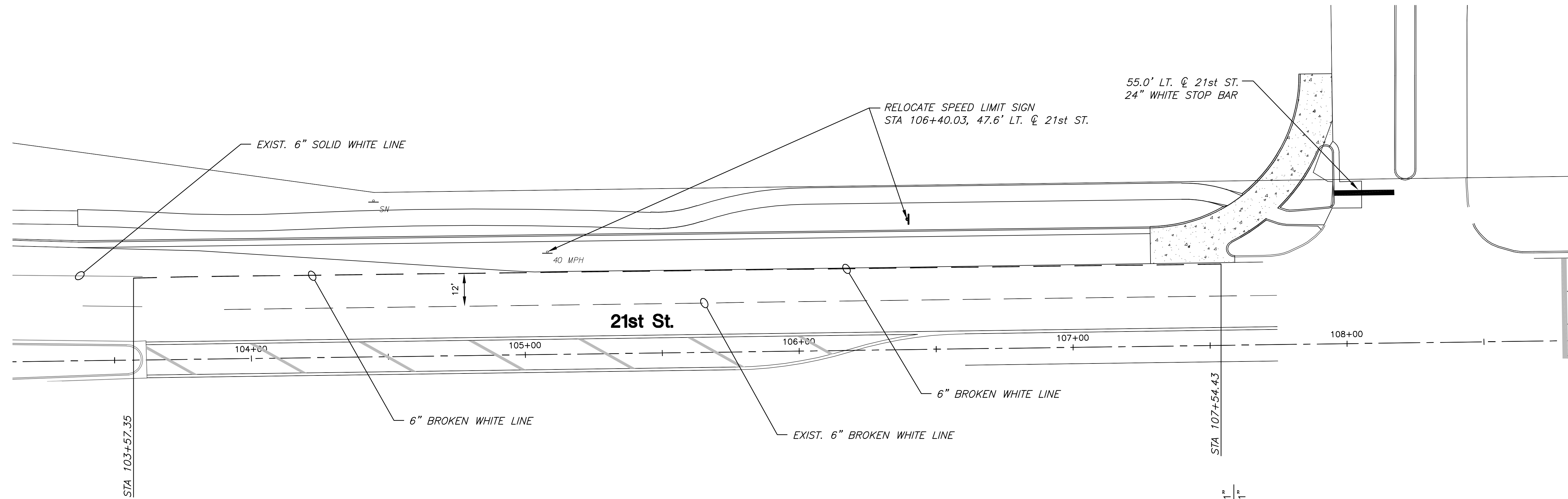

PAVEMENT MARKINGS - ALL PAVEMENT MARKINGS SHALL BE EPOXY, UNLESS OTHERWISE APPROVED BY THE ENGINEER. PAVEMENT MARKINGS SHALL BE INSTALLED PER MANUFACTURER'S RECOMMENDATIONS AND SHALL MEET KDOT 2007 EDITION STANDARD SPECIFICATION SECTION 806. FULL TRAFFIC MAY NOT BE RESTORED (AND SUBSTANTIAL PROJECT COMPLETION ACHIEVED) UNTIL ALL PAVEMENT MARKINGS ARE IN PLACE. SHOULD CONSTRUCTION TIMING BE SUCH THAT RESTORATION OF TRAFFIC BECOMES NECESSARY DURING TEMPERATURES PROHIBITING THE INSTALLATION OF EPOXY MARKINGS, THE CONTRACTOR SHALL INSTALL AND MAINTAIN TEMPORARY MARKINGS UNTIL SUCH TIME THAT EPOXY MARKINGS MAY BE PROPERLY INSTALLED. EXCEPT FOR THE MATERIAL REQUIREMENT, TEMPORARY PAVEMENT MARKINGS SHALL BE PLACED EQUIVALENT, IN EVERY MANNER (I.E. DIMENSION, FREQUENCY, SPACING, ETC.), TO THE PERMANENT MARKING LAYOUT. THE COST FOR TEMPORARY PAVEMENT MARKINGS WILL NOT BE PAID FOR DIRECTLY, BUT SHALL BE CONSIDERED SUBSIDIARY TO THE BID ITEM FOR "PAVEMENT MARKINGS".

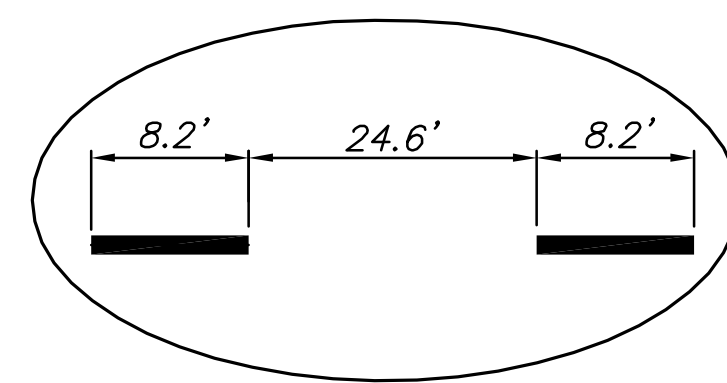

TYPICAL BROKEN LINE DETAIL

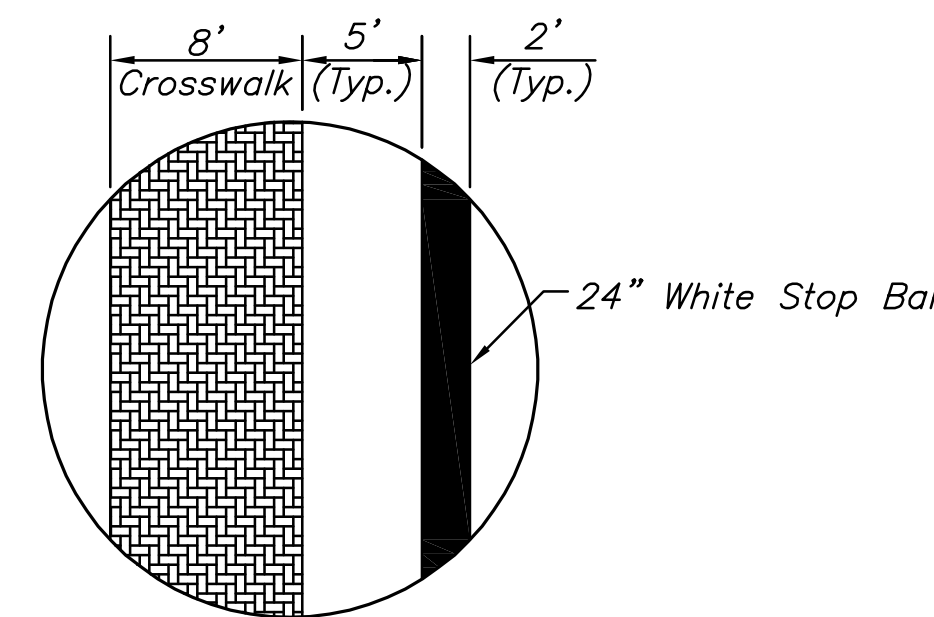

TYPICAL STOP BAR DETAIL

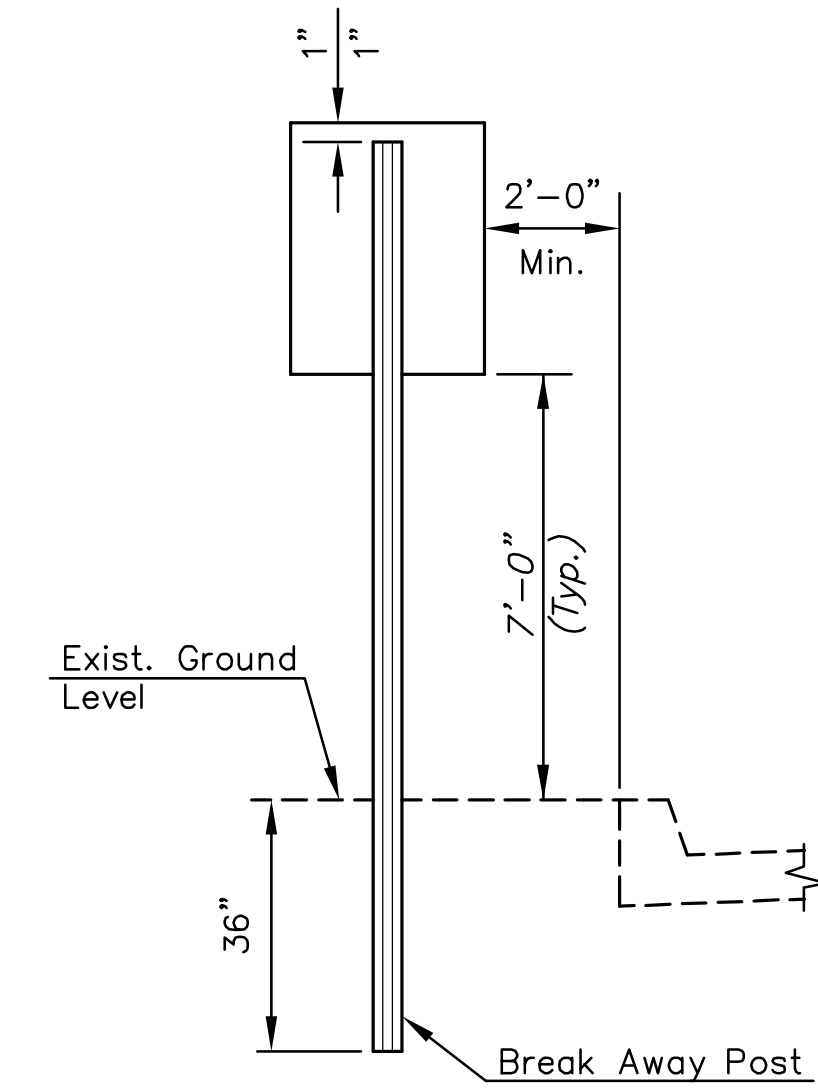

TRAFFIC SIGN INSTALLATION DETAIL

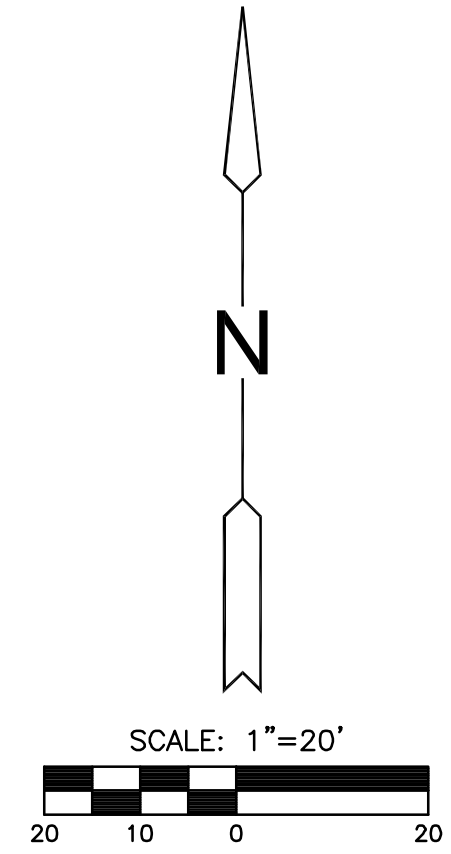

©2013 MKEC Engineering All Rights Reserved
www.mkec.com
These drawings and their contents, including, but not limited to, all concepts, designs, & ideas are the exclusive property of MKEC Engineering (MKEC), and may not be used or reproduced in any way without the express consent of MKEC.

SIGNING & MARKING PLAN

| | | |
|-------------|-----------|---------|
| PROJECT NO. | 472-85168 | |
| DATE | JULY 2014 | |
| SCALE | 1"=20' | |
| DESIGNED | DRAWN | CHECKED |
| SPE | SPE | GJA |
| NO. | REVISION | DATE |

SHEET NO.
11 OF 28

J:\PROJECTS\2013\13010705_NEWSPRING_CHURCH-CIVIL\CAD\PAV\13705_PAV1.DWG