

9-1

POINT REPAIR:  
Remove and replace 63 lf of 8" pipe  
from MH 5248-349 to 63 lf west of  
MH 5248-349. Removal and replacement  
of concrete parking lot shall be incidental  
to the repair.

MH # 5248-349  
Approx depth = 10.1 ft

MH # 5248-350

WESTRIDGE

JOANN

GOW

300'

154'

143'

209'

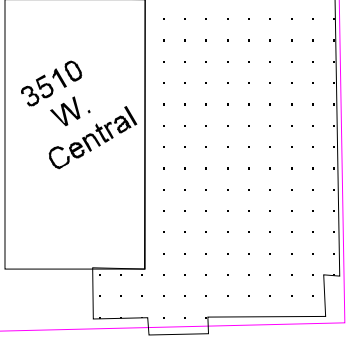

3510  
W.  
Central

CENTRAL

SITE 9

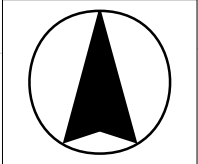

9-2

WESTRIDGE

JOANN

3510 W. Central

CENTRAL

Aerial View

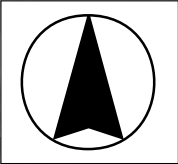

# Television Inspection Master Report

3/11/2004  
3:59:15PM

US Manhole: 5248-350  
DS Manhole: 5248-349

3510 W CENTRAL AVE  
3510 W CENTRAL ST

Date Insp: 1/8/2004

Basin: WC03F

Dir Televised: Upstream To Downstream

## Pipe Information

Shape:	Round	Length Status:	Project No.:	H-203
Dia/Ht Width:	8 0	Material:	Index:	
Length:	142.8	Slope:	Surface:	

## Inspection Information

Crew:	696	Percent Full:	15	Tape ID:	V-4190
Weather:	Sunny	Purpose:	TV Existing Line	Counter Start:	0.17.46.
Surface Cond:	N/A	Flow:	Normal Flow	Counter Stop:	0.42.45.

## Maintenance Prior to TV:

Cleaned:	0	Degrease:	0	Point Repair:	0	Manhole Replace:	0
Root Cut:	0	Root Chem:	0	Other:			
Overall Cond:	Poor						
Collapsed/Blk:	N						
Max Obs #:	13						
Max Obs Length:	143.0						

		<u>Total</u>	<u>Remaining</u>	<u>Rating</u>
Structural:		0	0	0.0
Flow:		0.001	0.001	0.001
Cleaning:		45	45	31.5

Obs. #	VTR Counter Comment	Dist	Location	Description	Rating	Obsrvd (gpm)	Est. (gpm)	Ratings		
								Struct	Clean	Remain (gpm)
1		0.0	US Manhole 5248-350	ADDRESS 3510 W CENTRAL						
2		13.0	South	Break-In Conn / PVC	1		0.001	0	0	0.001
3		16.0	Crown	Grease	1		0.000	0	0	0.000
4		27.0	Quad 4 / U-Lt	Grease	3		0.000	0	5	0.000
5		30.0	Quad 4 / U-Lt	Grease	4		0.000	0	10	0.000
6		41.0	Crown	Grease	4		0.000	0	10	0.000
7		43.0	South	Wye (sealed off)	1		0.000	0	0	0.000
8		69.0	South	Wye Service	1		0.000	0	0	0.000
9		80.0	Crown	Grease	4		0.000	0	10	0.000
10		85.0	Invert							
USED CLEANER TO PULL DOWN WATER.										
11		90.0	Crown	Grease	4		0.000	0	10	0.000
12		101.0	North	Wye (sealed off)	1		0.000	0	0	0.000
13		143.0	DS Manhole 5248-349							

WE HAD TO PULL OUT CAMERA TO RECLEAN DUE TO GREASE AND DEBRIS IN LINE. AT 85 FT MARK. ALSO PULLED DOWN WATER. THIS LINE HAS BAD SAG FROM ABOUT 90 FT TO 120 FT MARK.

**POINT REPAIR:** Remove and replace the downstream 63 lf to correct the grade. Sag is causing excessive maintenance and stoppages.



Standing in Joann Street, east of MH 5248-349, looking west.  
The entire point repair is within the concrete parking lot.