

BENCHMARK:

BM #1: "□" Cut on top of curb, east side of Ridgehurst, adjacent to common front lot corner of Lots 6 & 7, Block E, Stonebridge 2nd Addition.
ELEV. = 1348.51 NGVD29

BM #2: "□" Cut on top of curb, south side of Sundance, near end of pavement in front of Lot 6, Block 3, Savannah at Castle Rock Ranch 7th Addition.
ELEV. = 1347.33 NGVD29

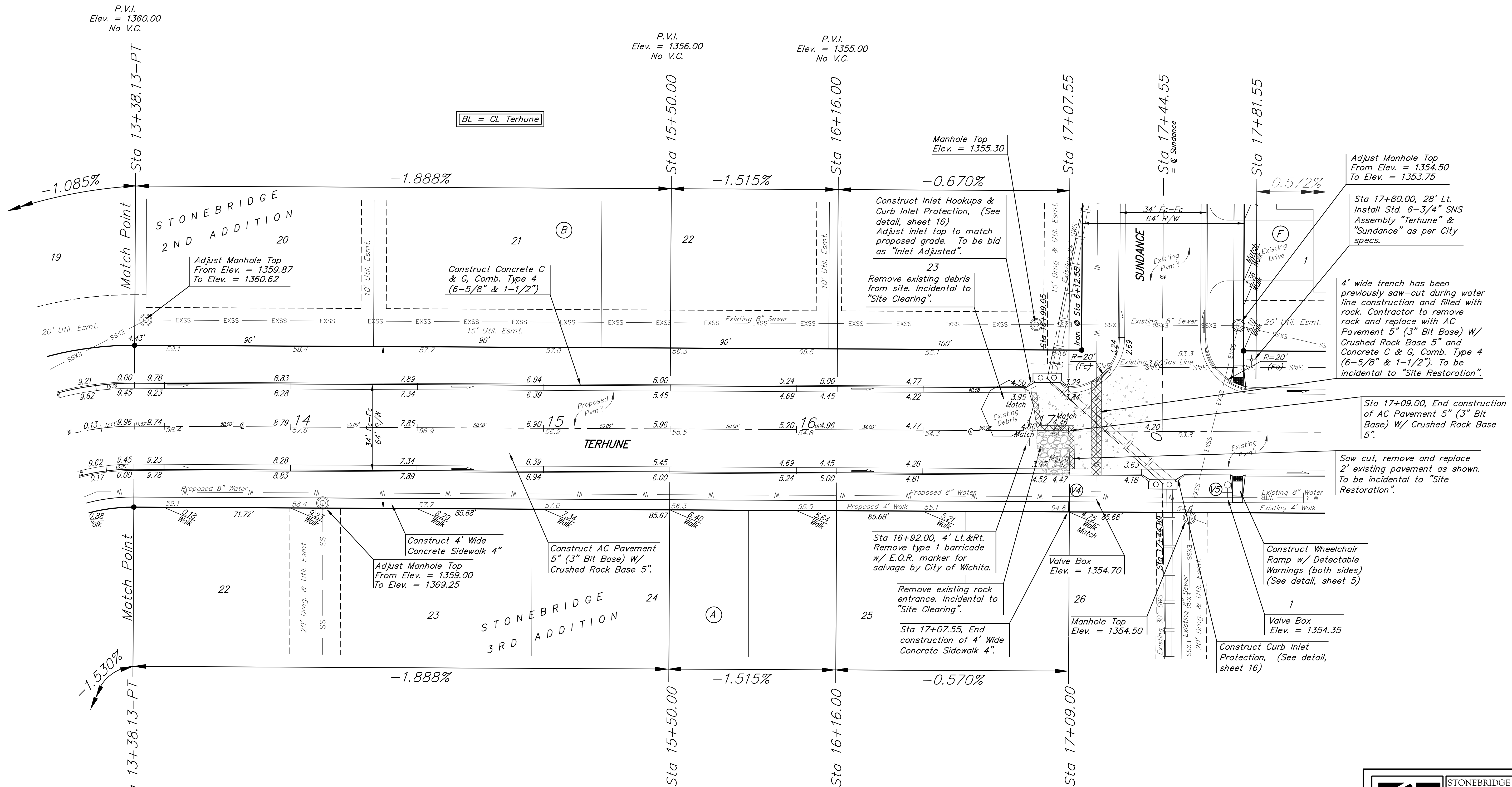
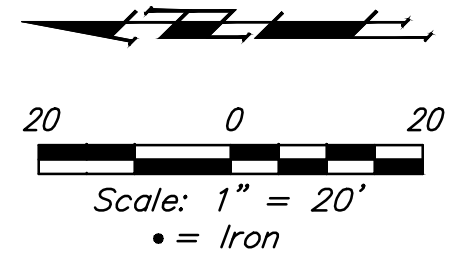

P.V.I.
Elev. = 1360.00
No V.C.

P.V.I.
Elev. = 1356.00
No V.C.

P.V.I.
Elev. = 1355.00
No V.C.

P.V.I.
Elev. = 1354.47
No V.C.

WATER VALVE LOCATION TABLE

VALVE NUMBER	STREET	BASELINE STATION	OFFSET DISTANCE	OFFSET DIRECTION
V4	Terhune	7+18.55	26'	Rt.
V5	Terhune	7+70.55	26'	Rt.

Paving contractor will be responsible to operate all water valves on the project, in the presence of the inspector, to ensure accessibility to the valves, and that all valves (except blowoffs) are left in the "ON" position when the project is completed.

	STONEBRIDGE 2ND/3RD ADD. PH. 3 TERHUNE STA 13+38.13 TO STA 17+81.55	
	Baughman Company, P.A. 315 Ellis St., Wichita, KS 67211 P 316-262-2771 F 316-262-0149 ENGINEERING SURVEYING PLANNING LANDSCAPE ARCHITECTURE	
PROJECT NUMBER 472-84593	DESIGN TJW	DRAWN TMS
REVISIONS:	APPROVED DATE 11/14	SCALE Noted SHEET
		9 OF 27
StrSws 06-08-E639.dwg		06-08-E639