

BENCHMARKS:
 BM #1: City of Wichita Benchmark
 Disc, top of curb adjacent to fire hydrant, west end of north curb return, intersection of Fawnwood and Kennedy, south corner of Lot 11, Block D, The Woods Addition.
 Elev. = 1382.28 NGVD29

BM #2: City of Wichita Benchmark
 Disc, Top of curb top of curb adjacent to fire hydrant, east end of north curb return, intersection of Fawnwood and Kennedy, southwest corner of Lot 53, Block B, The Woods Addition.
 Elev. = 1378.78 NGVD29

BM #3: City of Wichita Benchmark
 Disc, Top of curb top of curb adjacent to fire hydrant at west end of north curb return, intersection of Jayson and City View Cir, southeast corner of Lot 46, Block B, The Woods Addition.
 Elev. = 1378.78 NGVD29

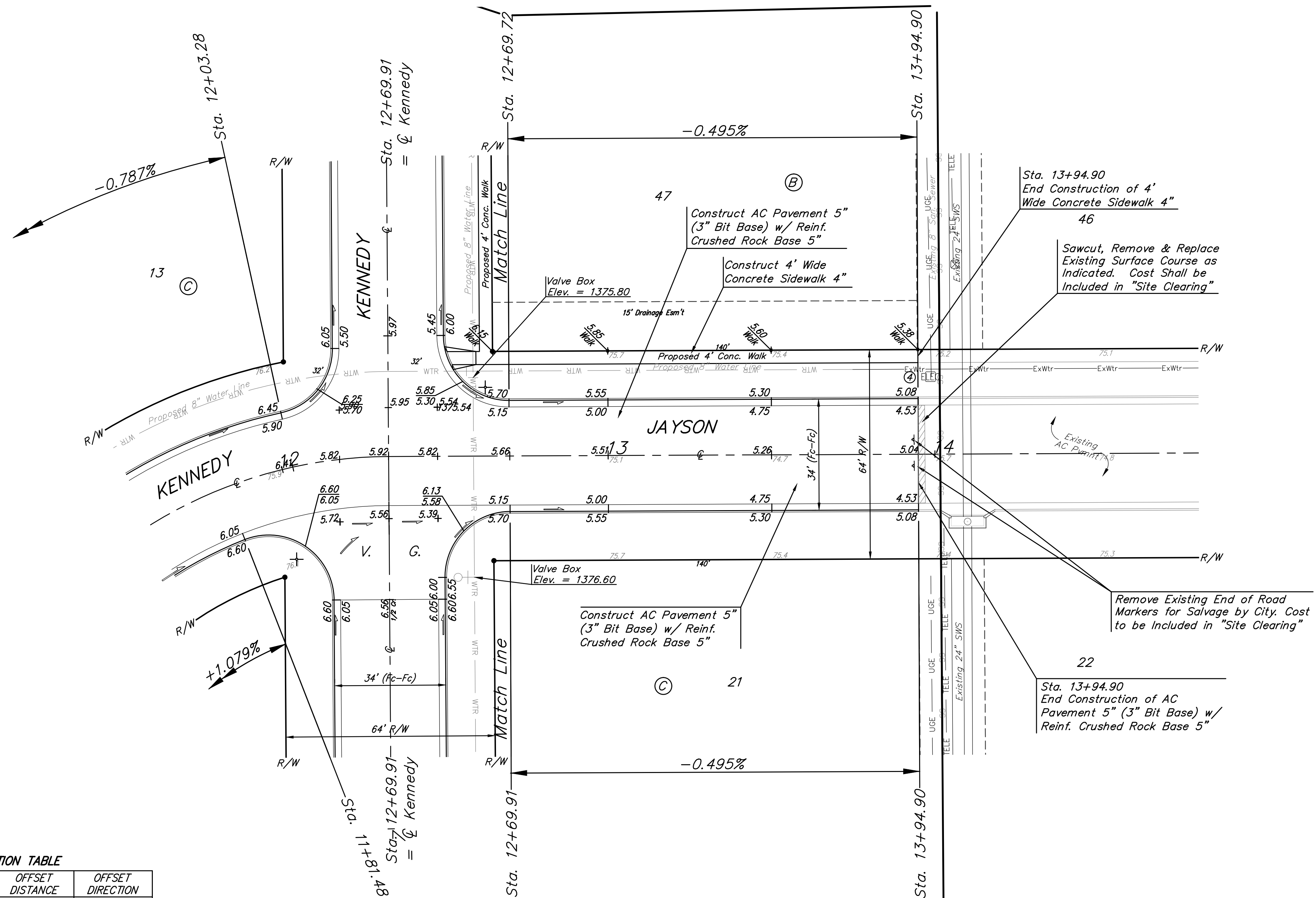
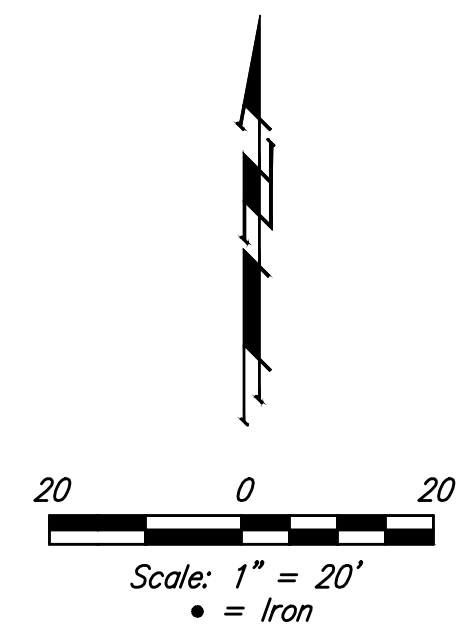

VALVE LOCATION TABLE

VALVE NUMBER	BASELINE STATION	OFFSET DISTANCE	OFFSET DIRECTION
1	1+32.00	26'-0"	Lt.
2	5+60.17	24'-0"	Lt.
3	5+62.17	26'-0"	Lt.
4	13+94.90	26'-0"	Lt.

Paving contractor will be responsible to operate all water valves on the project, in the presence of the inspector, to ensure accessibility to the valves, and that all valves are left in the "ON" position when the project is completed."

NOTE: Roll Type Curb & Gutter (Type 2) to be constructed on the pavement shown on this sheet. Top of curb elevations are given for Full Height Curb (Type 4).

	The Woods Addition - Phase 5	
	JAYSON STA. 12+69.91 TO STA. 13+94.90	
<small>Baughman Company, P.A. 315 Ellis St. Wichita, KS 67211 P 316-262-7271 F 316-262-0149 ENGINEERING SURVEYING PLANNING LANDSCAPE ARCHITECTURE</small>		
PROJECT NUMBER 472-84949	DESIGN AEG	DRAWN JAK
REVISIONS:	APPROVED	DATE 8/14
SCALE 1" = 20'		SHEET 11 OF 26