

**LEGEND**

- Pavement to be removed
- 
- 
- 
- 
- 
- 

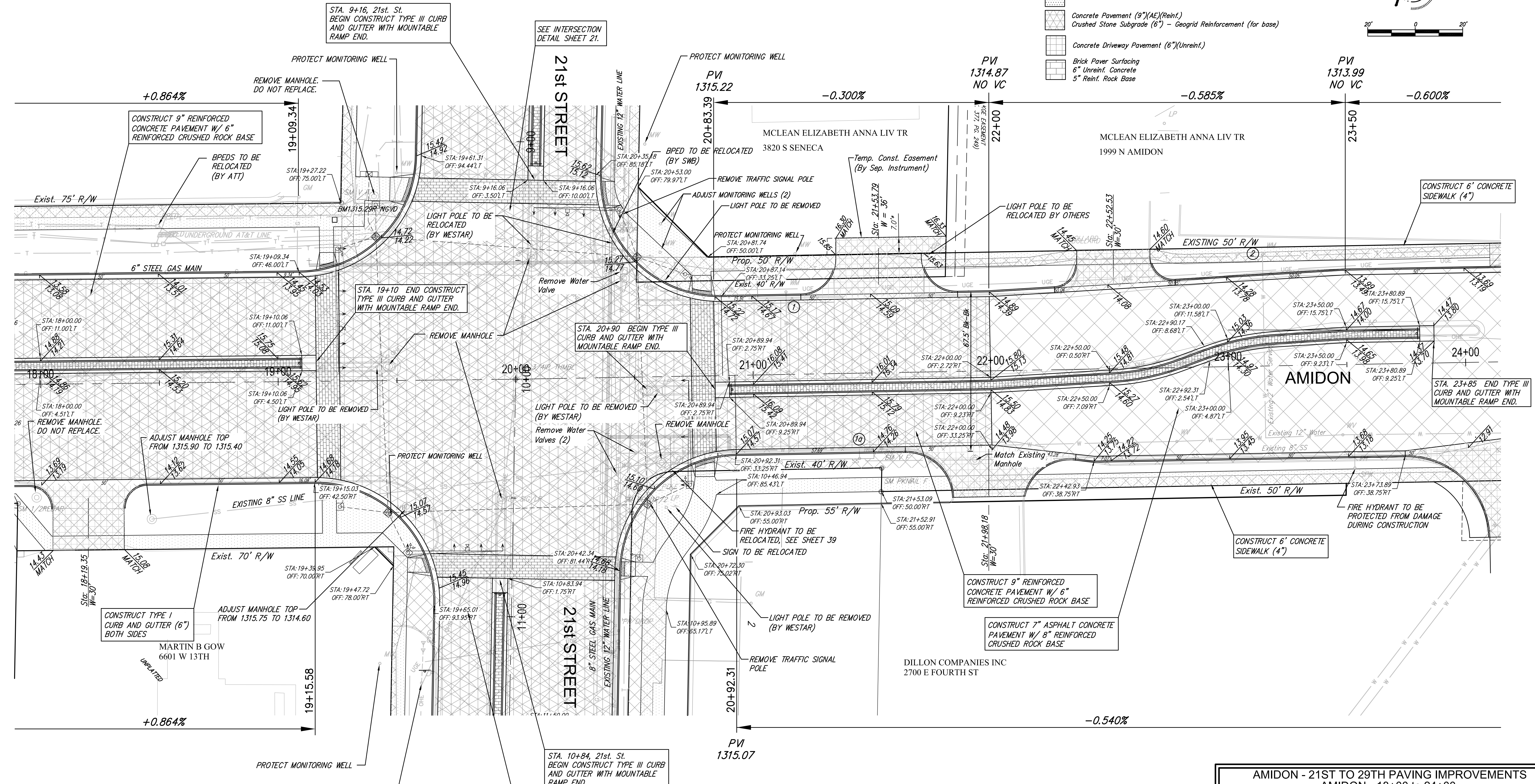
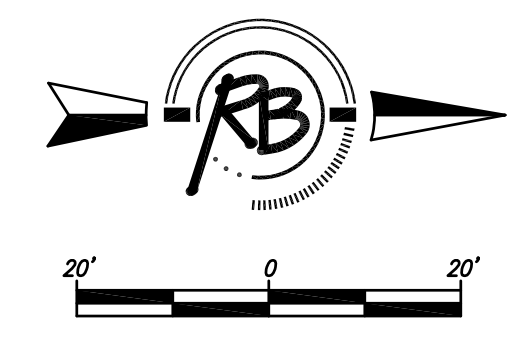

(X) - WATER METER TO BE RELOCATED OR ADJUSTED (SEE TABLE)  
 5.0' - DISTANCE FROM R/W TO MATCH POINT ON DRIVEWAYS

WHEN METER TOPS ARE ADJUSTED, CONTRACTOR SHALL ADJUST METER SETTER IF DIRECTED BY THE FIELD ENGINEER.

WHEN METER RELOCATION IS NECESSARY, CONTRACTOR SHALL PROVIDE NEW PARTS TO INCLUDE: BRASS SHARKBITE OR APPROVED EQUAL, TUBING OF THE SAME TYPE AS EXISTING SERVICE, NEW WATER METER SETTER, COPPER PIGTAIL, D.I. METER BOX RING AND A D.I. METER RING LID.

**Water Meter Relocation/Adjustment**

No	Existing Location	As-Built Location	Notes
1	21+14, Lt		
1a	21+44, Rt		
2	23+15, Lt		

**AMIDON - 21ST TO 29TH PAVING IMPROVEMENTS**  
 AMIDON - 18+00 TO 24+00  
 WICHITA, KANSAS

**RUGGLES & BOHM**

ENGINEERING | SURVEYING | LANDSCAPE ARCHITECTURE | GOVERNMENT

924 NORTH MAIN WICHITA, KANSAS 67203 P (316) 264-8008 F (316) 264-4621  
 WWW.RUGGLESANDBOHM.COM

DATE: Oct. 23, 2014  
 DESIGN: KWL  
 DRAWN: RA/DGZ  
 REVIEW: [ ]

PROJECT NUMBER: 472-84914	RB JOB NO.: 3647T	DWG. SCALE: 20	SHEET: 6 OF 133
DRAWING FILE: ENGINEERING BASE [Amidon 2-21st]			