

STORM WATER PLANS FOUND ON SHEETS 26 TO 38.

**LEGEND**

- Pavement to be removed
- Concrete Construction 8" Reinforced Crushed Stone Subgrade (7") - Geogrid Reinforcement (for base)
- Concrete Sidewalk (4" or 5" see plan note)
- Concrete Driveway Pavement (6")(Unreinft.)

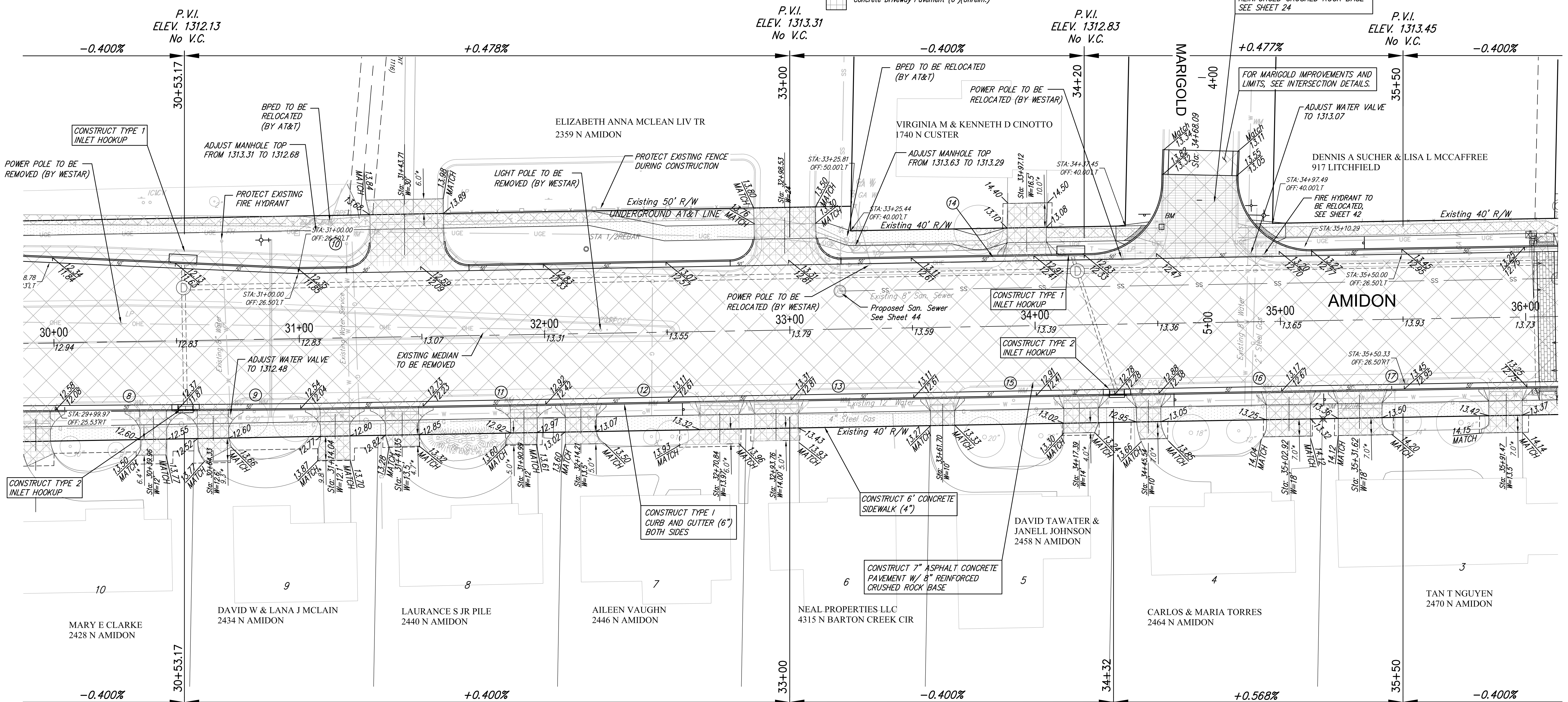
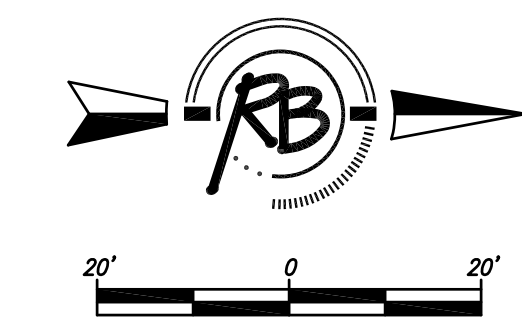

**Water Meter Relocation/Adjustment**

No	Existing Location	As-Built Location	Notes
8	30+30, Rt		
9	30+81, Rt		
10	31+20, Lt		
11	31+82, Rt		
12	32+40, Rt		
13	33+18, Rt		
14	33+81, Lt		
15	33+91, Rt		
16	34+90, Rt		
17	35+46, Rt		Replace Entire Service

(X) - WATER METER TO BE RELOCATED OR ADJUSTED (SEE TABLE)  
 5.0' - DISTANCE FROM R/W TO MATCH POINT ON DRIVEWAYS

**AMIDON - 21ST TO 29TH PAVING IMPROVEMENTS**  
 AMIDON - 30+00 TO 36+00  
 WICHITA, KANSAS

**RUGGLES & BOHM**  
 ENGINEERING | SURVEYING | LANDSCAPE ARCHITECTURE | GOVERNMENT  
 924 NORTH MAIN WICHITA, KANSAS 67203 P (316) 264-8008 F (316) 264-4621  
 WWW.RUGGLESANDBOHM.COM

DATE: Oct. 23, 2014  
 DESIGN: KWL  
 DRAWN: RA/DGZ  
 REVIEW: [Signature]  
 PROJECT NUMBER: 472-84914  
 RB JOB NO.: 36471  
 DWG. SCALE: 20  
 SHEET: 8 OF 133