

XX - WATER METER TO BE RELOCATED OR ADJUSTED (SEE TABLE)  
 5.0' - DISTANCE FROM R/W TO MATCH POINT ON DRIVEWAYS

**LEGEND**

- Pavement to be removed
- Concrete Construction 8" Reinforced Crushed Stone Subgrade (7") - Geogrid Reinforcement (for base)
- Concrete Sidewalk (4" or 5" see plan note)
- Concrete Driveway Pavement (6")(Unreinft.)

STORM WATER PLANS FOUND ON SHEETS 26 TO 38.

NOTE: PAVEMENT CENTERLINE TRANSITIONS FROM CENTERED TO 3.0' RIGHT OF CENTER FROM 71+00 TO 72+50.

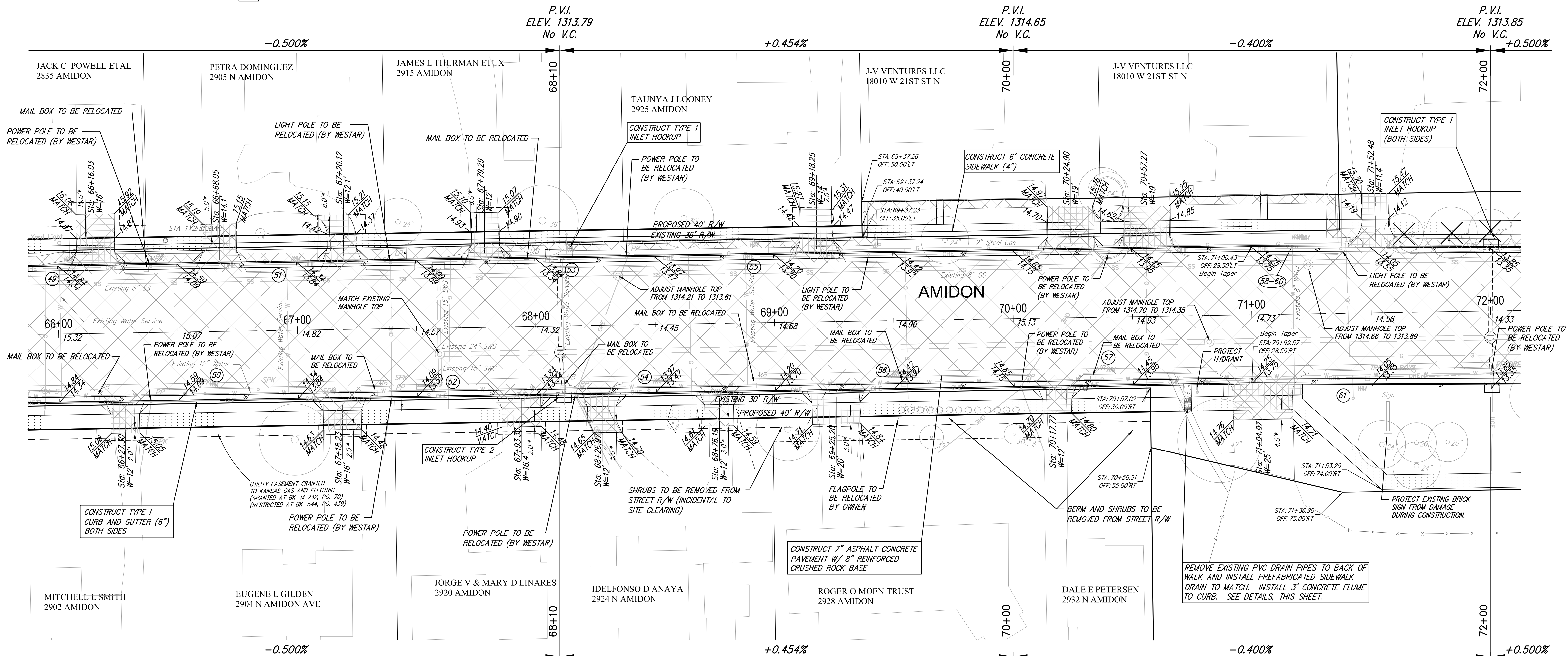
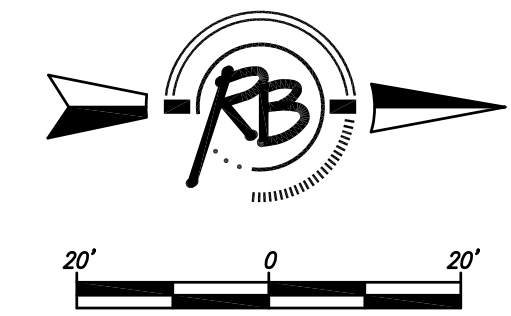

**Water Meter Relocation/Adjustment**

No	Existing Location	As-Built Location	Notes
49	66+01, Lt		
50	66+61, Rt		
51	66+96, Lt		
52	67+54, Rt		
53	68+11, Lt		
54	68+46, Rt		
55	68+88, Lt		
56	69+47, Rt		
57	70+37, Rt		Replace Water Service Except Corporation
58	71+15, Lt		
59	71+17, Lt		
60	71+19, Lt		
61	71+44, Rt		

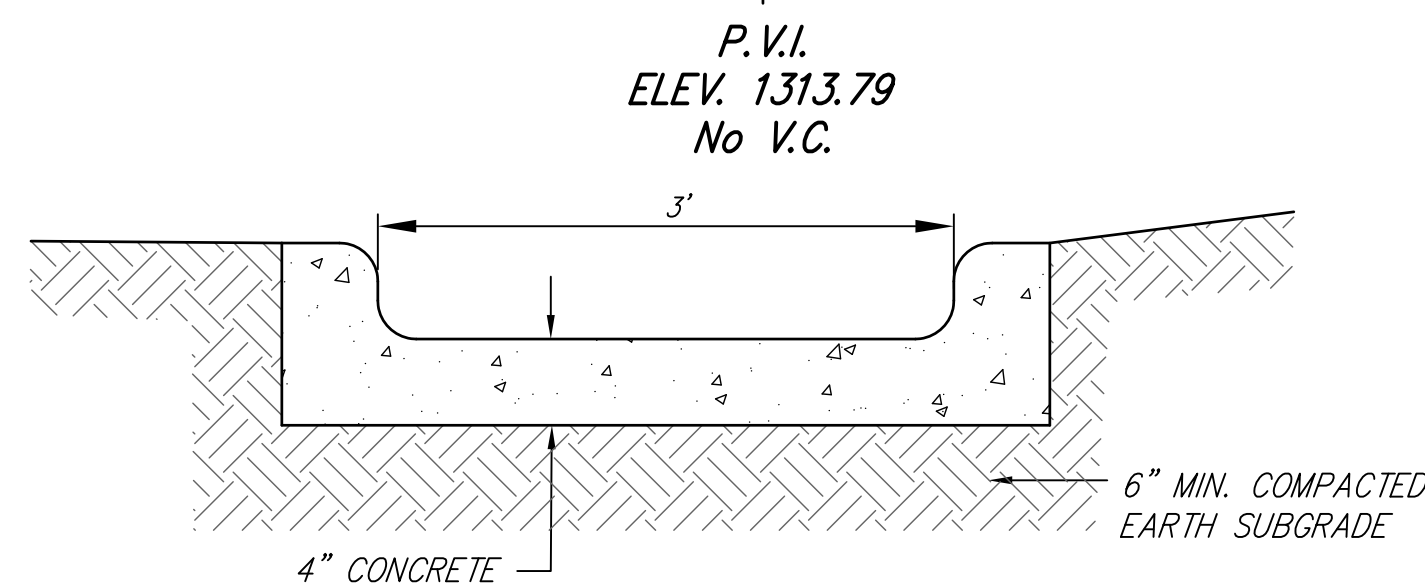

**CONCRETE FLUME SECTION**

NOT TO SCALE

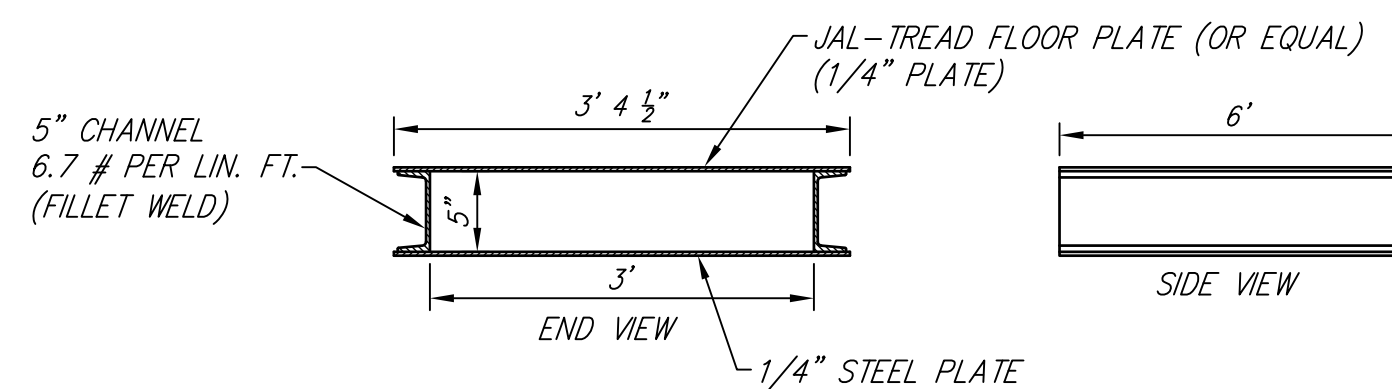

**PREFABRICATED SIDEWALK DRAIN**

NOT TO SCALE

**AMIDON - 21ST TO 29TH PAVING IMPROVEMENTS**  
 AMIDON - 66+00 TO 72+00  
 WICHITA, KANSAS

	<b>RUGGLES &amp; BOHM</b>	DATE Oct. 23, 2014
	<small>ENGINEERING   SURVEYING   LANDSCAPE ARCHITECTURE   GOVERNMENT</small> 924 NORTH MAIN WICHITA, KANSAS 67203 P (316) 264-8008 F (316) 264-4621 WWW.RUGGLESANDBOHM.COM	DESIGN KWL
PROJECT NUMBER <b>472-84914</b>	DWG. SCALE <b>3/4" = 1'</b>	DRAWN RA/DGZ
DRAWING FILE ENGINEERING BASE {Amidon 10}	SHEET <b>14</b>	REVIEW