

N 1700690.32 E 1641284.52
 STA. 0+29.53, SS LINE 2
 CONNECT TO EXISTING MANHOLE
 D = 4.0'
 TOP ELEV. 1313.92

Note: No existing MH. Used non-shear coupling to connect to existing pipe at property line.

N 1700689.70 E 1641314.05
 STA. 0+00.00, SS LINE 1=
 STA. 0+00.00, SS LINE 2
 REMOVE EXISTING MANHOLE.
 CONSTRUCT STD. TYPE 'P' MANHOLE
 D = 4.0'
 TOP ELEV. 1313.00

REMOVE AND RESET FENCES AS NECESSARY FOR SANITARY SEWER CONSTRUCTION. SUBSIDIARY TO THE BID ITEM FOR "SITE CLEARING"

N 1700397.34 E 1641319.19
 STA. 2+92.40, SS LINE 1
 REMOVE EXISTING MANHOLE
 CONSTRUCT STD. TYPE 'P' MANHOLE
 D = 4.0'
 TOP ELEV. 1313.13

NOTE: CONTRACTOR SHALL BE RESPONSIBLE FOR CONVEYING EXISTING SEWER FLOWS DURING CONSTRUCTION. CONTRACTOR SHALL SUBMIT PUMPING PLAN TO FIELD ENGINEER FOR APPROVAL PRIOR TO BEGINNING CONSTRUCTION. SUBSIDIARY TO THE THE BID ITEM FOR 8" SEWER PIPE.

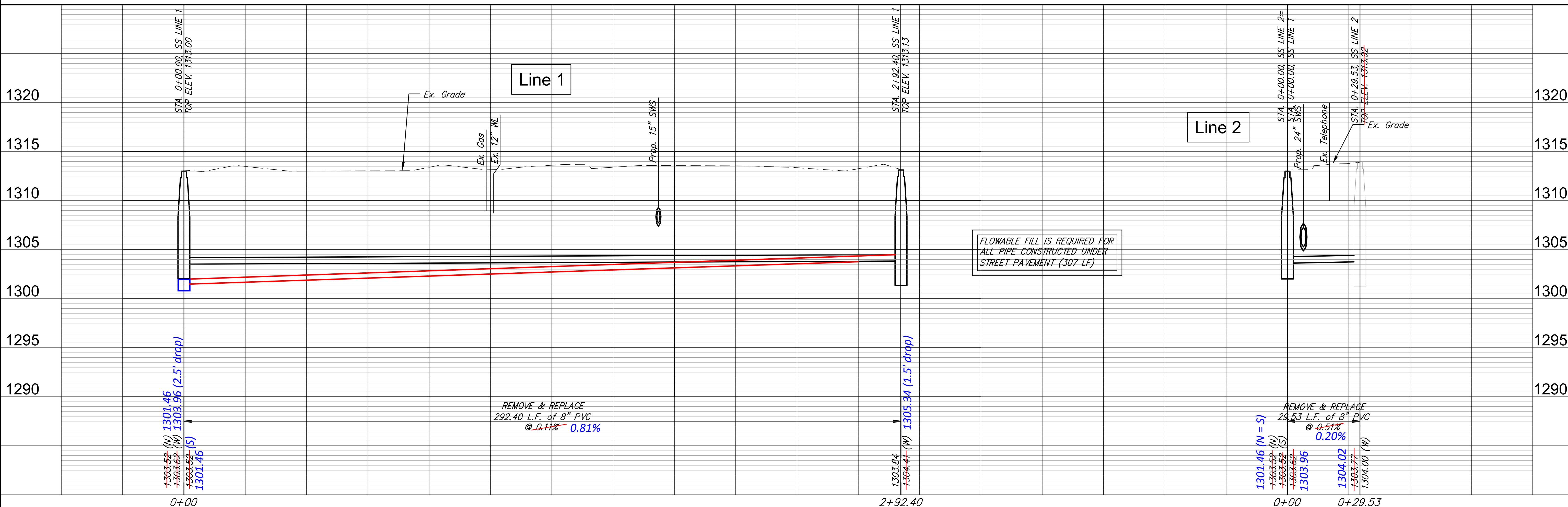

1303.52 (N) 1301.46
 1303.62 (W) 1303.96 (2.5' drop)
 1303.52 (S)
 1301.46

REMOVE & REPLACE
 292.40 L.F. of 8" PVC
 @ 0.11% 0.81%

1303.84
 1304.44 (W) 1305.34 (1.5' drop)

FLOWABLE FILL IS REQUIRED FOR ALL PIPE CONSTRUCTED UNDER STREET PAVEMENT (307 LF)

1301.46 (N = S)
 1303.52 (N)
 1303.52 (S)
 1303.62
 1303.96

REMOVE & REPLACE
 29.53 L.F. of 8" PVC
 @ 0.51% 0.20%

1304.02
 1303.77
 1304.00 (W)