

TRAFFIC SIGNAL HEAD SUMMARY			
SIGNAL	TYPE	MOUNTING	QUANTITY
4	A	TYPE I	2
8	A	TYPE I	2
2-6P	K	TYPE II	2

NOTE: ALL SIGNALS SHALL BE L.E.D.

#### SIGNAL FACE TYPES

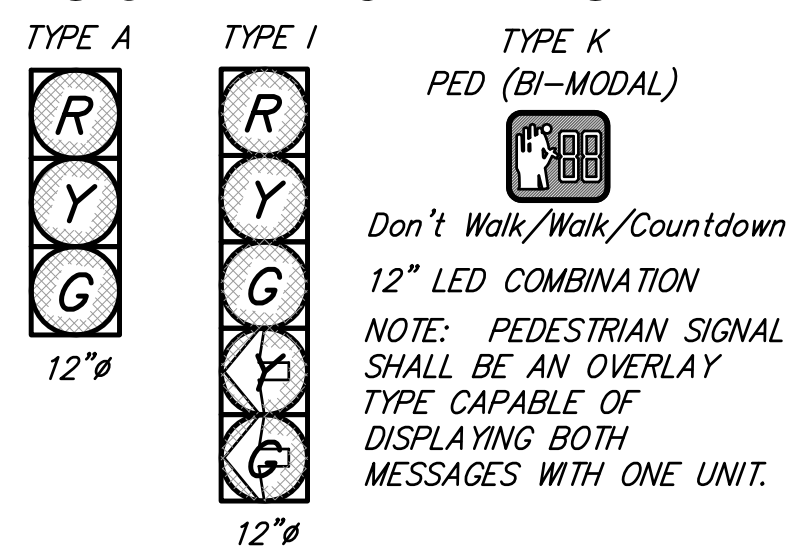

#### TRAFFIC SIGNAL NOTES

- SERVICE BOX LOCATIONS MAY BE FIELD ADJUSTED AT THE TIME OF INSTALLATION TO CLEAR OBSTRUCTIONS AND FACILITATE WIRING. ANY CHANGE IN LOCATION MUST BE APPROVED BY THE FIELD ENGINEER.
- CONTRACTOR SHALL COORDINATE INSTALLATION OF METER AND DISCONNECT WITH WESTAR.
- CONTRACTOR SHALL CONFIRM REMOVAL OF OLD ELECTRIC SERVICE.

24TH ST N

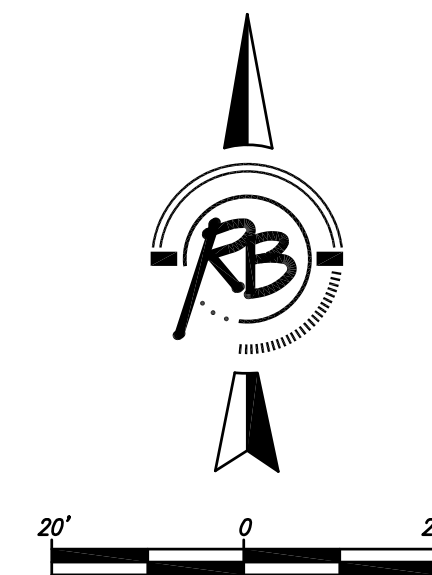
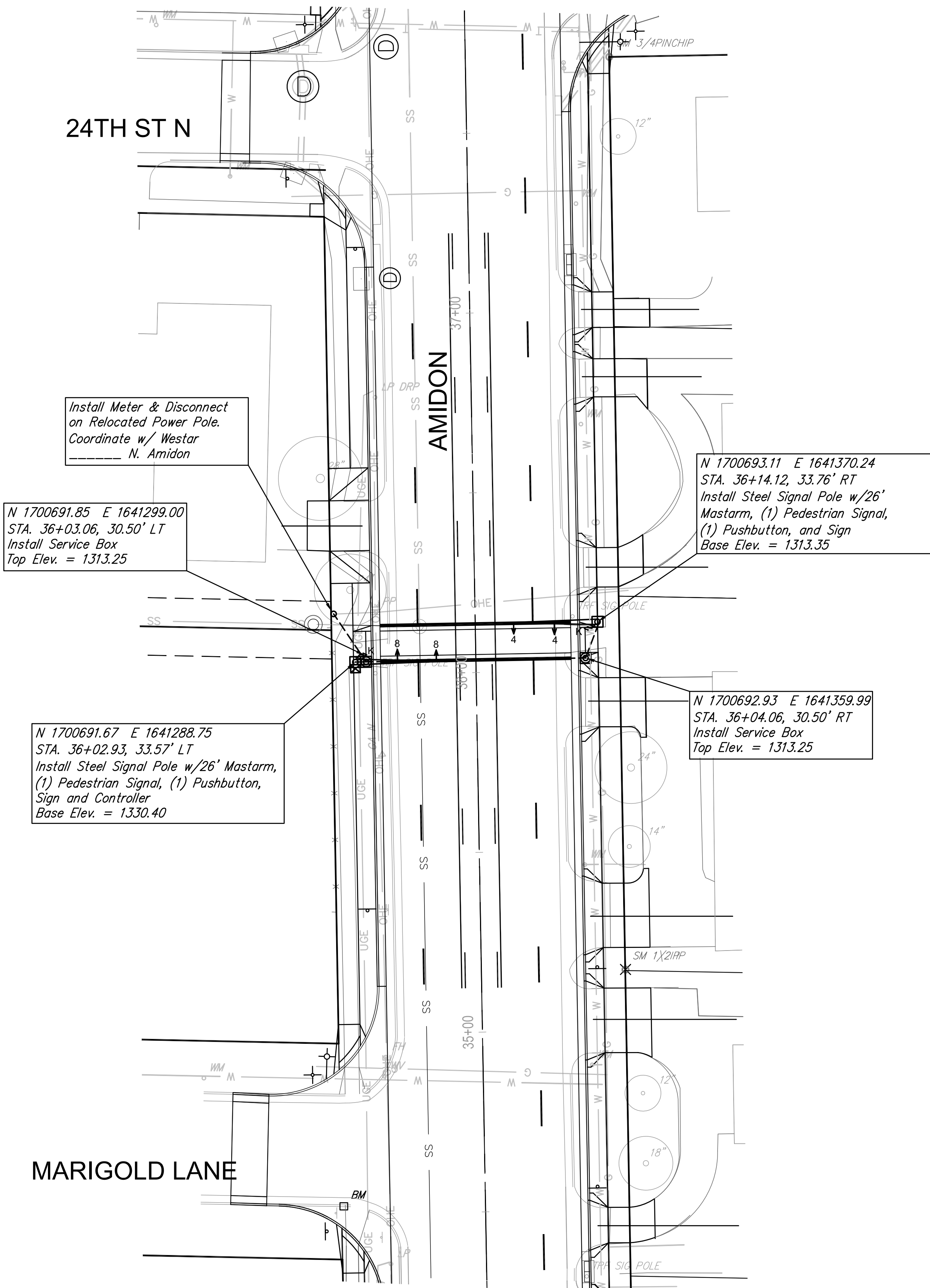

TRAFFIC SIGNAL POLE SUMMARY					
STATION	TYPE	ARM LENGTH (LF)	SIGNALS ON ARM	OTHER EQUIP. ON ARM	SIGNALS ON POLE
36+02.93 Lt	STEEL	26	(2) A	N/A	(1) K
36+14.12 Rt	STEEL	26	(2) A	N/A	(1) K

#### LEGEND

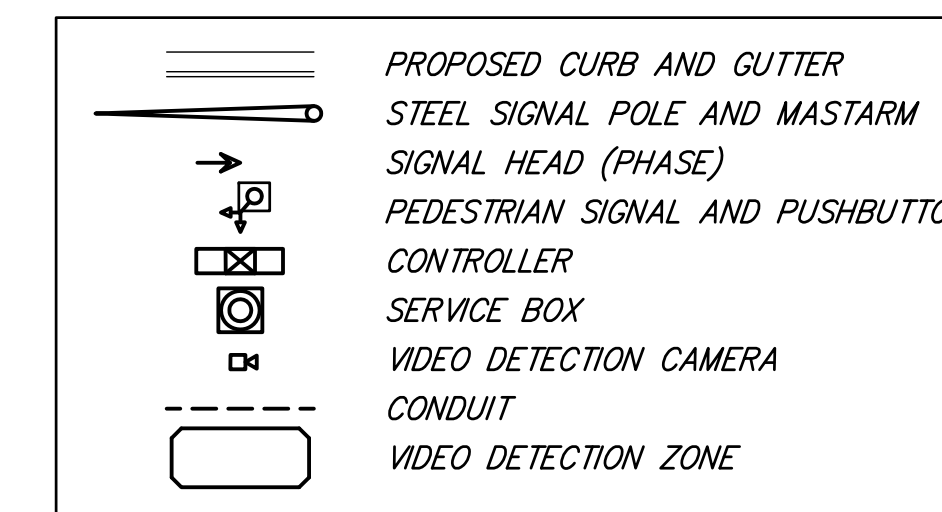

### AMIDON - 21ST TO 29TH PAVING IMPROVEMENTS CROSSWALK SIGNAL WIRING PLAN

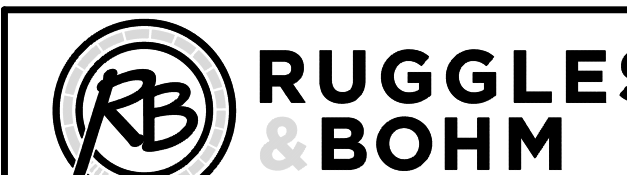

ENGINEERING | SURVEYING | LANDSCAPE ARCHITECTURE | GOVERNMENT  
924 NORTH MAIN WICHITA, KANSAS 67203 P (316) 264-8008 F (316) 264-4621 WWW.RBKANSAS.COM

PROJECT NUMBER 472-84914 RB JOB NO. 3647T DWG. SCALE 1" = 10'

DRAWING FILE TRAFFIC SIGNAL PLANS {CROSSWALK PLAN}

DATE Oct. 22, 2014  
DESIGN KWL  
DRAWN KWL  
REVIEW  
SHEET 68 OF 133