

NOTES:

ARROWS INDICATED ON THIS SHEET ARE FOR LANE MOVEMENT ONLY. NO ARROWS ARE REQUIRED FOR TEMPORARY TRAFFIC CONTROL. LANE TRANSITIONS INDICATED ON THIS SHEET ARE SCHEMATIC. LANE TRANSITIONS SHALL BE IMPLEMENTED IN ACCORDANCE WITH THE DETAILS ON SHEET 37.

CONTRACTOR TO ADJUST TRAFFIC CONTROL AS NECESSARY TO PROVIDE AT LEAST ONE LANE OF ACCESS TO DRIVEWAYS AND ALLEYS UNLESS OTHERWISE INDICATED IN THE CONSTRUCTION PHASING TABLE.

TRAFFIC CONTROL FOR MILLING AND JOINT REPAIR AREAS WILL BE IMPLEMENTED ONLY IN AREAS WHERE ACTUAL JOINT REPAIR AND OTHER OPERATIONS ARE BEING PERFORMED. THE TRAFFIC CONTROL SHALL COMPLY WITH THE DETAIL ON THE TRAFFIC CONTROL GENERAL NOTES SHEET. THE CONTRACTOR SHALL COORDINATE THEIR OPERATIONS TO ENSURE THAT INTERRUPTION OF LOCAL TRAFFIC TO BUSINESSES IS MINIMIZED.

NO MORE THAN TWO CONSECUTIVE STREETS MAY BE CLOSED AT THE SAME TIME.

SEQUENTIAL FLASHING ARROW PANEL SHALL BE USED FOR WESTBOUND TRAFFIC IN ALL PHASES.

Taper Formula

$L = WS$ FOR SPEEDS OF 45 MPH OR MORE

$L = WS^2/60$ FOR SPEEDS OF 40 MPH OR LESS

WHERE:
 L = MINIMUM LENGTH OF TAPER IN FEET
 S = NUMERICAL VALUE OF POSTED SPEED PRIOR TO WORK IN MPH
 W = WIDTH OF OFFSET IN FEET

Legend

- Type III Barricade
- Type B Warning Light
- Reflective Drums
- ▲ Sign
- Traffic Flow

ADVANCE WARNING SIGNS PLACED AT FIRST INTERSECTION FROM CENTRAL (NORTH OR SOUTH). INSTALL W20-3 OR W20-1 AS APPLICABLE.

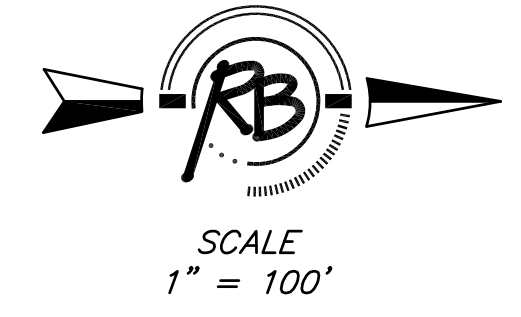
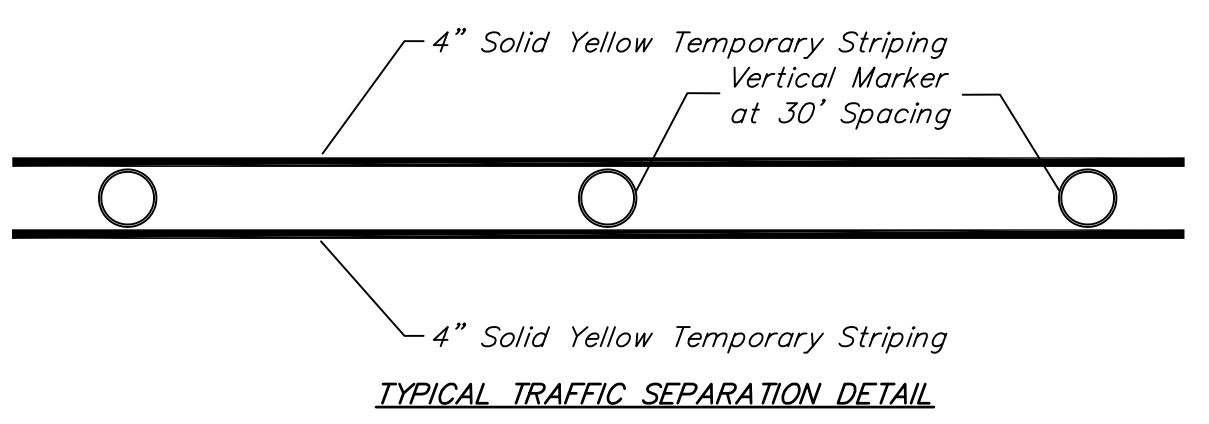

CONSTRUCTION PHASING				
PHASE 6				
AMIDON - 21ST TO 29TH PAVING IMPROVEMENTS				
	RUGGLES & BOHM		DATE Oct. 23, 2014	
	<small>ENGINEERING SURVEYING LANDSCAPE ARCHITECTURE GOVERNMENT</small> <small>924 NORTH MAIN WICHITA, KANSAS 67208 P (316) 264-8008 F (316) 264-4621</small> <small>WWW.RBKANSAS.COM</small>		DESIGN KWL	
	PROJECT NUMBER 472-84914	RB JOB NO. 36471	DWG. SCALE 20	DRAWN NK/DGZ
	DRAWING FILE Construction Phasing [phase 6]			REVIEW
			SHEET 95 OF 133	