

Install 6" Temp. AC Pavement on 5" Crushed Rock Base in area of median to be removed.

NOTES: MEDIAN SHALL BE REMOVED AND REPLACED AS NECESSARY TO ALLOW CONSTRUCTION OF INTERSECTION IMPROVEMENTS. COST SHALL BE SUBSIDIARY TO THE BID ITEM FOR "AC TEMP PAVEMENT"

"NO LEFT TURN" NOTE:
R3-2 (NO LEFT TURN) SIGNS SHALL BE MOUNTED ON MAST ARMS BETWEEN SIGNAL HEADS WHEN POSSIBLE. IF MAST ARM MOUNTING IS NOT POSSIBLE, SIGNS SHALL BE INSTALLED ON FAR LEFT CORNERS FOR ALL DIRECTIONS AND FOR ALL PHASES.

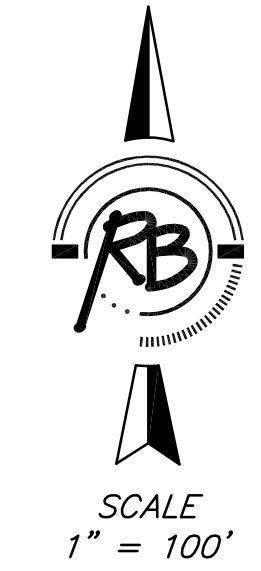
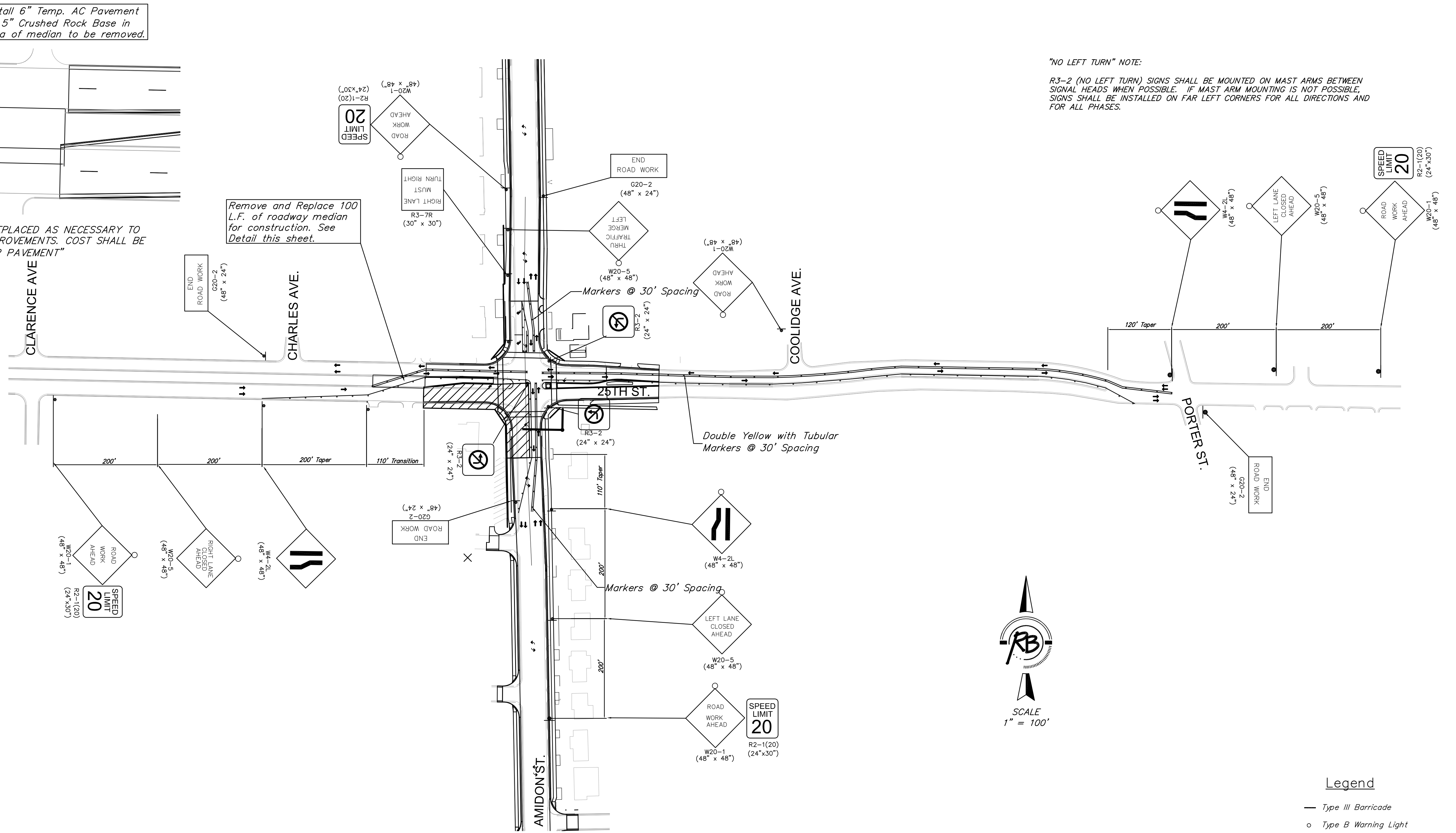

NOTES:
ARROWS INDICATED ON THIS SHEET ARE FOR LANE MOVEMENT ONLY. NO ARROWS ARE REQUIRED FOR TEMPORARY TRAFFIC CONTROL. LANE TRANSITIONS INDICATED ON THIS SHEET ARE SCHEMATIC. LANE TRANSITIONS SHALL BE IMPLEMENTED IN ACCORDANCE WITH THE DETAILS ON SHEET 73.

CONTRACTOR TO ADJUST TRAFFIC CONTROL AS NECESSARY TO PROVIDE AT LEAST ONE LANE OF ACCESS TO DRIVEWAYS AND ALLEYS UNLESS OTHERWISE INDICATED IN THE CONSTRUCTION PHASING TABLE.

R4-7 (KEEP RIGHT) SIGNS SHALL BE INSTALLED AT ALL FOUR CORNERS OF THE INTERSECTION BETWEEN THE OPPOSING LANES.

PHASE 1 OF THIS PROJECT SHALL BE CONSTRUCTED WITH PHASE II OF PROJECT 472-82786. FOR TRAFFIC CONTROL WEST OF STA. 4+03, SEE TRAFFIC CONTROL PLAN FOR PROJECT 472-82786.

SEQUENTIAL FLASHING ARROW PANEL SHALL BE USED FOR WESTBOUND TRAFFIC IN ALL PHASES.

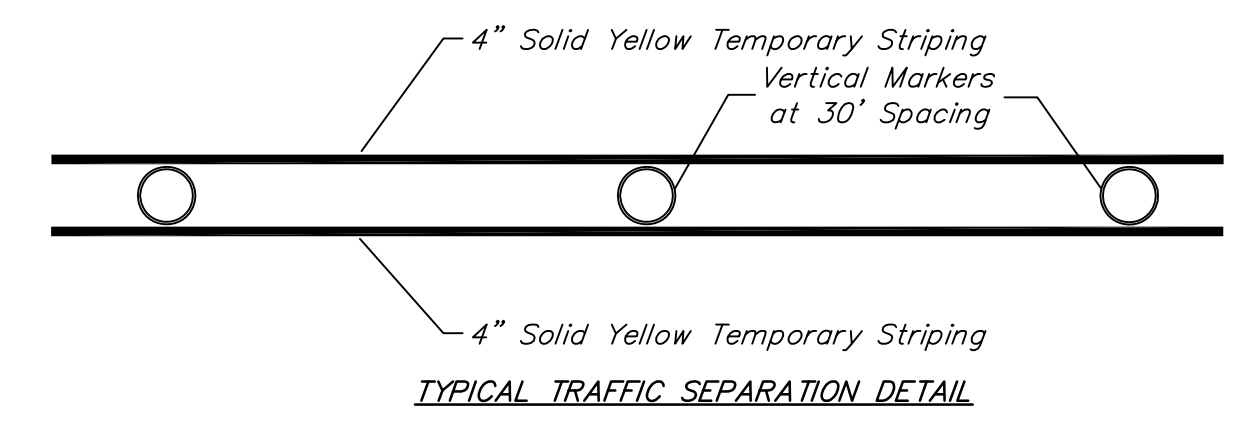

ADVANCE WARNING SIGNS PLACED AT FIRST INTERSECTION FROM CENTRAL (NORTH OR SOUTH). INSTALL W20-3 OR W20-1 AS APPLICABLE.

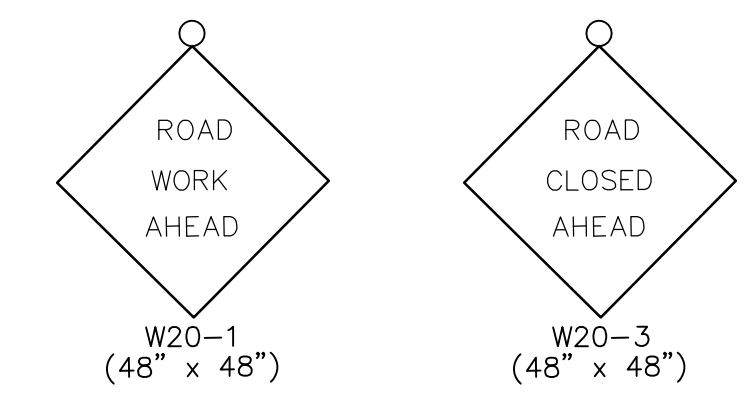

Taper Formula

$L = WS$ FOR SPEEDS OF 45 MPH OR MORE
 $L = WS^2/60$ FOR SPEEDS OF 40 MPH OR LESS
 WHERE:
 L = MINIMUM LENGTH OF TAPER IN FEET
 S = NUMERICAL VALUE OF POSTED SPEED PRIOR TO WORK IN MPH
 W = WIDTH OF OFFSET IN FEET

Legend

- Type III Barricade
- o Type B Warning Light
- Reflective Drums
- ▲ Sign
- ▬ Traffic Flow

CONSTRUCTION PHASING		DATE	Oct. 23, 2014
PHASE 7		DESIGN	KWL
AMIDON - 21ST TO 29TH PAVING IMPROVEMENTS		DRAWN	NK/DGZ
		REVIEW	
ENGINEERING SURVEYING LANDSCAPE ARCHITECTURE GOVERNMENT 924 NORTH MAIN WICHITA, KANSAS 67208 P (316) 264-8008 F (316) 264-4621 WWW.RB&B.COM		PROJECT NUMBER	472-84914
RB JOB NO.	36471	DWG. SCALE	20
DRAWING FILE		Construction Phasing [phase 7]	
		SHEET	96
		OF 133	