

AMIDON - 36+00 to 42+00

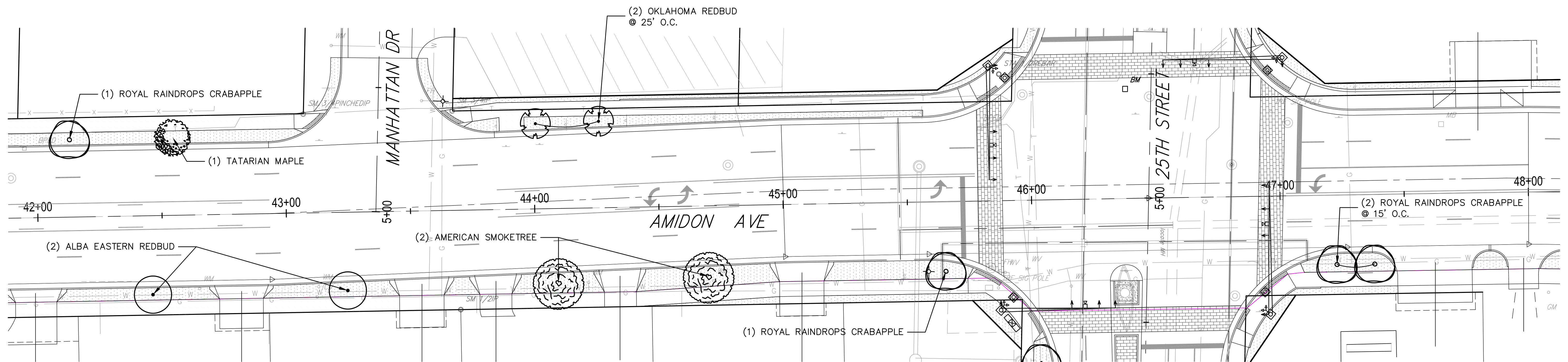

AMIDON - 42+00 to 48+00

LEGEND

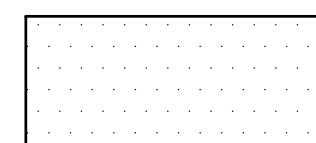

BERMUDA OR FESCUE SOD
Per Notes on Sheet 112 and
City of Wichita Specifications Section 900

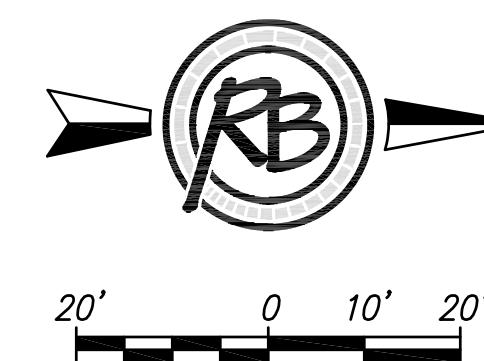

(c) Copyright 2014, Ruggles & Bohm, P.A.

AMIDON - 21ST TO 29TH LANDSCAPE IMPROVEMENTS AMIDON - 36+00 to 48+00 WICHITA, KANSAS			
			DATE October, 2014
	RUGGLES & BOHM <small>ENGINEERING SURVEYING LANDSCAPE ARCHITECTURE GOVERNMENT</small>		DESIGN DK
	<small>524 NORTH MAIN WICHITA, KANSAS 67203 P (316) 264-9008 F (316) 264-4621 WWW.RBKANSAS.COM</small>		DRAWN DK
	PROJECT NUMBER 472-84914	RB JOB NO. 3647T	DWG. SCALE 1"=20'-0"
DRAWING FILE LANDSCAPE BASE {Amidon 3}			SHEET 106 OF 133