

GENERAL NOTES

- UNLESS SHOWN OR STATED OTHERWISE ON THESE DRAWINGS, MATERIALS AND CONSTRUCTION SHALL BE IN ACCORDANCE WITH CITY OF WICHITA CONCRETE PAVEMENT AND ASPHALTIC CONCRETE PAVEMENT SPECIFICATIONS.
- CONTRACTOR WILL BE REQUIRED TO PROVIDE A MINIMUM ADVANCE NOTICE OF SEVENTY-TWO (72) HOURS TO UTILITY COMPANIES PRIOR TO STARTING ANY EXCAVATION AS FOLLOWS:
KANSAS ONE-CALL 1-800-344-7233
OR 687-2470 (LOCAL WICHITA)
- THE CONTRACTOR MUST NOTIFY THE FOLLOWING IN CASE OF AN EMERGENCY:
SBC (TELEPHONE) 800-870-8390
COX COMMUNICATIONS (CABLE) 262-0661
WESTAR (ELECTRIC) 383-8600
KANSAS GAS SERVICE (GAS) 832-3101
CITY OF WICHITA WATER & SEWER MAINT. 262-6000
KANEB PIPELINE 1-316-773-9000
- THE CONTRACTOR SHALL BE RESPONSIBLE FOR PRESERVING PROPERTY IRONS. THE CONTRACTOR WILL BE REQUIRED TO RE-ESTABLISH ANY PROPERTY IRONS WHICH ARE DAMAGED OR DESTROYED BY HIS CONSTRUCTION OPERATIONS. SUCH IRONS SHALL BE RE-ESTABLISHED BY A LICENSED LAND SURVEYOR IN ACCORDANCE WITH STATE LAWS.
- EXISTING UTILITIES AND THEIR LOCATIONS, AS SHOWN ON THE PLANS REPRESENT THE BEST INFORMATION OBTAINABLE FOR DESIGN. LOCATION INFORMATION HAS BEEN OBTAINED FROM THE VARIOUS UTILITY COMPANIES AND IS EITHER FROM COMPANY RECORD DRAWINGS OR COMPANY PROVIDED FIELD LOCATIONS. THE PLAN LOCATIONS SHOWN ARE NOT GUARANTEED. ADDITIONAL EXISTING UTILITIES MAY ALSO BE ENCOUNTERED.
- RUBBLE FROM THE REMOVAL OF MISCELLANEOUS STRUCTURES AND EXCESS EXCAVATION WHICH IS TO BE WASTED SHALL BE DISPOSED OF ON SITES TO BE PROVIDED BY THE CONTRACTOR. THESE SITES SHALL BE APPROVED BY THE ENGINEER AS TO SUITABILITY, APPEARANCE AND SITE LOCATION. LOCATIONS THAT, IN THE OPINION OF THE ENGINEER, WILL LEAVE AN UNSIGHTLY APPEARANCE WILL NOT BE APPROVED. ALL DISPOSAL SITES MUST BE APPROVED BY THE KANSAS DEPARTMENT OF HEALTH AND ENVIRONMENT. MATERIAL EITHER STOCKPILED OR DISPOSED OF IN A FLOOD PLAIN WOULD REQUIRE A KANSAS STATE BOARD OF AGRICULTURE PERMIT. ANY MATERIAL DUMPED IN WATERS OF THE UNITED STATES OR WETLANDS IS SUBJECT TO U.S. CORPS OF ENGINEERS PERMITTING REGULATIONS. ANY MATERIAL BURIED OR STOCKPILED BEYOND APPROVED CONSTRUCTION LIMITS WOULD REQUIRE ADDITIONAL ARCHAEOLOGICAL INVESTIGATIONS UNLESS BURIED IN A PREVIOUSLY APPROVED BORROW LOCATION.
- THIS PROJECT INCLUDES A CERTAIN AMOUNT OF ROLL TYPE CURB CONSTRUCTION. ROLL CURBS SHALL BE DEPRESSED THROUGH ALL DRIVEWAY OPENINGS WHEN SUCH DRIVES ARE CONSTRUCTED AS A PART OF THE PROJECT. NO MORE THAN 2 DRIVES 20 FEET IN WIDTH OR EQUIVALENT COMBINATIONS THEREOF ARE TO BE CONSTRUCTED WITH THIS PROJECT.
- TRANSITION CURB FROM FULL HEIGHT COMBINATION CURB AND GUTTER TO ROLL TYPE COMBINATION CURB AND GUTTER IS TO BE PAID AS BID FOR LINEAL FEET COMBINED CURB AND GUTTER (3 5/8" ROLL).
- A SAW CUT OF AT LEAST ONE-HALF THE DEPTH OF THE EXISTING SURFACE COURSES OR ONE-FOURTH THE DEPTH OF THE EXISTING TOTAL PAVEMENT THICKNESS SHALL BE PROVIDED AT LOCATIONS WHERE PROPOSED CONSTRUCTION ABUTS AN EXISTING SURFACE OR PAVEMENT FOR WHICH PARTIAL REMOVAL OF THAT SURFACE OR PAVEMENT IS REQUIRED. SAW JOINT TO FACILITATE REMOVAL WITHIN THREE (3) FEET OF EXISTING JOINTS WILL NOT BE PERMITTED AND FOR SUCH INSTANCES THE LIMITS OF REMOVAL SHALL EXTEND TO THE EXISTING JOINT. SUCH SAW CUTS WILL NOT BE PAID FOR DIRECTLY AND THIS COST SHALL BE CONSIDERED AS SUBSIDIARY TO THE REMOVAL OF SURFACE OR PAVEMENT.
- CONTRACTOR SHALL RESEED AND MULCH ALL DISTURBED AREAS. COST SHALL BE CONSIDERED SUBSIDIARY TO SITE RESTORATION.

LENGTH OF PROJECT	
PECKHAM	535 FT.
MAINSGATE CIR.	630 FT.

EARTHWORK SUMMARY*	
EXCAVATION	620 C.Y.
LOOSE FILL	3345 C.Y.
COMPACTED FILL	687 C.Y.

* FOR INFORMATION ONLY

PAVING STREETS AND INCIDENTAL DRAINAGE IN HAWTHORNE ADDITION

AN ADDITION TO THE CITY OF WICHITA
SEDGWICK COUNTY, KANSAS
PECKHAM "B" PHASE
PROJECT NO. 472-83638

NEIL D. CABLE, CITY ENGINEER
OCA 765829

Peckham from the North line of Project #472-83637 to
the East line of 127th Street East, Serving Lots 1-4,
BBlock 1, and Lots 1 & 15-18, Block 2; Mainsgate Circle,
serving Lots 2-14, Block 2



NW. Cor., SW 1/4, Sec. 2, T27S,
R2E, 6th P.M. Fnd. 3/4" Solid
Bar over stone.

NE. Cor., SW 1/4, Sec. 2, T27S,
R2E, 6th P.M. Fnd. 3/4" Bar W/
TTLs Brass Cap.

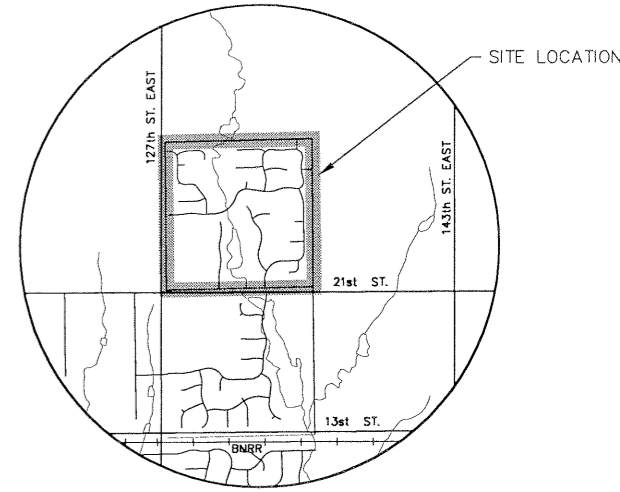

LOCATION MAP

INDEX TO DRAWINGS

SHEET NO.	DESCRIPTION
1	TITLE SHEET
2	TYP. PAVING SECTIONS
3	VALLEY GUTTER DETAILS
4	SIDEWALK DETAILS
5	SIGNING DETAILS
6	PECKHAM
7	MAINSGATE CIR.
8-10	INLET DETAILS
11	MANHOLE DETAILS
12	SWS LINE 1
13	SWS LINE 2
14	SWS LINES 3 & 4
15-16	GRADING PLANS
17-20	BMP DETAILS
21-27	CROSS SECTIONS
28-30	FINAL PLAT

BENCHMARKS

BM #1	"T" POST 1571'+/- N. & 50'+/- E. OF SW COR. 2-27S-2E, 5'+/- N. & 10'+/- W. OF SW COR. LOT 16, BLK 1. ELEV.=1371.52
BM #2	"T" POST 2172'+/- N. & 50'+/- E. OF SW COR. 2-27S-2E, 4'+/- N. & 10' +/- W. OF SW COR. LOT 3, BLK 1. ELEV.=1373.52
BM #3	"T" POST 5'+/- S. & 5'+/- W. OF NE COR. LOT 23, BLK 1. SW COR. PECKHAM CT. AND PECKHAM. ELEV.=1363.16

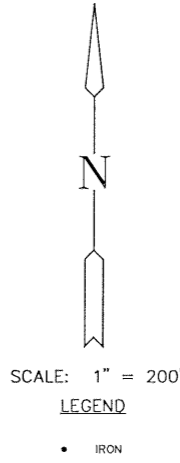

**HAWTHORNE ADDITION
PECKHAM "B" PHASE**
PROJECT NAME

TITLE SHEET
SHEET TITLE

DESIGN BY: BSH DRAWN BY: JAS CHECKED BY: ASH

DATE: JANUARY 2004 DRAWING NAME: 2167_ET SHEET / OF: 1 / 30

411 N. WEBB ROAD
WICHITA, KS. 67206
316 - 684 - 9600