

WATER VALVE BOX ELEVATIONS			
STREET	STATION	OFFSET	PROPOSED ELEVATION
BRISTLECONE CIR.	25+39.99	39.73' Rt.	174.7

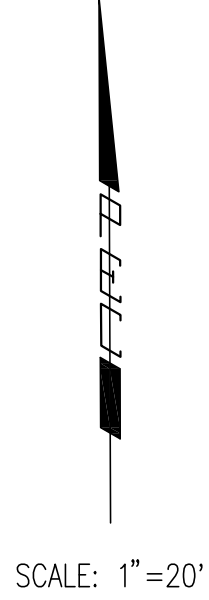

Sta. 25+44.01 @ Bristlecone Cir. =  
Ctr. of Cul-de-sac

Sta. 30+00.00 @ Bristlecone Cir. =  
Sta. 11+57.00 @ Parkdale

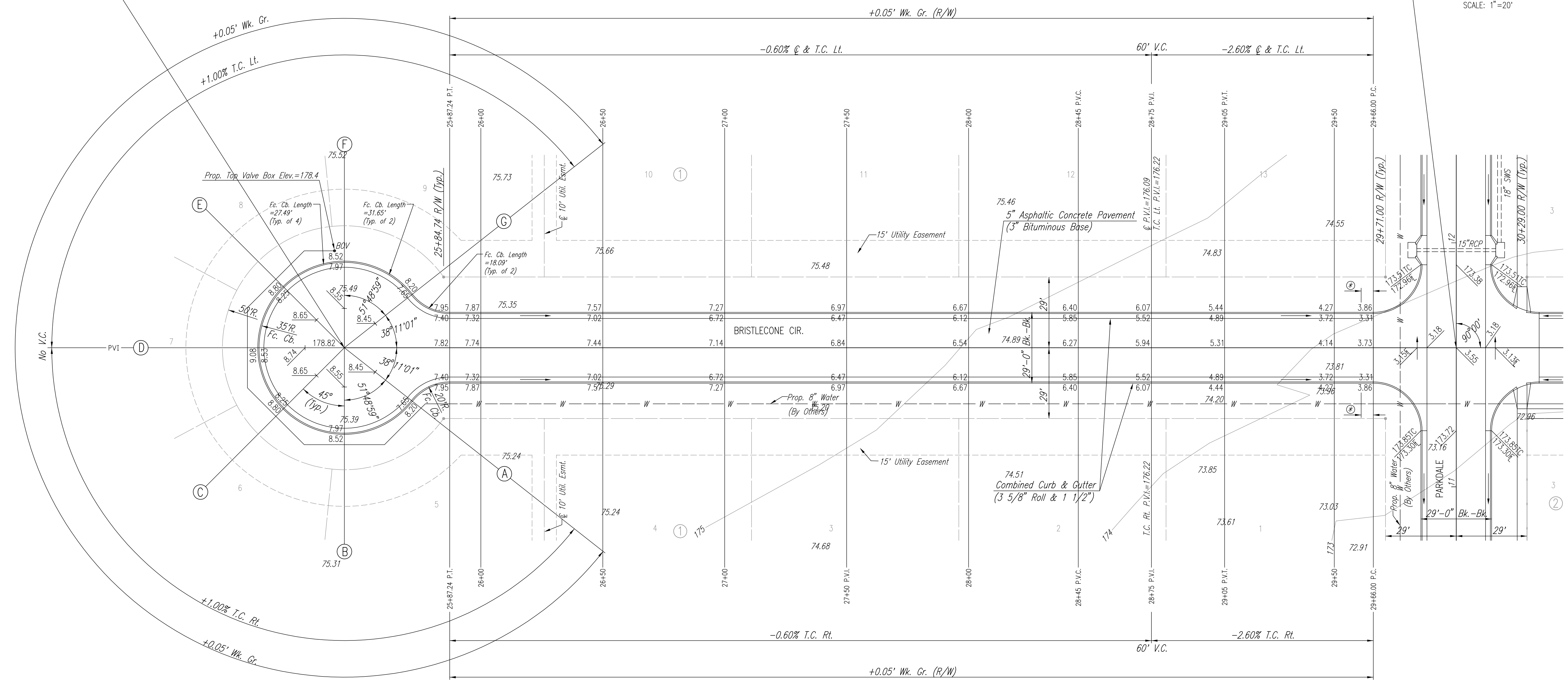

⊗ 5' TRANSITION FROM COMBINED CURB AND GUTTER (3 5/8" ROLL & 1 1/2") TO COMBINED CURB AND GUTTER (6 5/8" & 1 1/2"). TO BE BID AND PAID FOR AS "COMBINED CURB AND GUTTER (3 5/8" ROLL & 1 1/2)".

NOTE: THIS STREET TO BE CONSTRUCTED WITH ROLL-TYPE CURB. TOP OF CURB ELEVATIONS GIVEN ARE FOR FULL HEIGHT CURB.

DSNR: BDB OPER: BJS SCALE: 1"=20.00 03/2003\03123\000\STR25-30 02-04-2004 02:07:32 pm

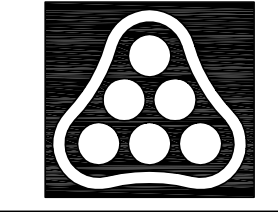

No.	Revision	By	Date
	EVERGREEN 4TH		
<b>BRISTLECONE CIRCLE</b> STA. 25+44.01 TO STA. 30+00			
JAMES L. ARMOUR, P.E. - ACTING CITY ENGINEER CITY OF WICHITA PROJECT NO. 472-83782			
<b>Professional Engineering Consultants, P.A.</b> 303 S. TOPEKA • WICHITA, KANSAS 67202 316-262-2691 • FAX 316-262-3003			
Designed by	BDB, BLB	Job No.	35-03123
Drawn by	BJS	Date	MARCH 2003
			Sht. 6 of 44