

BENCHMARKS:
 City Disc In T.C. Adj. to F.H. 38'
 South of intersection of Onewood
 and Auburn Hills.
 Elev. = 178.48 (City Datum)

"□" cut in south curb of Onewood
 272' west of C.L. Auburn Hills.
 Elev. = 179.73 (City Datum)

P.V.I.
 Elev. = 177.90
 No V.C.



Scale: 1" = 20'
 • = Iron

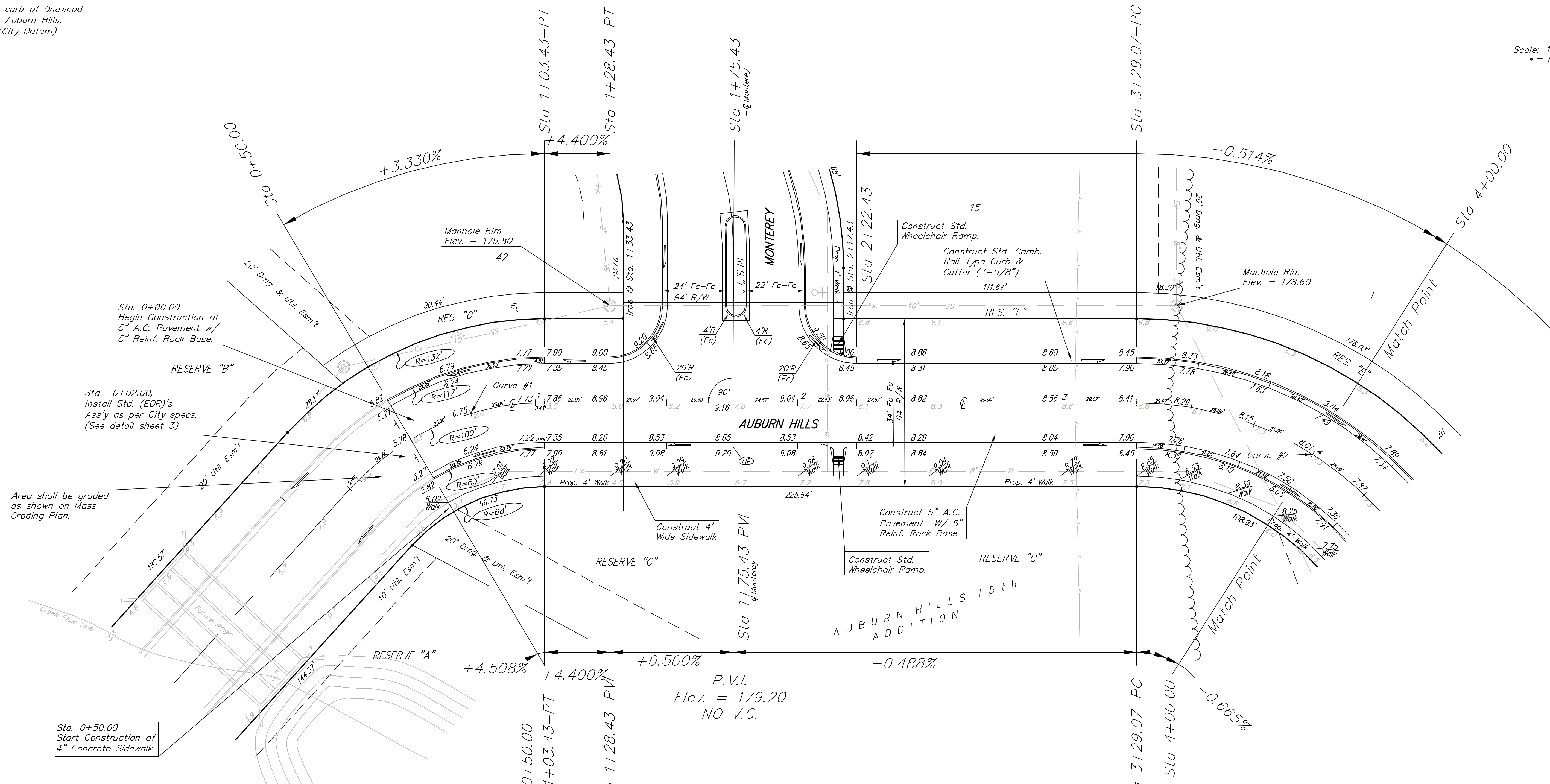

Area shall be graded
 as shown on Mass
 Grading Plan.

Sta. 0+00.00
 Begin Construction of
 5" A.C. Pavement w/
 5" Reinf. Rock Base.

Sta. -0+02.00,
 Install Std. (EOR)'s
 Ass'y as per City specs.
 (See detail sheet 3)

Sta. 0+50.00
 Start Construction of
 4" Concrete Sidewalk

Curve #1
 Curve Data Based on Centerline
 Rad. = 100' Delta = 47°48'5" Tangent = 44.32'
 Arc = 83.43' L.C. = 81.03' Def/Ft. = 17.18856 Min.

| Station | Arc | FACE CHORD LENGTHS | | Defl. | T. Defl. |
|---------|--------|--------------------|--------|----------|-----------|
| | | B' Lt. | B' Rt. | | |
| 0+20.00 | - | - | - | 0°00'00" | 0°00'00" |
| 0+25.00 | 5.00' | 6.25' | 3.75' | 1°25'57" | 1°25'57" |
| 0+50.00 | 25.00' | 31.17' | 18.70' | 7°09'43" | 8°35'39" |
| 0+75.00 | 25.00' | 31.17' | 18.70' | 7°09'43" | 15°45'22" |
| 1+00.00 | 25.00' | 31.17' | 18.70' | 7°09'43" | 22°55'05" |
| 1+03.43 | 3.43' | 4.29' | 2.57' | 0°58'57" | 23°54'02" |

P.V.I.
 Elev. = 179.20
 NO V.C.

P.V.I.
 Elev. = 177.90
 No V.C.

P.V.I.
 Elev. = 179.00
 46.57' V.C.

P.V.I.
 Elev. = 178.45
 NO V.C.

Curve #2
 Curve Data Based on Centerline
 Rad. = 125' Delta = 67°6'43" Tangent = 82.91'
 Arc = 146.42' L.C. = 138.19' Def/Ft. = 13.75057 Min.

| Station | Arc | FACE CHORD LENGTHS | | Defl. | T. Defl. |
|---------|--------|--------------------|--------|----------|-----------|
| | | B' Lt. | B' Rt. | | |
| 3+29.07 | - | - | - | 0°00'00" | 0°00'00" |
| 3+50.00 | 20.93' | 25.09' | 16.72' | 4°47'48" | 4°47'48" |
| 3+75.00 | 25.00' | 29.95' | 19.97' | 5°43'46" | 10°31'54" |
| 4+00.00 | 25.00' | 29.95' | 19.97' | 5°43'46" | 16°15'20" |
| 4+25.00 | 25.00' | 29.95' | 19.97' | 5°43'46" | 21°59'06" |
| 4+50.00 | 25.00' | 29.95' | 19.97' | 5°43'46" | 27°42'51" |
| 4+75.00 | 25.00' | 29.95' | 19.97' | 5°43'46" | 33°26'37" |
| 4+75.49 | 0.49' | 0.59' | 0.39' | 0°06'44" | 33°33'21" |

NOTE: ROLL TYPE CURB & GUTTER TO BE CONSTRUCTED ON THE PAVEMENT SHOWN ON THIS SHEET. TOP OF CURB ELEVATIONS ARE GIVEN FOR FULL HEIGHT CURB.

AUBURN HILLS 15th ADDITION
AUBURN HILLS
 STA 0+00.00 TO STA 4+02.28

BAUGHMAN COMPANY P.A.
 ENGINEERING, SURVEYING, & PLANNING

315-282-7271 • 315 ELLIS • WICHITA, KANSAS 67211

PROJECT NUMBER
472-83890

DESIGN NBW DRAW ATD APPROVED DATE 02/04 SCALE Noted

SHEET **7** OF **48**