

BENCHMARKS

BM #1:
 "□" Chiseled on Top of Curb.
 West End of South Median Curb
 within Castlewood
 Elevation = 1380.50 (NAVD 88)

BM #2
 "x" Chiseled on Back of Walk.
 Near the Southeast corner of
 Lot 2, Block A, The Waterfront
 7th Addition
 Elevation = 1381.88 (NAVD 88)

BM #3
 "□" Chiseled on Back of Walk.
 Northeast corner of parking lot
 within Lot 1, Block 1, The
 Waterfront 4th Addition
 Elevation = 1389.50 (NAVD 88)

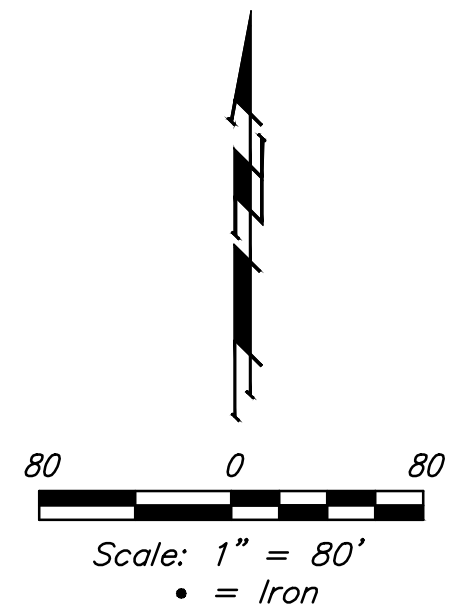
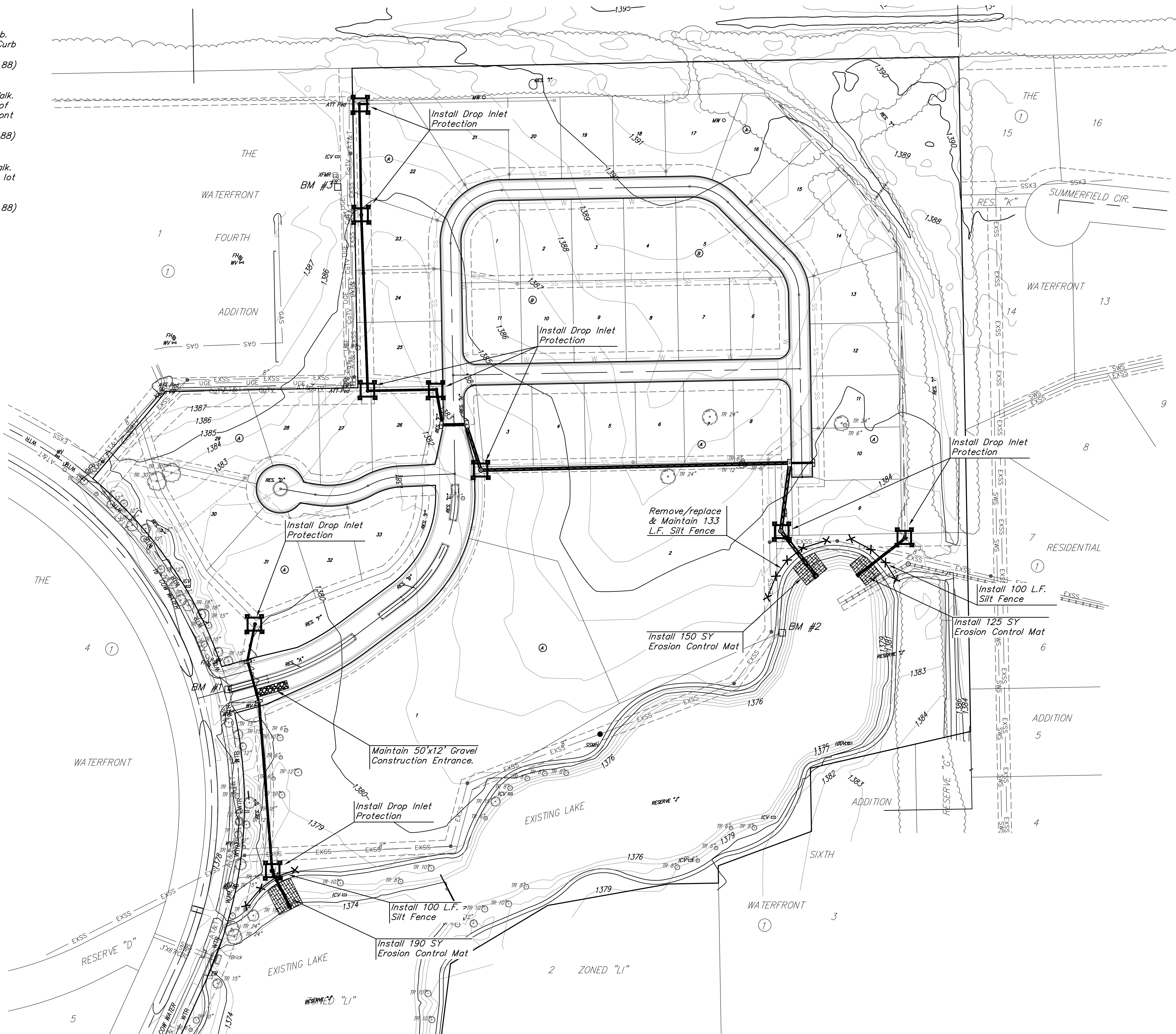

Existing Ground — 1364 —

NOTES:
 Contractor shall make sure all erosion control is in place before project is accepted. This plan represents the minimum standard. Any additional erosion control measures shall be installed by the Contractor as needed.
 All areas disturbed during construction shall be seeded, mulched, and fertilized as per Cover Sheet General Notes.

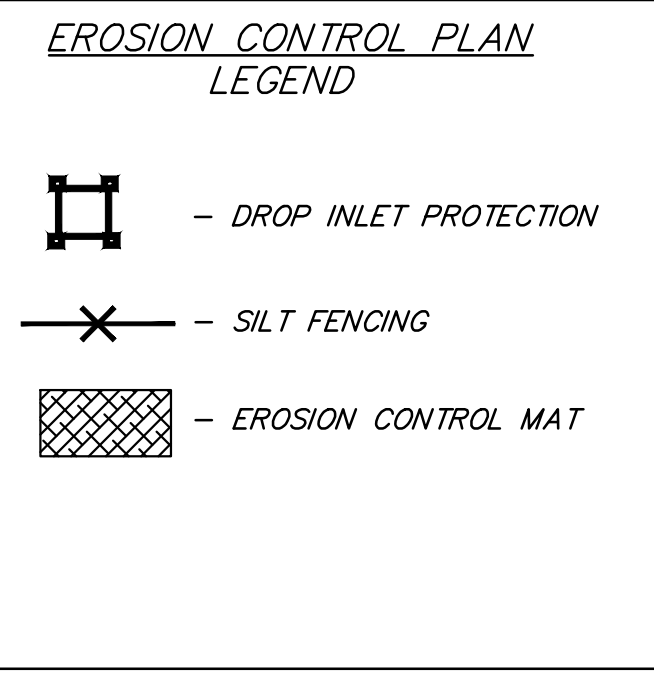
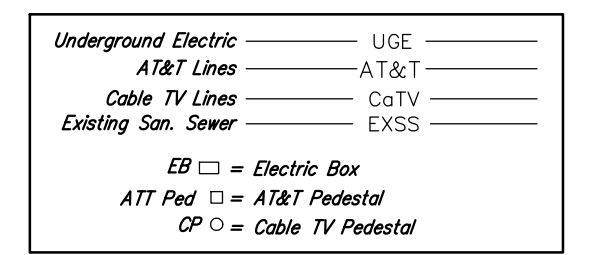

| EROSION CONTROL MEASURE | INSTALL | MAINTAIN | REMOVE |
|------------------------------|---------|----------|--------|
| BACK OF CURB PROTECTION (LF) | 0 | 0 | 0 |
| CONSTRUCTION ENTRANCE (EA) | 0 | 1 | 0 |
| CURB INLET BARRIER (EA) | 0 | 0 | 0 |
| DITCH CHECK (EA) | 0 | 0 | 0 |
| DROP INLET PROTECTION (EA) | 9 | 0 | 0 |
| EROSION CONTROL (LS) | 0 | 0 | 0 |
| EROSION CONTROL BERM (LF) | 0 | 0 | 0 |
| SILT FENCE (LF) | 200 | 133 | 0 |
| EROSION CONTROL MAT (SY) | 465 | 0 | 0 |

Quantities are for information only! contractor shall verify quantities per final bid quantity sheet.
 * All existing BMPs including Construction Entrance, Sediment Barriers, Silt Fence, Cut-off Trench, and Erosion Control Mat shall be maintained and repaired if necessary. Replacement or removal of erosion control measures to be paid for by L.S. Bid item "Maintain Existing Erosion Control BMPs"

Baughman

ENGINEERING | SURVEYING | PLANNING | LANDSCAPE ARCHITECTURE

The Waterfront 7th Addition
EROSION CONTROL & DITCH GRADING
 Stormwater Sewer Improvements

| | | | |
|-----------------------------|--|----------------|-----------------|
| PROJECT NUMBER 468-85004 | | DESIGN AEG | DRAWN JAK |
| REVISIONS: | | APPROVED | DATE 1/12/15 |
| | | SCALE Noted | SHEET |

8 OF 21