

P.T. @ K-96 Sta. 790+3.65
 3/4" Rebar
 I. No References

P.I. @ Ramp E-NS Sta. 812+10.52-
 @ Hoover Rd. Sta. 129+55.42
 I. Not Set

P.C. @ Ramp E-NS Sta. 822+43.06
 I. Not Set

P.I. @ Ramp E-NS Sta. 824+18.63 (Bk.)-
 P.I. @ Ramp E-NS Sta. 824+18.30 (Ahd.)
 I. Not Set

NE 1/4 Sec. 27, T26S, RIW

NW 1/4 Sec. 26, T26S, RIW

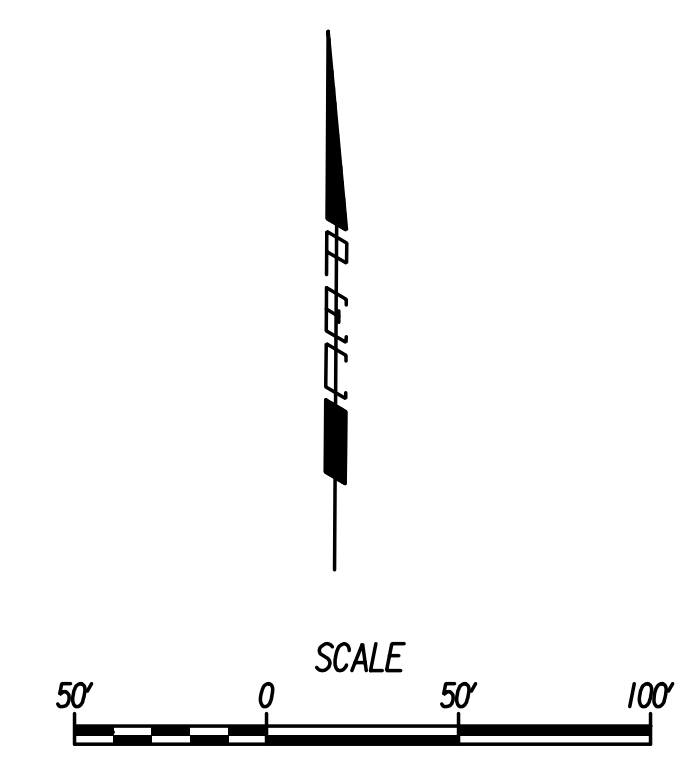

Sta. 812+10.52 @ Ramp E-NS-
 Sta. 129+55.42 @ Hoover Rd.

See Sh. No. 43 for
 Intersection Details

Sta. 813+69 to Sta. 825+57
 Abandon in place approx 1212 LF
 16" Poly Gas Pipe Line.
 Cut, cap and fill per
 Standard City of Wichita Specifications

D-757-UP
 City of Wichita

Sta. 816+00 Install
 38" x 24" x 60" CRP (RCPHE)
 with End Sections
 See Sh. No. 59, 66

Sta. 821+98 Extend
 36" x 223' CRP (RCP) with
 36" x 29' CRP (RCP) Lt.
 with End Section
 See Sh. No. 58, 66

Ramp E-NS Curve Data
 P.I. Sta. 824+18.63 (Bk.)-
 P.I. Sta. 824+18.30 (Ahd.)
 Δ=6°05'27" Lt.
 R=3,300.00'
 T=175.57'
 L=350.81'
 E=4.67'
 SE=4.0%

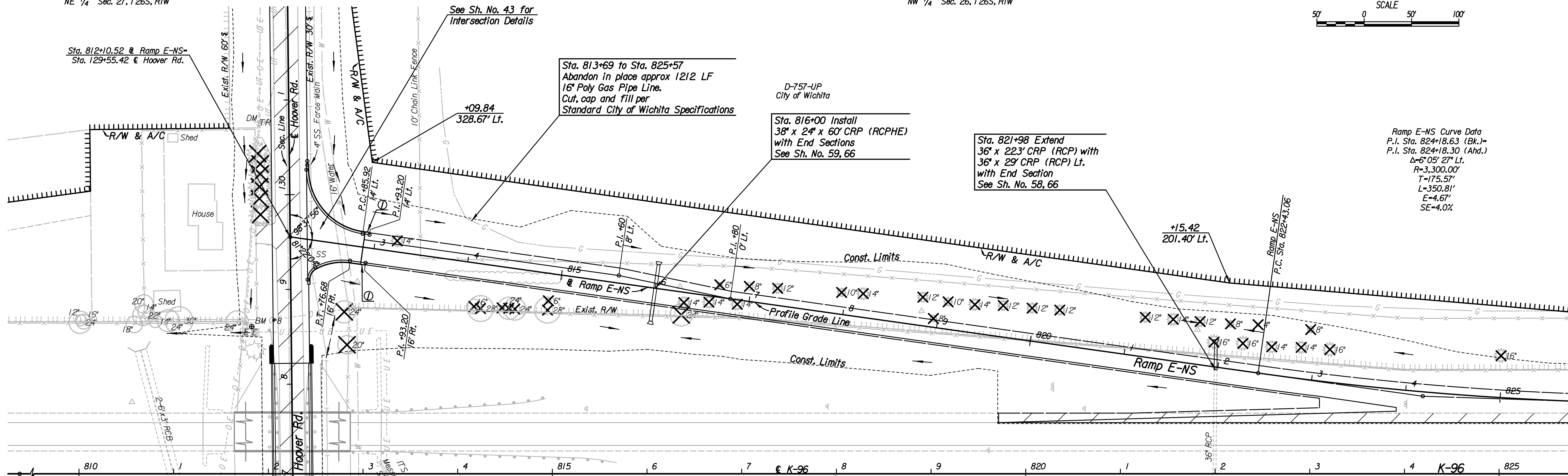

X Denotes trees to be removed
 Paid for as 'Site Clearing'.

LEGEND

- Pavement Removal
- 5' Transition from Combined Curb & Gutter (Type 1) to no curb.

REMOVAL OF EXISTING STRUCTURES *		
STATION	SIDE	ITEM
812+83	Rt.	1207 LF Barbed Wire Fence (E)
813+50	Lt.	1130 LF Chain Link Fence (E)
821+98	Lt.	36" End Section (RCP)

* For Information Only

- Utilities
- Gas: Wichita Gas Producers
 - Power: Westar Energy
 - Sanitary Sewer: Wichita Water Utilities
 - Telephone: AT&T, Wichita Central Unit
 - Water: Wichita Water Utilities

Datum Benchmark:
 BM #8 COW Disk at North R/W of K-96 Highway and West R/W of Hoover Rd., 6.90' ESE of powerpole, 18.40' West of North guard rail post, 10' SE of barb wire fence post
 155' Lt. @ K-96 Sta. 811+82
 Elev.=1333.53 (NAVD88)

Plotted By: drp Date: 1/19/2015 8:52:14 AM
 FILE: I:\2008\08807\001\Plan\08807-001\Plan Sta 810 K96 and Ramp E-NS.dgn

K-96 RAMP E-NS	
PLAN	
STA. 812+10.52 TO STA. 825+00	
GARY JANZEN, P.E.-CITY ENGINEER CITY OF WICHITA PROJECT NO. 472-84780	
PROFESSIONAL ENGINEERING CONSULTANTS, P.A. 303 SOUTH TOPEKA WICHITA, KS 67202 316-262-2691 www.pec1.com	
Designed by: JPS	Job No.: 08807-001
Drawn by: SVB	Date: Jan., 2015
Sht. 24 of 227	