

COORDINATE TABLE					
POINT NO.	NORTH COORDINATE	EAST COORDINATE	STATION	OFFSET	DESCRIPTION
4004	1,710,816.6732	1,628,142.0426	111+27.00	13.00 Lt.	Edge of Pvmnt / Match Point
4005	1,710,817.1308	1,628,168.0385	111+27.00	13.00 Rt.	Edge of Pvmnt / Match Point
4006	1,710,889.5935	1,628,140.7590	111+99.93	13.00 Lt.	P.I. Edge of Pvmnt
4007	1,710,889.9713	1,628,166.7563	111+99.85	13.00 Rt.	P.I. Edge of Pvmnt
4008	1,711,249.4339	1,628,130.6322	115+59.78	19.00 Lt.	P.I. Edge of Pvmnt
4009	1,711,249.9836	1,628,168.6284	115+59.90	19.00 Rt.	P.I. Edge of Pvmnt
4010	1,711,697.9877	1,628,160.8022	120+07.86	19.00 Rt.	P.I. Edge of Pvmnt / End of Curb
4011	1,711,697.9703	1,628,159.8024	120+07.86	18.00 Rt.	P.I. Edge of Pvmnt / H.E. of Curb
4012	1,711,879.9425	1,628,156.6235	121+89.86	18.00 Rt.	P.I. Edge of Pvmnt / H.E. of Curb
4013	1,711,879.9600	1,628,157.6234	121+89.86	19.00 Rt.	P.I. Edge of Pvmnt / End of Curb

CONTROL POINTS					
POINT NO.	NORTH COORDINATE	EAST COORDINATE	STATION	OFFSET	DESCRIPTION
1	1,709,690.0766	1,628,174.8758	100+00.00	0.00 Lt.	SE Cor. Sec. 27 - 5/8" Capped Rebar
104	1,707,051.4176	1,628,232.3540			E 1/4 Cor. Sec. 34 - 1/2" Rebar
302	1,709,693.8179	1,628,174.8099	100+03.74	0.00 Lt.	€ Intersection of 37th St. & Hoover Rd.
400	1,709,690.0766	1,628,174.8758	100+00.00	0.00 Lt.	€ of Hoover Rd. = Section Cor.
401	1,710,889.8907	1,628,153.7557	112+00.00	0.00 Lt.	P.I. € of Hoover Rd. = Section Line
402	1,711,249.8671	1,628,149.6276	115+60.00	0.00 Lt.	P.I. € of Hoover Rd.
500	1,711,783.6427	1,628,140.3030	120+93.86	0.00 Lt.	€ Intersection of Hoover Rd. & Ramp NS-E

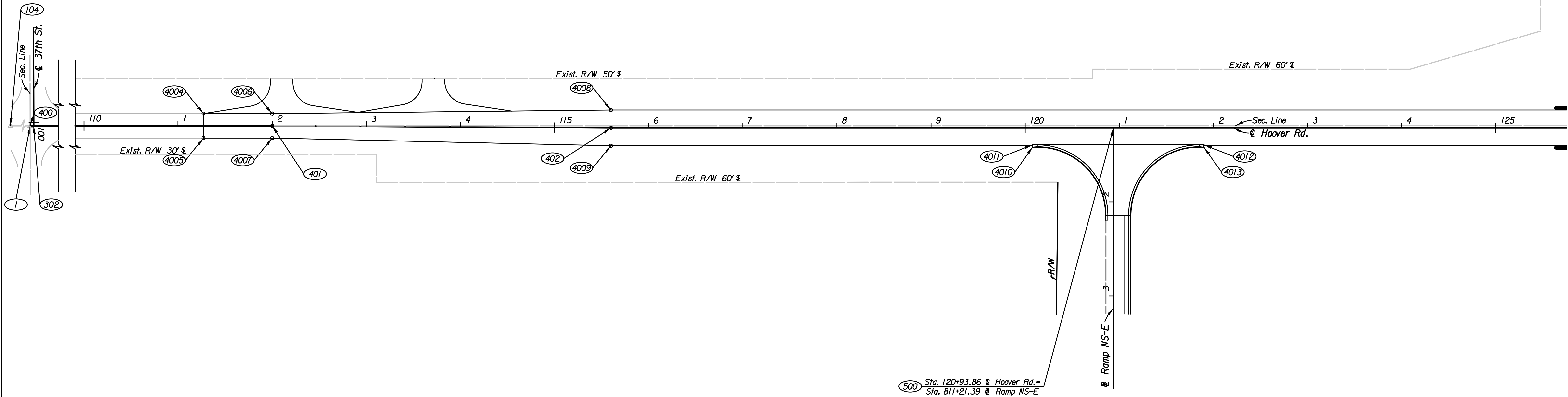

Plotted By: drp Date: 1/20/2015 7:30:47 AM  
 FILE: I:\2008\08807\001\C060\08807-001\C060 Sta 110 Hoover.dgn

No.	Revision	By	Date

**HOOVER ROAD**  
**COORDINATE GEOMETRY PLAN**  
**STA. 110+00 TO STA. 125+00**  
 GARY JANZEN, P.E.-CITY ENGINEER  
 CITY OF WICHITA PROJECT NO. 472-84780

**PEC** PROFESSIONAL ENGINEERING CONSULTANTS, P.A.  
 303 SOUTH TOPEKA WICHITA, KS 67202  
 316-262-2691 www.pec1.com

Designed by	JPS	Job No.	08807-001	Sht. 30 of 227
Drawn by	SVB	Date	Jan., 2015	