

CONTROL POINTS					
POINT NO.	NORTH COORDINATE	EAST COORDINATE	STATION	OFFSET	DESCRIPTION
2	1,712,311.0390	1,628,128.7396	126+21.37	2.35 Lt.	E 1/4 Cor. Sec. 27 - 5/8" Capped Rebar
3	1,714,644.5168	1,628,087.9761	149+55.22	0.00 Lt.	P.I. of Hoover Rd. - #4 Capped Rebar
5	1,712,261.4458	1,625,521.4773	126+17.33	2,610.08 Lt.	Ctr. Cor. Sec. 27 - Conc. Nail in ctr of 0.5 x 1.0 limestone
450	1,712,395.1141	1,628,129.6213	812+25.81	0.00 Lt.	of Intersection of Hoover Rd. & K-96
600	1,712,645.0760	1,628,125.2547	812+10.52	0.00 Lt.	of Intersection of Hoover Rd. & Ramp E-NS

COORDINATE TABLE					
POINT NO.	NORTH COORDINATE	EAST COORDINATE	STATION	OFFSET	DESCRIPTION
4036	1,712,642.6894	1,628,203.3089	812+88.20	8.00 Lt.	Edge of Pvmt
4037	1,712,647.9723	1,628,209.0614	812+93.20	14.00 Lt.	P.I. Edge of Pvmt / H.E. of Curb
4038	1,712,649.9546	1,628,209.3270	812+93.20	16.00 Lt.	P.I. Edge of Shldr / End of Curb
4039	1,712,618.2380	1,628,205.0775	812+93.20	16.00 Rt.	P.I. Edge of Pvmt / H.E. of Curb
4040	1,712,616.2557	1,628,204.8119	812+93.20	18.00 Rt.	P.I. Edge of Shldr / End of Curb
4041	1,712,606.5954	1,628,472.6986	815+60.00	8.00 Lt.	P.I. Edge of Pvmt
4042	1,712,614.5245	1,628,473.7610	815+60.00	16.00 Lt.	P.I. Edge of Shldr
4043	1,712,582.7305	1,628,590.5734	816+80.00	0.00 Lt.	P.I. Edge of Pvmt / of Ramp E-NS
4044	1,712,590.6596	1,628,591.6358	816+80.00	8.00 Lt.	P.I. Edge of Shldr
4045	1,712,481.7744	1,629,213.5053	823+10.46	18.03 Rt.	Edge of Shldr / Gore
4046	1,712,471.7746	1,629,213.5696	823+10.23	69.68 Lt.	Edge of Shldr / Gore
4047	1,712,472.6132	1,629,294.7245	823+91.73	19.00 Rt.	Edge of Pvmt / Gore
4048	1,712,468.6133	1,629,294.7502	823+91.39	66.00 Lt.	Edge of Pvmt / Gore
4049	1,712,464.8110	1,629,014.6832	821+11.30	64.00 Lt.	P.I. Edge of Shldr
4050	1,712,463.9106	1,628,874.7718	819+71.39	64.00 Lt.	Edge of Shldr / Match Point
4051	1,712,453.9109	1,628,874.8361	819+71.39	54.00 Lt.	Edge of Pvmt / Match Point

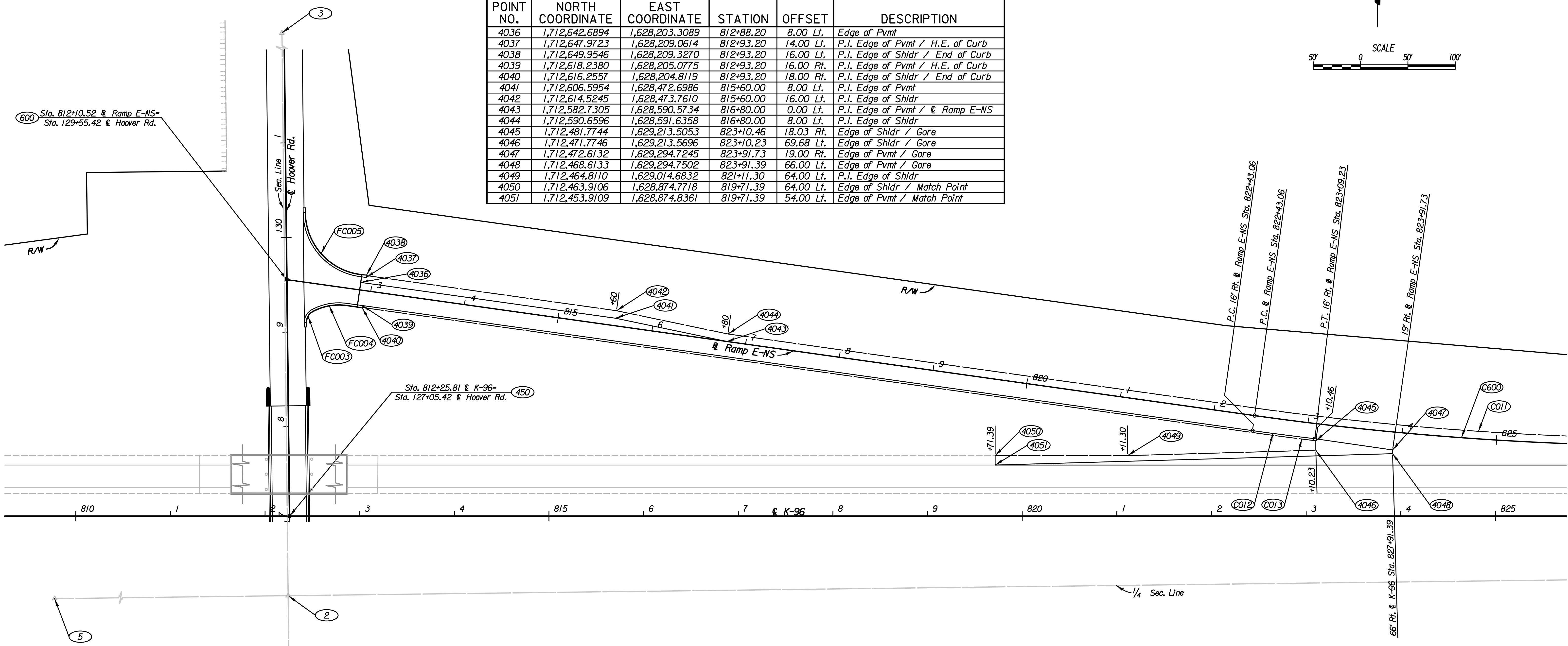
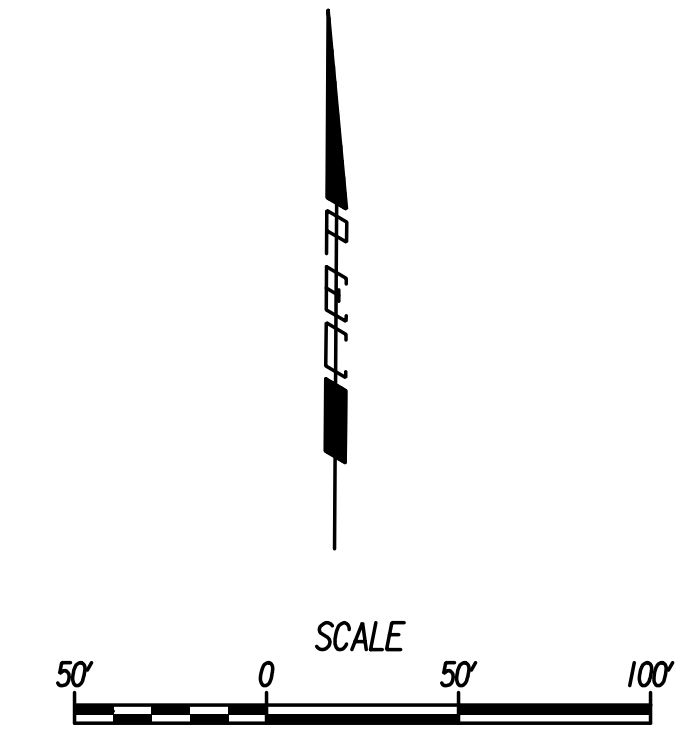

CURVE DATA													
NO.	Δ	R	T	L	E	P.C. COORDINATES		P.I. COORDINATES		P.T. COORDINATES		C.C. COORDINATES	
						NORTH	EAST	NORTH	EAST	NORTH	EAST	NORTH	EAST
C011	06° 05' 27"	3,292.00	175.14	349.96	4.66	1,712,515.8866	1,629,149.7080	1,712,492.6279	1,629,323.3003	1,712,487.9196	1,629,498.3805	1,715,778.7299	1,629,586.8783
C012	01° 08' 56"	3,316.00	33.25	66.49	0.17	1,712,492.0992	1,629,146.5209	1,712,487.6839	1,629,179.4746	1,712,483.9303	1,629,212.5102	1,715,778.7299	1,629,586.8783
C013	01° 08' 55"	3,318.00	33.26	66.51	0.17	1,712,490.1169	1,629,146.2553	1,712,485.7005	1,629,179.2171	1,712,481.9457	1,629,212.2609	1,715,778.7299	1,629,586.8783
C600	06° 05' 27"	3,300.00	175.57	350.81	4.67	1,712,507.9575	1,629,148.6456	1,712,484.6423	1,629,322.6598	1,712,479.9225	1,629,498.1655	1,715,778.7299	1,629,586.8783
FC003	62° 10' 55"	13.00	7.84	14.11	2.18	1,712,600.1633	1,628,146.0423	1,712,608.0014	1,628,145.9054	1,712,611.7802	1,628,152.7738	1,712,600.3903	1,628,159.0403
FC004	36° 27' 01"	58.00	19.10	36.90	3.06	1,712,611.7802	1,628,152.7738	1,712,620.9861	1,628,169.5061	1,712,618.4500	1,628,188.4345	1,712,560.9637	1,628,180.7323
FC005	81° 22' 04"	67.00	57.60	95.15	21.35	1,712,716.1581	1,628,144.0160	1,712,658.5704	1,628,145.0220	1,712,650.9217	1,628,202.1083	1,712,717.3283	1,628,211.0058

Plotted By: drp Date: 1/20/2015 7:41:45 AM  
 FILE: I:\2008\08807\001\C060\08807-001\C060 Sta 812 K96 and Ramp E-NS.dgn

Revision		By	Date
K-96 RAMP E-NS <b>COORDINATE GEOMETRY PLAN</b> <b>STA. 812+10.52 TO STA. 825+00</b> GARY JANZEN, P.E.-CITY ENGINEER CITY OF WICHITA PROJECT NO. 472-84780			
PROFESSIONAL ENGINEERING CONSULTANTS, P.A. 303 SOUTH TOPEKA WICHITA, KS 67202 316-262-2691 www.pec1.com			
Designed by	JPS	Job No.	08807-001
Drawn by	SVB	Date	Jan., 2015
			Sht. 34 of 227