

COORDINATE TABLE					
POINT NO.	NORTH COORDINATE	EAST COORDINATE	STATION	OFFSET	DESCRIPTION
4052	1,712,461.7303	1,630,089.9407	831+86.31	54.09 Lt.	P.I. Edge of Pvmf
4053	1,712,471.6080	1,630,137.1534	832+33.07	10.00 Lt.	Edge of Shldr / Match Point
4054	1,712,461.6082	1,630,137.0960	832+33.07	0.00 Lt.	Edge of Pvmf / Match Point

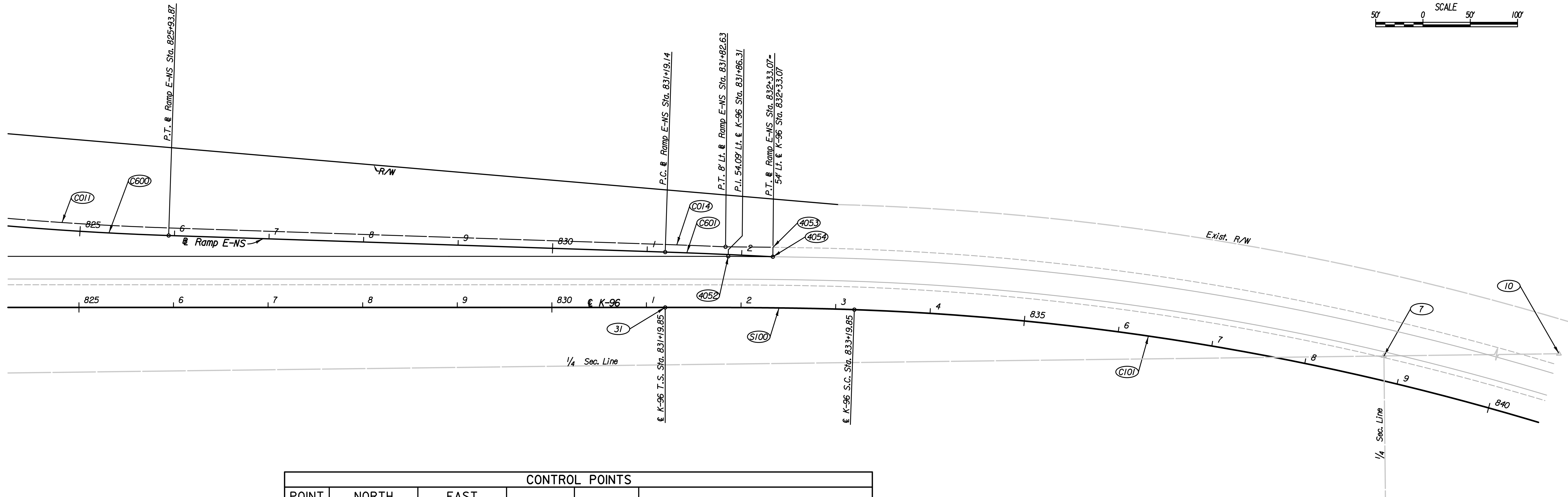
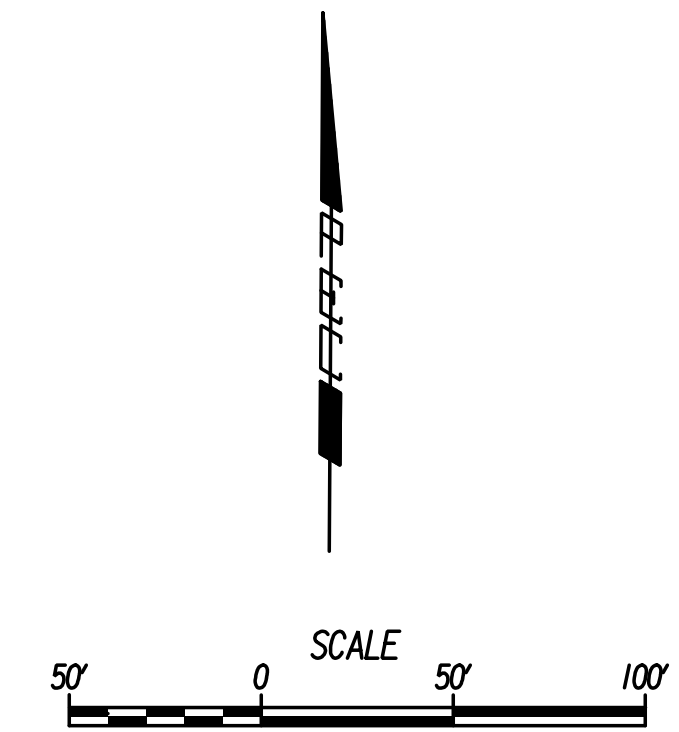

CONTROL POINTS					
POINT NO.	NORTH COORDINATE	EAST COORDINATE	STATION	OFFSET	DESCRIPTION
7	1,712,360.9048	1,630,783.8214	838+79.71	25.63 Lt.	Ctr. Cor. Sec. 26 - 1/2" Iron Pipe
10	1,712,411.3551	1,633,436.3699			E 1/4 Cor. Sec. 26 - 3/4" Rebar
31	1,712,407.3024	1,630,023.6249	831+19.85	0.00 Lt.	€ of K-96 - 3/4" Rebar

CURVE DATA													
NO.	Δ	R	T	L	E	P.C. COORDINATES		P.I. COORDINATES		P.T. COORDINATES		C.C. COORDINATES	
						NORTH	EAST	NORTH	EAST	NORTH	EAST	NORTH	EAST
C011	06° 05' 27"	3,292.00	175.14	349.96	4.66	1,712,515.8866	1,629,149.7080	1,712,492.6279	1,629,323.3003	1,712,487.9196	1,629,498.3805	1,715,778.7299	1,629,586.8783
C014	00° 38' 04"	5,743.00	31.79	63.58	0.09	1,712,473.7989	1,630,023.4635	1,712,472.9442	1,630,055.2429	1,712,471.7378	1,630,087.0109	1,706,732.8744	1,629,869.0762
C101	20° 00' 00"	2,864.79	505.14	1,000.00	44.19	1,712,406.2623	1,630,223.6114	1,712,391.8822	1,630,728.5462	1,712,205.6714	1,631,198.1115	1,709,542.6344	1,630,142.0576
C600	06° 05' 27"	3,300.00	175.57	350.81	4.67	1,712,507.9575	1,629,148.6456	1,712,484.6423	1,629,322.6598	1,712,479.9225	1,629,498.1655	1,715,778.7299	1,629,586.8783
C601	01° 08' 17"	5,735.00	56.97	113.93	0.28	1,712,465.8018	1,630,023.2484	1,712,464.2704	1,630,080.1931	1,712,461.6082	1,630,137.0960	1,706,732.8744	1,629,869.0762

Plotted By: drp Date: 1/15/2015 11:22:56 AM
 FILE: I:\2008\08807\001\C060\08807-001\C060 Sta 825 K96 and Ramp E-NS.dgn

Revision		By	Date
K-96 RAMP E-NS COORDINATE GEOMETRY PLAN STA. 825+00 TO STA. 832+33.07 GARY JANZEN, P.E.-CITY ENGINEER CITY OF WICHITA PROJECT NO. 472-84780			
PEC PROFESSIONAL ENGINEERING CONSULTANTS, P.A. 303 SOUTH TOPEKA WICHITA, KS 67202 316-262-2691 www.pec1.com			
Designed by	JPS	Job No.	08807-001
Drawn by	SVB	Date	Jan., 2015
			Sht. 35 of 227