

Wildcat Construction - contractor
 J. Wagner - City of Wichita, Field Project Engineer
 R. Strothman/D. Hicks - City of Wichita, Inspectors
 As-built
 Release Date: 03/03/2015
 pdf: APROsas 03/04/2015

CONSTRUCTION PLANS FOR PROPOSED STORM WATER SEWER COLLECTION SYSTEM IMPROVEMENTS

MERIDIAN AVENUE DRAINAGE OUTFALL PROJECT

FOR

THE CITY OF WICHITA, KANSAS

Gary Janzen, P.E., City Engineer

VICINITY MAP

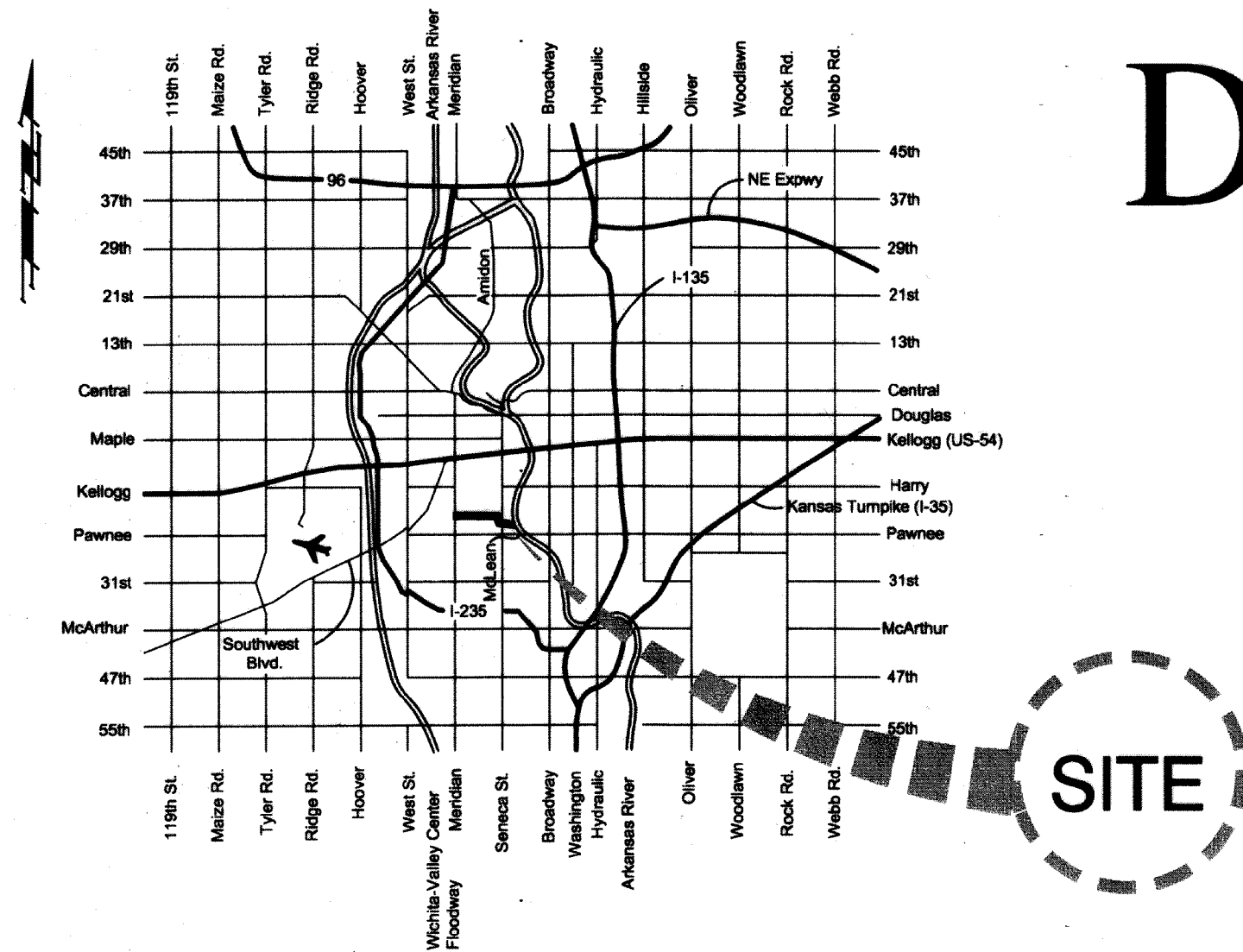

Water Line Project
 Project No. 448-90583
 O.C.A. No. 636270

Project No. 468-84868
 O.C.A. No. 706945

Sanitary Sewer Project
 Project No. 468-84864
 O.C.A. No. 620609

Index

1	Title Sheet
2	Keysheet
3	Notepage
4-18	SWS Line 1 Plan/Profile
19-26	SWS Lines 1a-10 Plan/Profile
27	SWS Line 2 Plan/Profile
28-29	SWS Lines 2a-2e Plan/Profile
30	SWS Line 3 Plan/Profile
31	RCP Connection Details
32-35	SS Line Plan/Profiles
36-40	Water Line Plan/Profiles
41-42	Water Line Details
43	Water Meter & Valve Adjustment Table
44-46	Pavement Typical Sections & Details
47-49	Pavement Details
50-52	Paving Keysheet
53-61	Paving Plans
62-68	Paving Joint Plans
69-76	Intersection Joint & Grading Plans
77	Valley Gutter Details
78-80	Pavement Marking Plan
81	Signing Details
82	Flap Gate Replacement Details
83-93	Storm Water Sewer Details
94	Railroad Crossing Detail
95-104	Debris Removal Structure Details
105	Recapitulations of Quantities
106-107	Detour Plans
108-111	Traffic Control Details
112-113	Seeding/Sodding Restoration Plan
114-115	Erosion Control Plan
116-119	Erosion Control Details

Plan Sheet #12 added
 (change order)

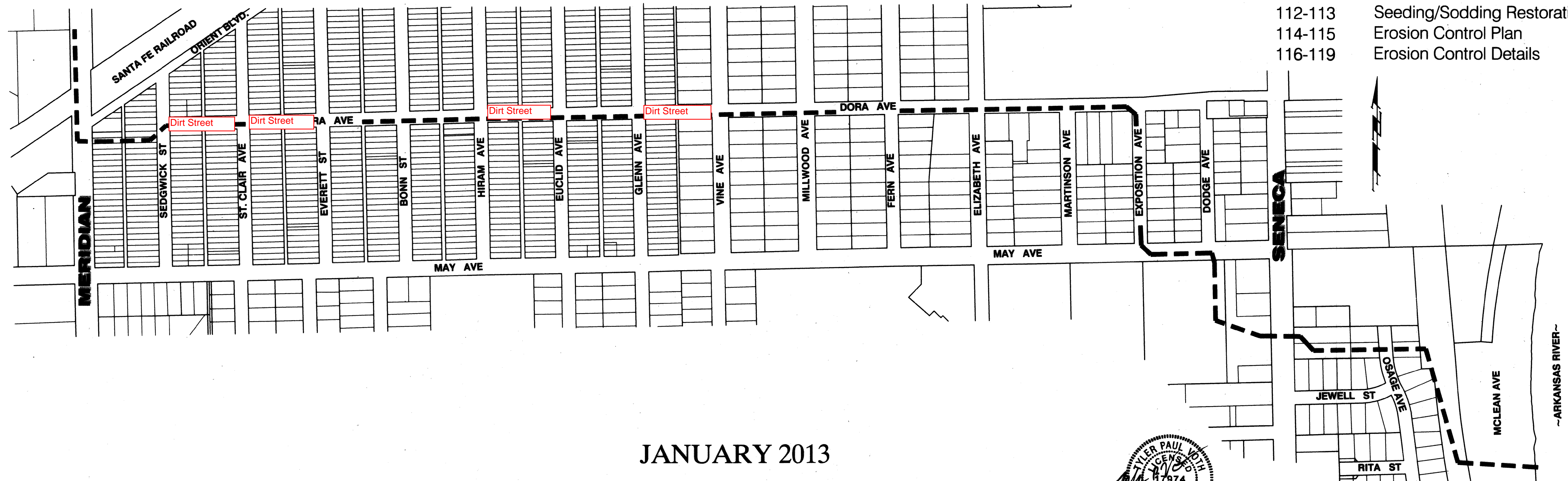

JANUARY 2013

