

REGION NO.	STATE	PROJECT NO.	FISCAL YEAR	SHEET NO.	TOTAL SHEETS
7	KANSAS	087 N-0594-01	2014		

F.A. No. CMQ - N 059(401)

GRADING  
SURFACING  
STORM SEWER  
SEEDING

STATE OF KANSAS  
DEPARTMENT OF TRANSPORTATION

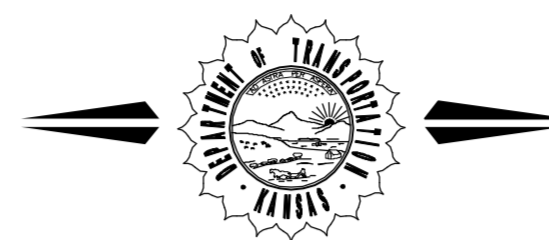

CONSTRUCTION PLANS FOR PROPOSED  
**MERIDIAN AVENUE**  
FROM PAWNEE to ORIENT

FEDERAL AID PROJECT

FOR

THE CITY OF WICHITA,  
SEDGWICK COUNTY, KANSAS

Gary Janzen, P.E., City Engineer

Paving Project

City Project No. 472-85124

O.C.A. No. 707060

OCTOBER 2014

OFFICE CHECK PLANS

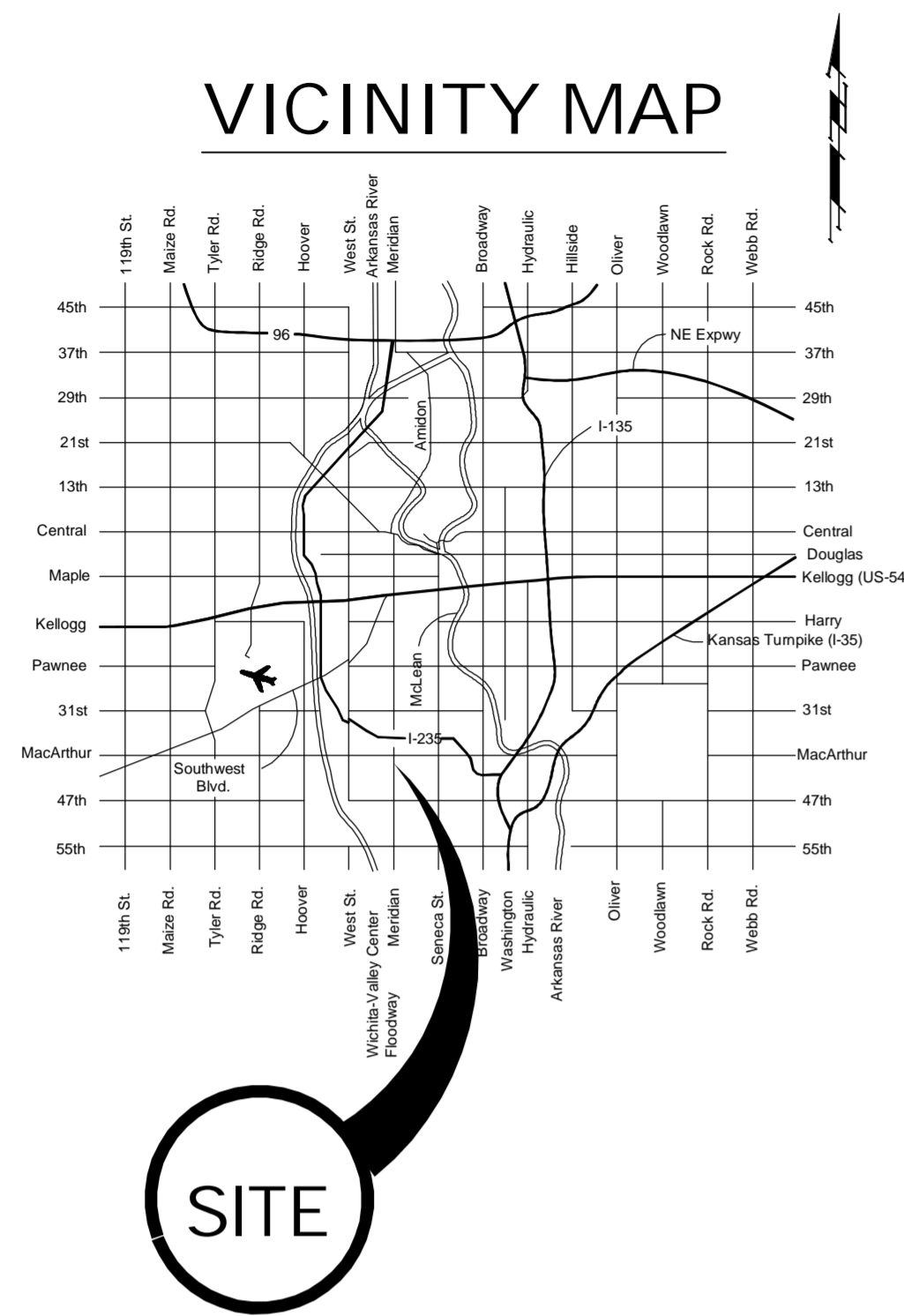

Index

- 1 Title Sheet
- 2 Keysheet
- 3 General Notepage
- 4 Typical Sections
- 5-6 Pavement Details
- 7 Standard Drive Details
- 8-13 Meridian Paving Plans
- 14-16 Valley Gutter Details
- 17-21 Storm Water Sewer Plan/Profiles
- 22-23 Water Line Plan/Profiles
- 24 Fire Hydrant Relocation Plans
- 25-29 Meridian Avenue Cross Sections

SITE

STA. 12+26.75  
BEGIN CONSTRUCTION  
87 N-0594-01

STA. 40+85.00  
END PROJECT  
87 N-0594-01

SCALE: 1" = 300'

DESIGN DATA

AADT (2006)	14,898
AADT (2030)	18,984
DHV	8%
T	3%
V	40 mph
C of A	N/A
Clear Zone	6'

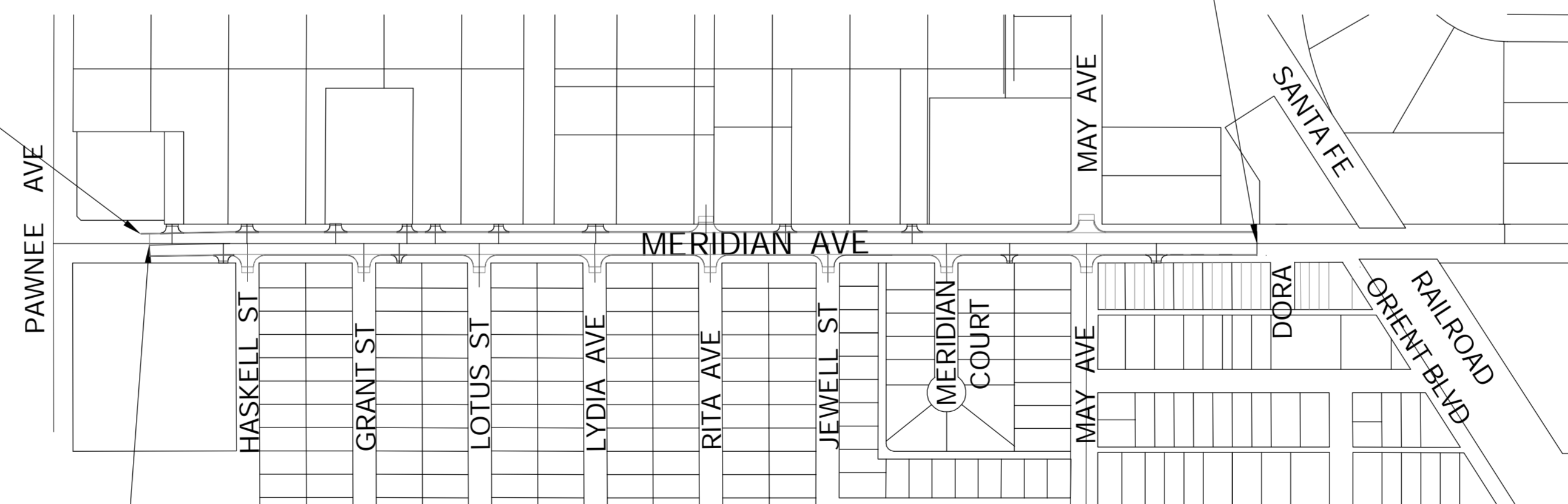

STA. 12+48.77  
BEGIN PROJECT  
87 N-0594-01

Gross Length of Project	2,836.23 ft.
Exceptions	0 ft.
Additions	0.00 ft.
Net Length of Project	2,836.23 ft.
Net Length of Bridges	0.00 ft.
Net Length of Road	2,836.23 ft.

APPROVED - DATE

GARY JANZEN, P.E., CITY ENGINEER  
CITY OF WICHITA, KANSAS