

FHWA REGION NO.	STATE	PROJECT NO.	FISCAL YEAR	SHEET NO.	TOTAL SHEETS
7	KANSAS	XXN-XXXX-01	2013		

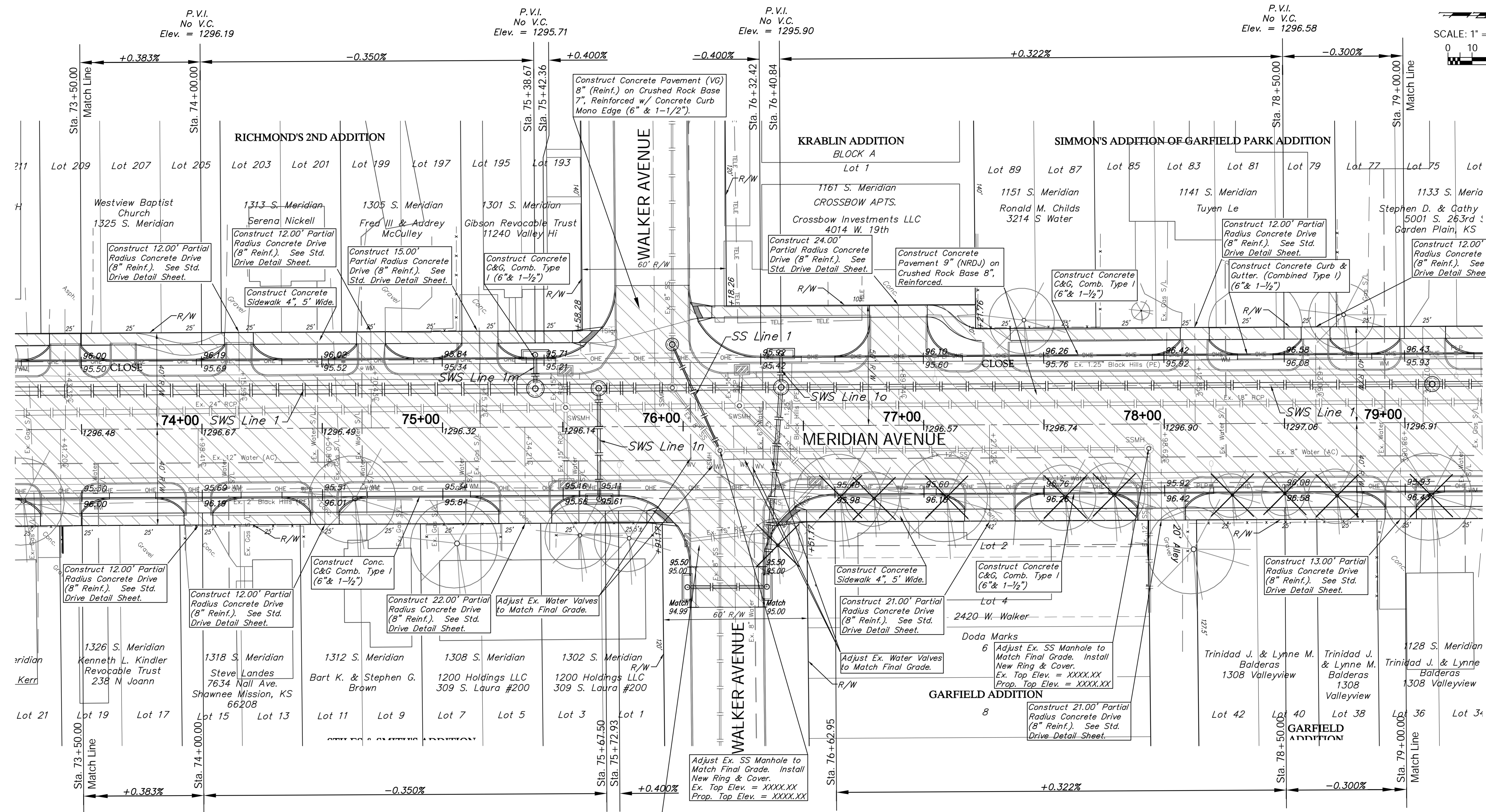

Construct Concrete Pavement (VG) 8" (Reinf.) on Crushed Rock Base 7", Reinforced w/ Concrete Curb Mono Edge (6" & 1-1/2").

Areas of Full Pavement Removal & Replacement are Indicated By:

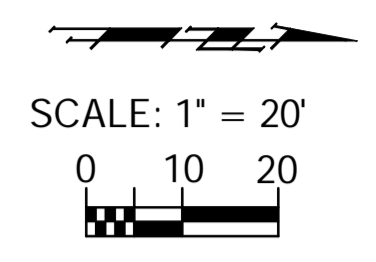

Note:  
Trees/Shrubs to be removed are marked thus:



Drawing File: E:\Projects\Meridian - Orient to McCormick\Civil 3d\Meridian Base.dwg (Pav 06)  
Project No. 1004E493 CAPITAL IMPROVEMENT PROJECT  
Design: TPV  
Drawn: STAFF  
Approved: TPV  
Scale: NOTED  
**MERIDIAN AVENUE PAVING**  
Sta. 73 + 50.00 to Sta. 79 + 00.00  
MERIDIAN AVENUE - ORIENT BOULEVARD TO MCCORMICK AVENUE

**Baughman Company, P.A.**  
315 Ellis St., Wichita, KS 67211 P 316-262-7271 F 316-262-0149  
ENGINEERING | SURVEYING | PLANNING | LANDSCAPE ARCHITECTURE

April 2013  
SHEET  
OF