

**BENCHMARK:**  
 BM #6 - "T" Post Set Five Feet South of Maize South School Entrance Sign at the North Side of East Entrance Sta. 44+48, 86' Lt. Elev. = 1344.89 (NGVD 29)

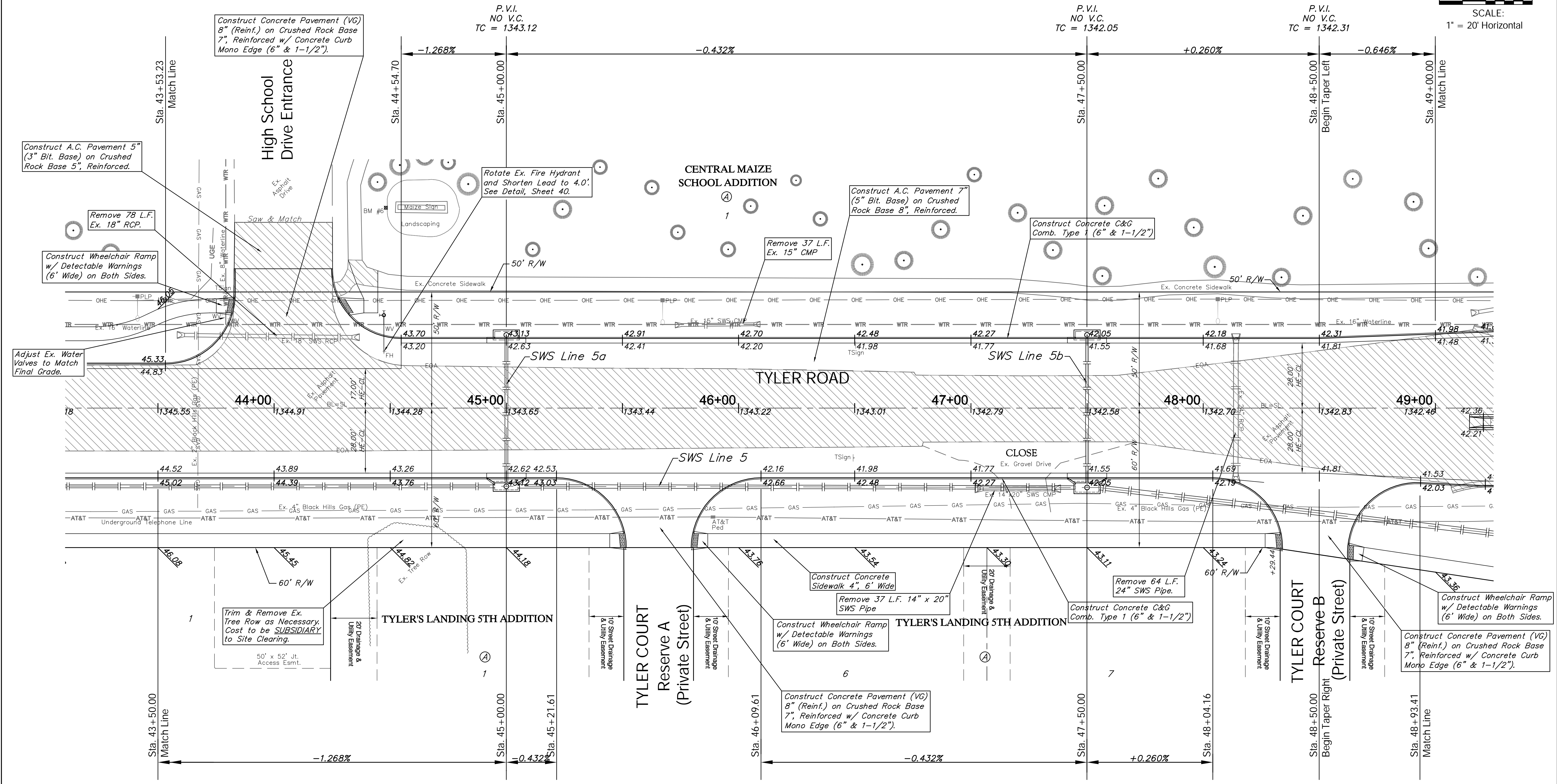
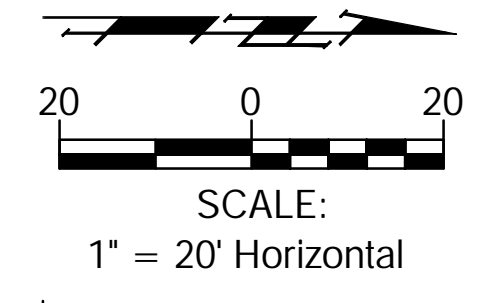

P.V.I. NO V.C. TC = 1343.12

P.V.I. NO V.C. TC = 1342.05

P.V.I. NO V.C. TC = 1342.31

**Note:**  
 Pavement, Sidewalks, Etc. To Be Removed Are Indicated By:

Design: ENGINEER  
 Drawn: STAFF  
 Approved: ENGINEER  
 Scale: NOTED

Drawing File: E:\eng\Tyler\29th to 37th\Land\dwg\Tyler Base.dwg (Pav09)  
 Project No. 0802E057 CAPITAL IMPROVEMENT PROJECT  
**TYLER ROAD PAVING**  
 Sta. 43 + 50.00 to Sta. 49 + 00.00  
 TYLER ROAD - 29TH STREET NORTH to 37TH STREET NORTH

March 2015  
**Baughman Company, P.A.**  
 315 Ellis St., Wichita, KS 67211 P 316.262.7271 F 316.262.0149  
 ENGINEERING | SURVEYING | PLANNING | LANDSCAPE ARCHITECTURE