

BENCHMARK:

BM #6 - "T" Post Set Five Feet South of Maize South School Entrance Sign at the North Side of East Entrance
Sta. 44+48, 86' Lt.
Elev. = 1344.89 (NGVD 29)

BM #7 - "□" Chiseled on Top of Curb at West Side of North End of Median
225' North of 37th and Tyler Intersection.
Elev. = 1340.74 (NGVD 29)

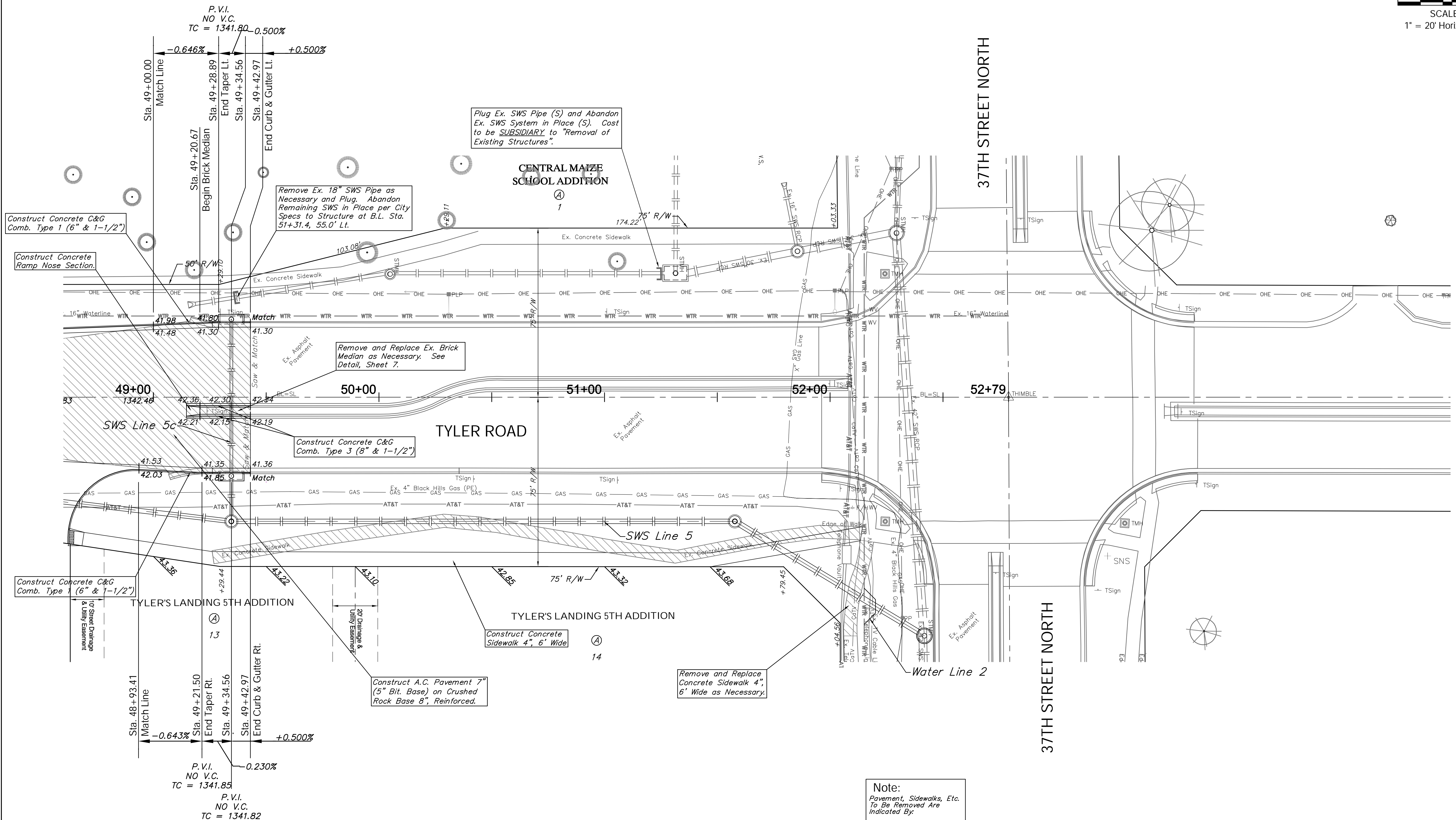
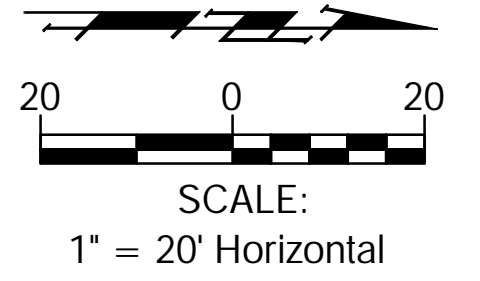

Note:
Pavement, Sidewalks, Etc.
To Be Removed Are
Indicated By:

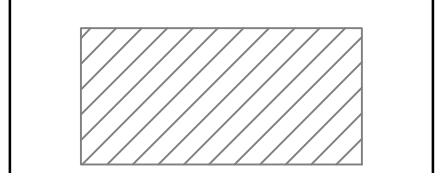

Design:	ENGINEER
Drawn:	STAFF
Approved:	ENGINEER
Scale:	NOTED

Drawing File: E:\eng\Tyler29th to 37th\Land\dwg\Tyler Base.dwg (Par10)
Project No. 0802E057 CAPITAL IMPROVEMENT PROJECT
TYLER ROAD PAVING
Sta. 49+00.00 to Sta. 49+50.00
TYLER ROAD - 29TH STREET NORTH to 37TH STREET NORTH

Baughman Company, P.A.
315 Ellis St. Wichita, KS 67211 P 316.262.7271 F 316.262.0149
ENGINEERING | SURVEYING | PLANNING | LANDSCAPE ARCHITECTURE