

BENCHMARK:

BM #3 - "□" Chisled on Top of Curb on West Side of Handicap Ramp at the North Side of Entrance to Fox Ridge
Sta. 17+43.57' Lt.
Elev. = 1367.36 (NGVD 29)

Sta. 0+00.00, Begin SWS Line 2 =
B.L. Sta. 18+84.93, 31.50' Lt.
Construct Inlet, Curb (Type 1)
(L=5', W=3')
Top Elev. = 1365.57

Sta. 1+15.42, SWS Line 2 =
Sta. 0+00.00, SWS Line 2a
B.L. Sta. 20+00.00, 22.67' Lt.
Construct Inlet, Curb (Type 1a)
(L=10', W=3')
Top Elev. = 1364.36

Sta. 3+40.43, SWS Line 2 =
B.L. Sta. 22+25.00, 22.67' Lt.
Construct MH, Type P
Shallow (4')
Top Elev. = 1361.76

CAUTION!
Existing
O/H Elec
Crossing

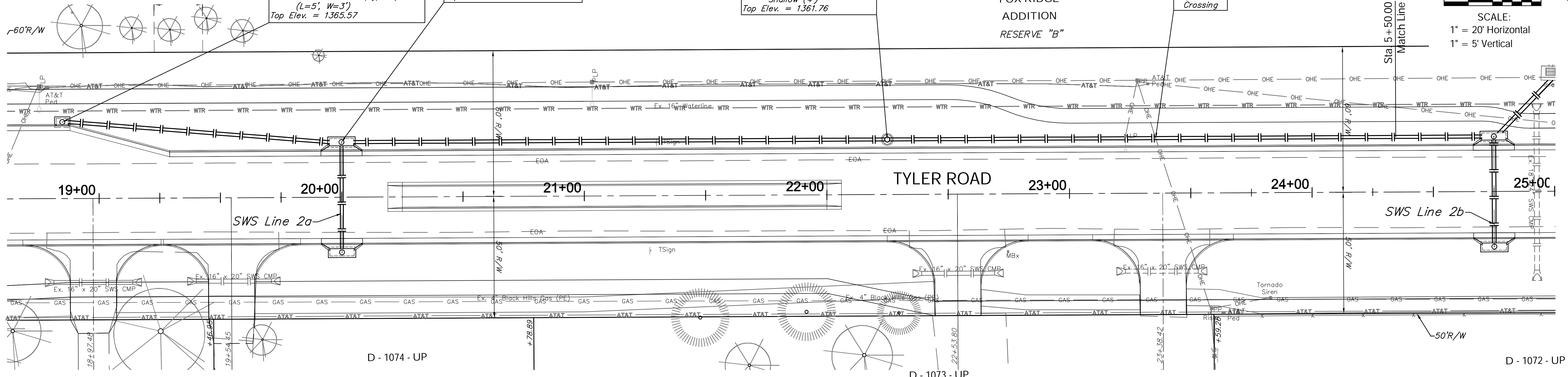
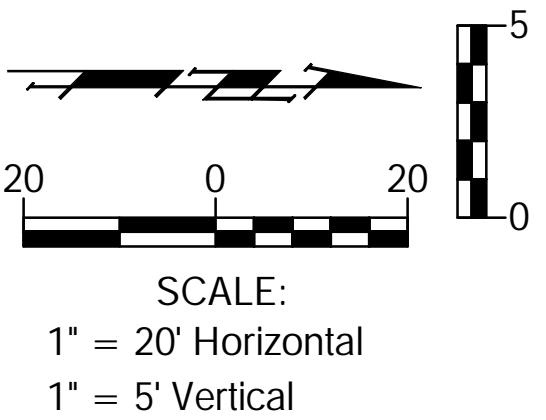

PER PLAN

SWS Line 2

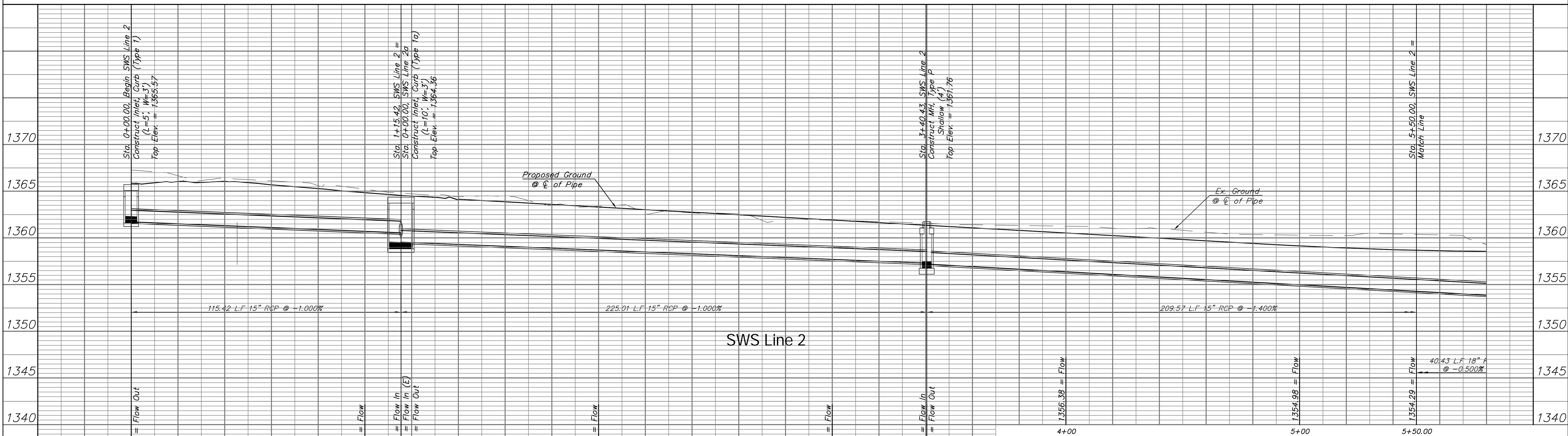

Drawing File: E:\Projects\Tyler-29th to 37th\Civil 3d\Tyler Base.dwg (SWS02)
 Project No. 0802E057 CAPITAL IMPROVEMENT PROJECT
TYLER ROAD SWS PLAN & PROFILE
 SWS Line 2, Sta. 0+00.00 to Sta. 5+50.00
 TYLER ROAD - 29th STREET NORTH to 37th STREET NORTH
 Design: TPV
 Drawn: JDM
 Approved: ENGINEER
 Scale: NOTED

Baughman Company, P.A.
 315 Ellis St. Wichita, KS 67211 P 316.262.7271 F 316.262.0149
 ENGINEERING | SURVEYING | PLANNING | LANDSCAPE ARCHITECTURE

March 2015
 SHEET 24 OF 95