

BENCHMARK:
 BM #4 - "T" Post Set at Fence Line Next to Brace Post
 South Side of Entrance to 3320 Tyler Rd
 Sta. 26+00, 50' Rt.
 Elev. = 1361.08 (NGVD 29)

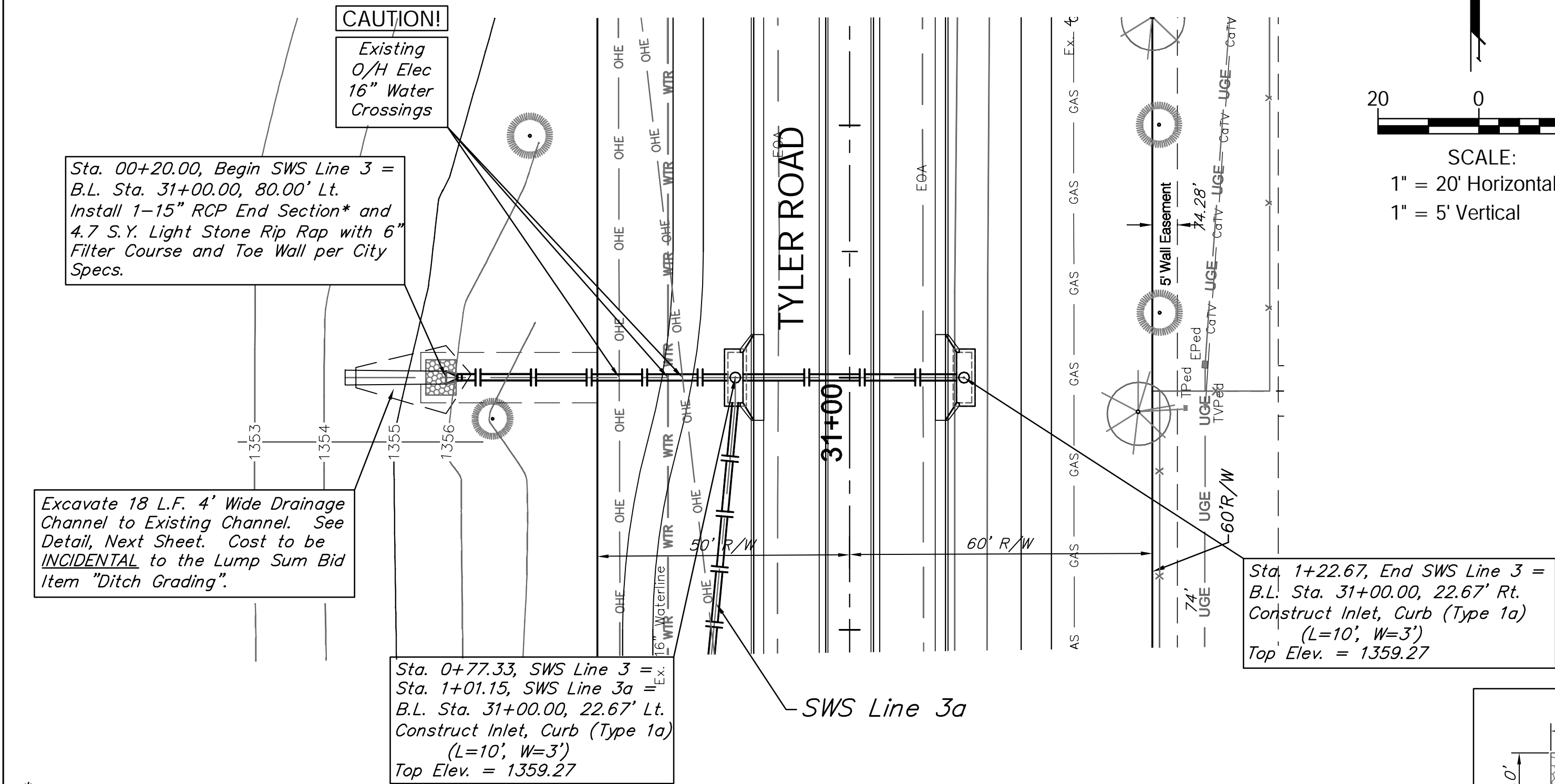

* The Contractor Shall Anchor the Precast End Section to the Adjacent Reinforced Concrete Pipe. See Detail, Sheet 36. The Cost Shall be SUBSIDIARY to the Installation of the Reinforced Concrete Pipe.

SWS Line 3

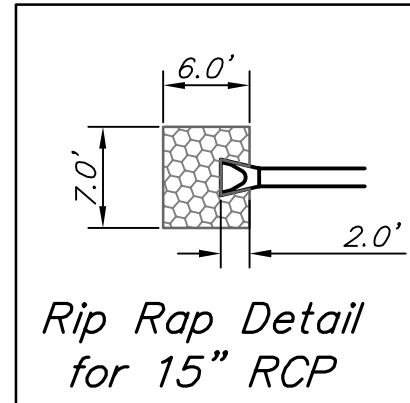

PER PLAN

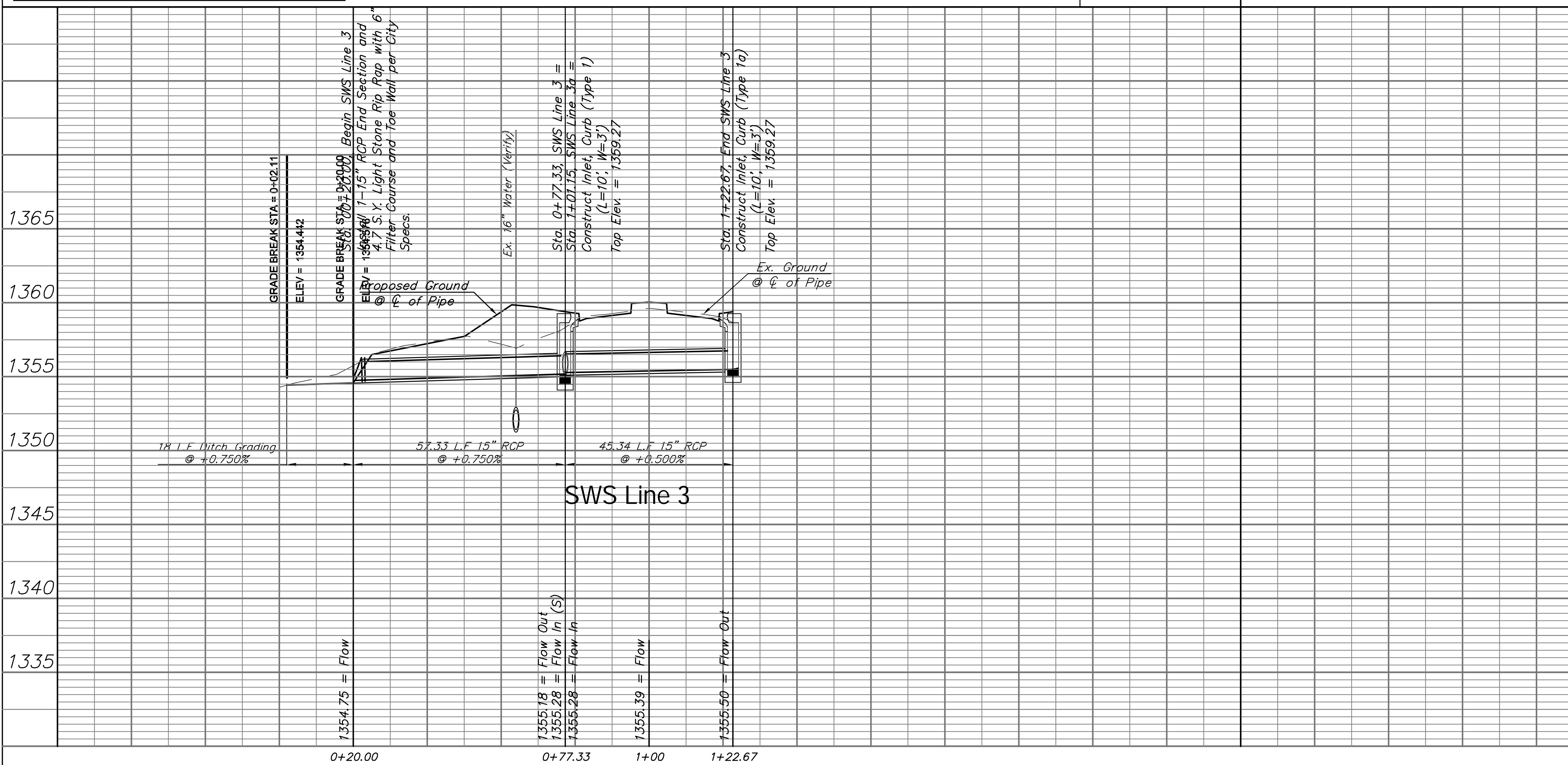

BENCHMARK:
 BM #4 - "T" Post Set at Fence Line Next to Brace Post
 South Side of Entrance to 3320 Tyler Rd
 Sta. 26+00, 50' Rt.
 Elev. = 1361.08 (NGVD 29)

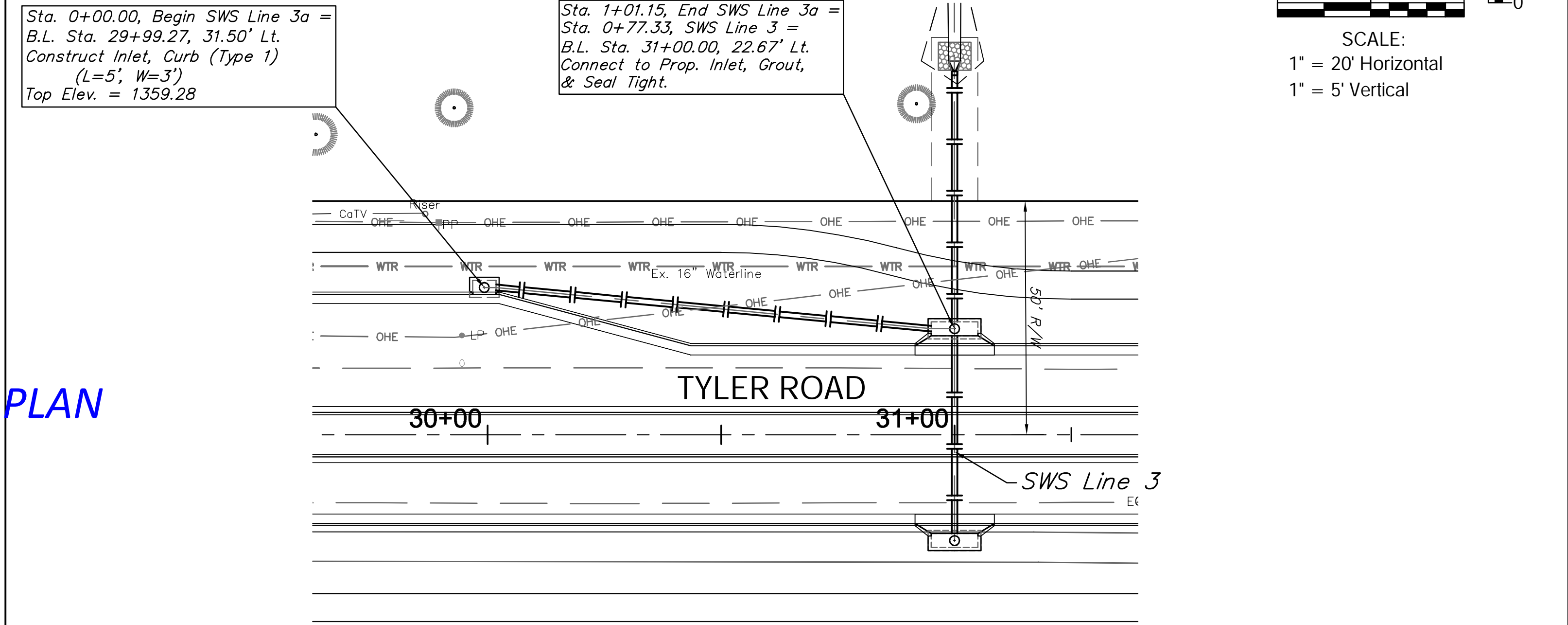

SWS Line 3a

