

BENCHMARK:
 BM #5 - "□" Chiseled on Top of Curb at West End of Median at Brookview Entrance
 Sta. 36+66, 62' Rt.
 Elev. = 1352.54 (NGVD 29)

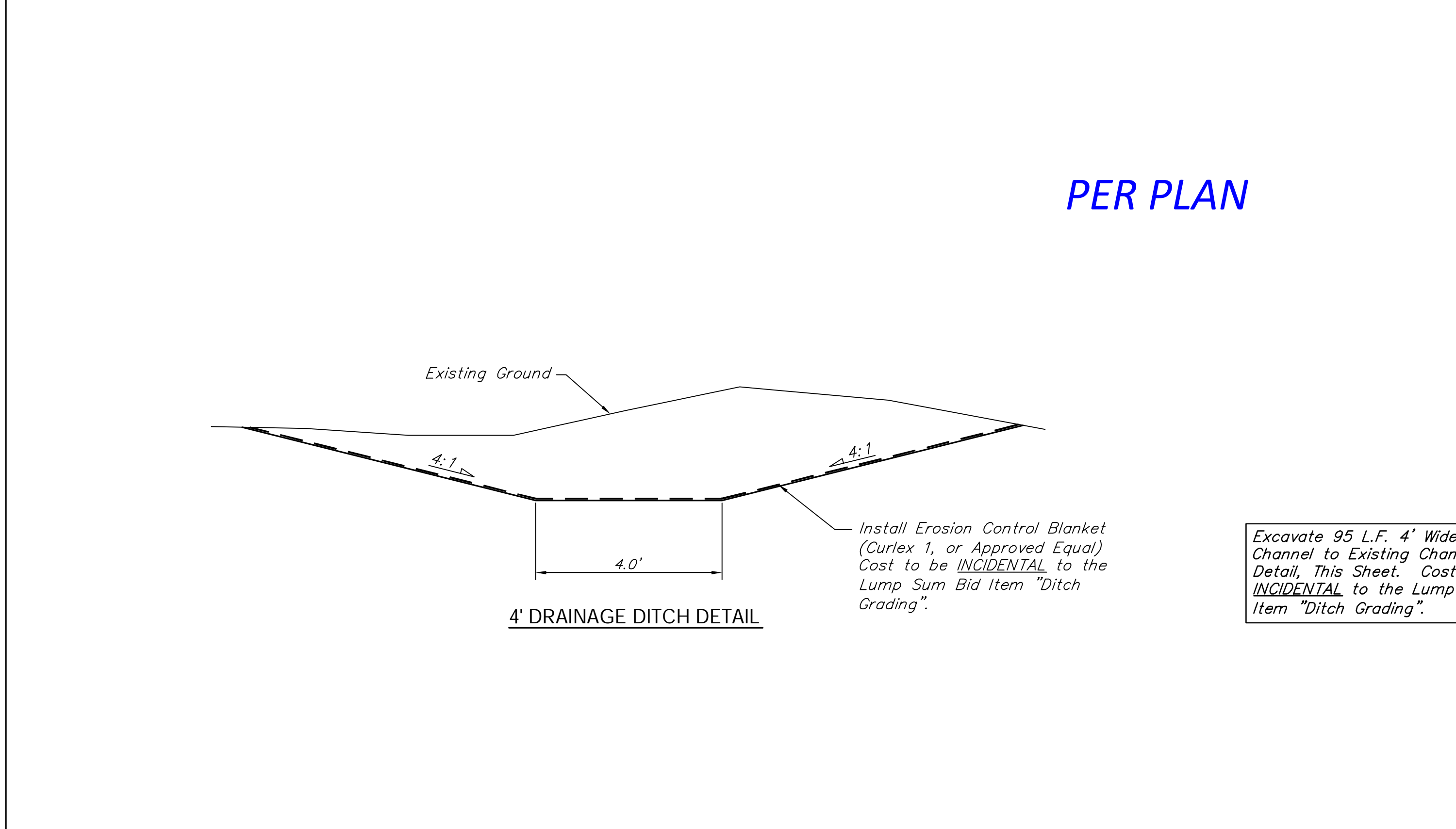

Sta. 0+40.00, Begin SWS Line 4 =
 B.L. Sta. 35+23.54, 60.00' Lt.
 Install 1-15" RCP End Section* and
 4.7 S.Y. Light Stone Rip Rap with 6"
 Filter Course and Toe Wall per City
 Specs.

CAUTION!
 Existing
 16" Water
 Crossing

Excavate 95 L.F. 4' Wide Drainage
 Channel to Existing Channel. See
 Detail, This Sheet. Cost to be
 INCIDENTAL to the Lump Sum Bid
 Item "Ditch Grading".

Sta. 0+77.33, SWS Line 4 =
 B.L. Sta. 35+23.54, 22.67' Lt.
 Construct Inlet, Curb (Type 1a)
 (L=10', W=3')
 Top Elev. = 1352.98

*
 The Contractor Shall Anchor the Precast End
 Section to the Adjacent Reinforced Concrete
 Pipe. See Detail, Sheet 36. The Cost Shall be
 SUBSIDIARY to the Installation of the Reinforced
 Concrete Pipe.

Sta. 1+33.66, End SWS Line 4 =
 B.L. Sta. 35+23.54, 33.67' Rt.
 Construct Inlet, Curb (Type 1a)
 (L=10', W=3')
 Top Elev. = 1352.63

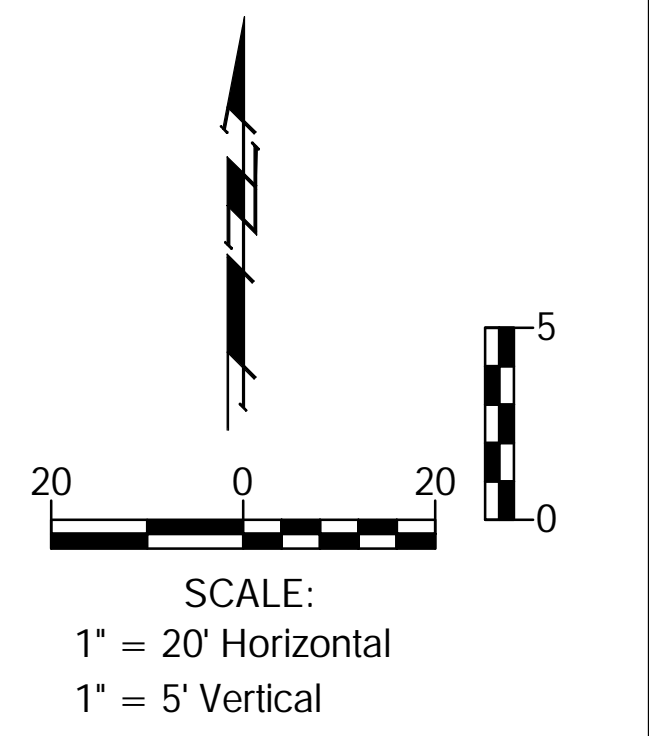

Note:
 Trees/Shrubs to be
 removed are marked thus:

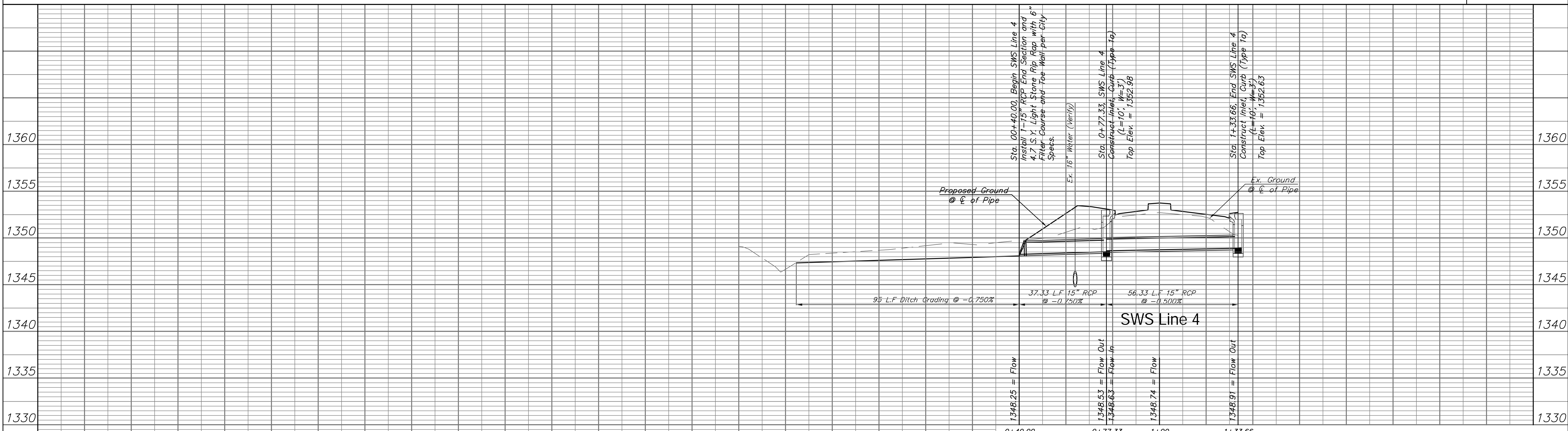
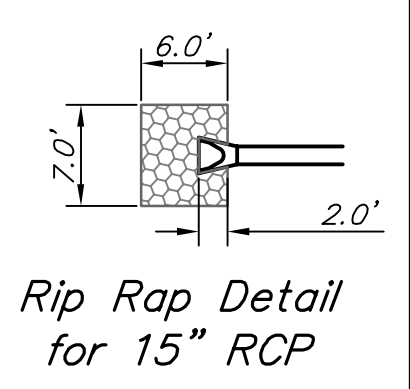

0+40.00 0+77.33 1+00 1+33.66

Drawing File: E:\Projects\Tyler-29th to 37th\Civil\36\Tyler Base.dwg (SWS05)
 Design: TPV
 Drawn: JDM
 Approved: ENGINEER
 Scale: NOTED

Baughman Company, P.A.
 315 Ellis St. Wichita, KS 67211 P 316-262-7271 F 316-262-0149
 ENGINEERING | SURVEYING | PLANNING | LANDSCAPE ARCHITECTURE

March 2015
 SHEET
 OF
 27
 95