

1/11

1/11

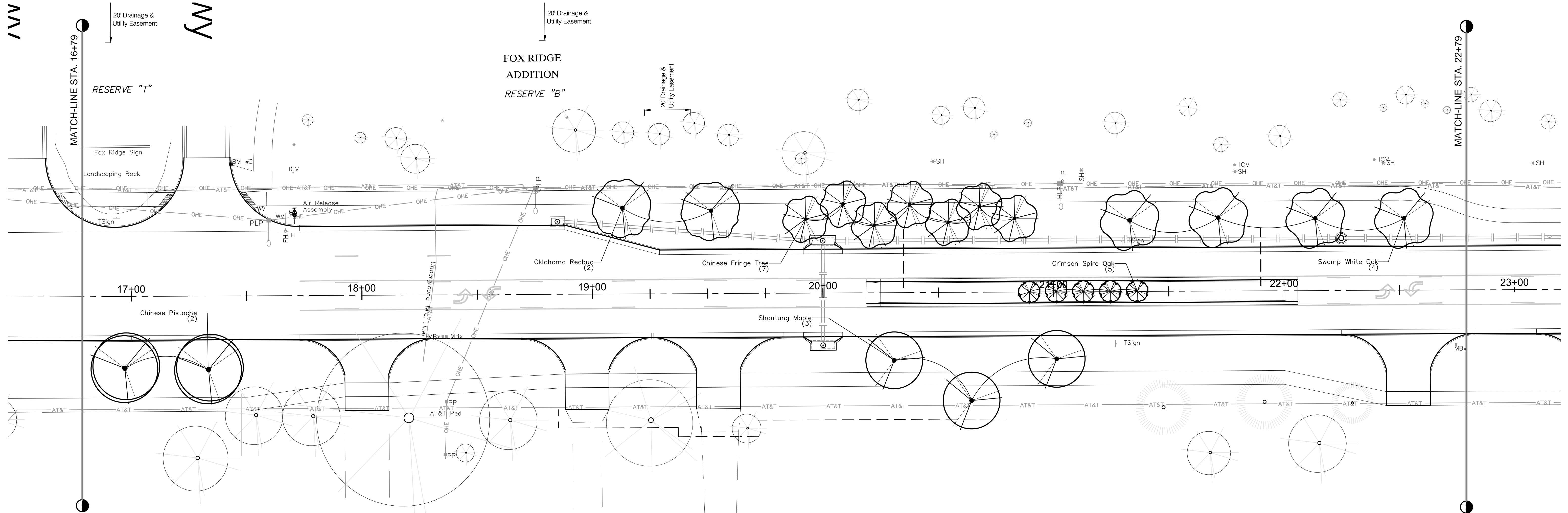

D - 1074 - UP
Norris P. Woodard, etal

D - 1162 - UP
K C Ventures LLC
3254 N. Tyler Road

D - 1163 - UP
Norris P. Woodard, etal
3254 N. Tyler Road

D - 1074 - UP
Norris P. Woodard, etal
3300 N. Tyler Road

D - 1073 - UP
Gary L. Woodard
3314 N. Tyler Road

PLANT SCHEDULE 4

DECIDUOUS TREES	BOTANICAL NAME	COMMON NAME	CONT	CAL
3	<i>Acer truncatum</i>	Shantung Maple	B & B	2"Cal
2	<i>Cercis canadensis</i> 'Oklahoma'	Oklahoma Redbud	B & B	2"Cal
7	<i>Chionanthus retusus</i>	Chinese Fringe Tree	B & B	2"Cal
2	<i>Pistacia chinensis</i>	Chinese Pistache	B & B	2"Cal
4	<i>Quercus bicolor</i>	Swamp White Oak	B & B	2"Cal
5	<i>Quercus robur x alba</i> 'Crimson Spire'	Crimson Spire Oak	B & B	2"Cal

Drawing File: ...Projects\Tyler29th to 37th\Landscape
Design: BKB
Drawn: BKB
Approved:
Scale: 1"=20'

Project No. 08-02-ED051 CAPITAL IMPROVEMENT PROJECT
Tyler Road Landscape
Sta. 16+79 to Sta. 22+79
Tyler Road 29th Street North to 37th Street North

Baughman Company, P.A.
315 Ellis St. Wichita, KS 67211 P 316-262-7271 F 316-262-0149
ENGINEERING | SURVEYING | PLANNING | LANDSCAPE ARCHITECTURE

March 2015
SHEET 73 OF 95