

STATE	PROJECT NO.	YEAR	SHEET NO.	TOTAL SHEETS
KANSAS	87 TE-0622-01	2014	10	13

McCormick & Seneca Intersection Striping

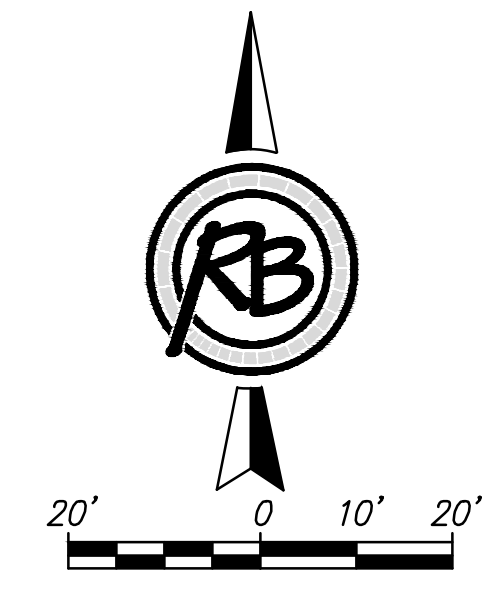

3M STAMARK HIGH PERFORMANCE SYMBOL AND LEGENDS SERIES SMS-L380AW PRE-CUT MARKING
 BIKE SHARROW (111" X 39") ITEM # 3M-SMS-L380AW-SH
 OR APPROVED EQUAL.

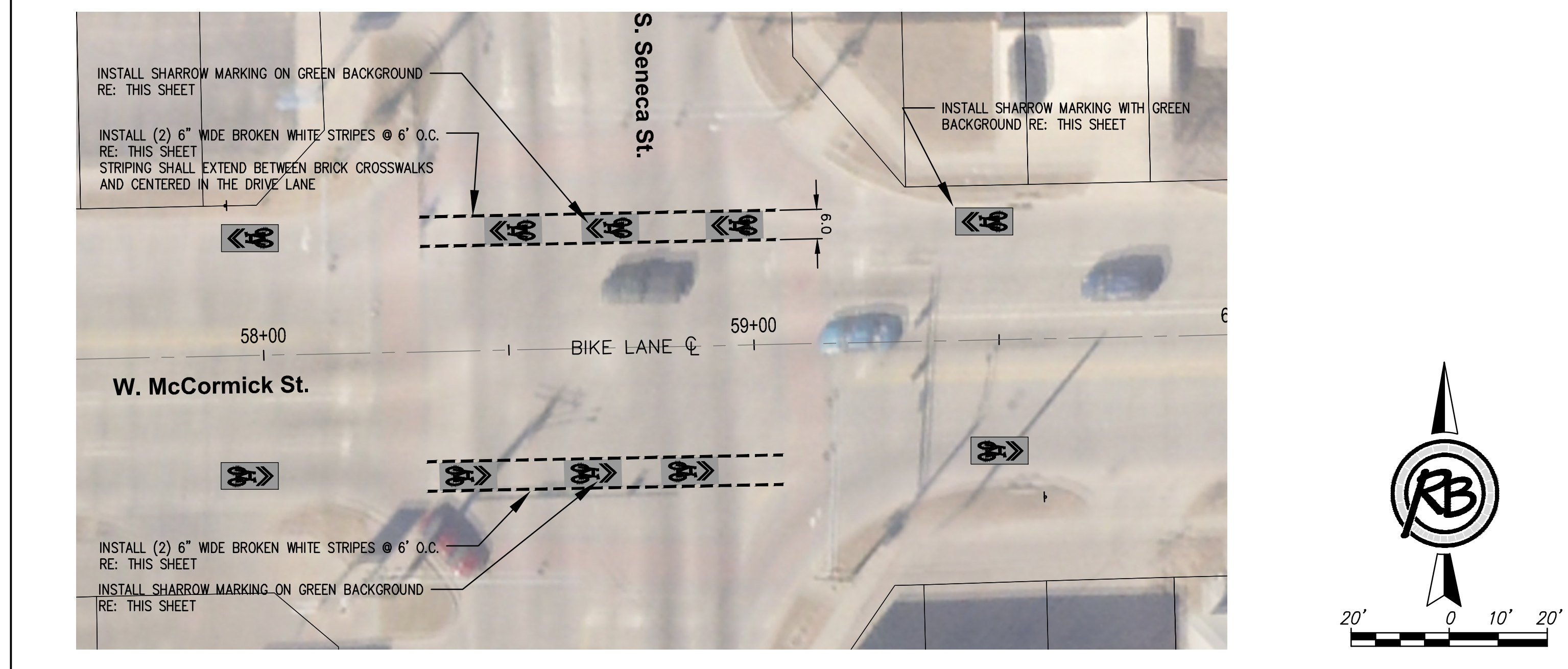
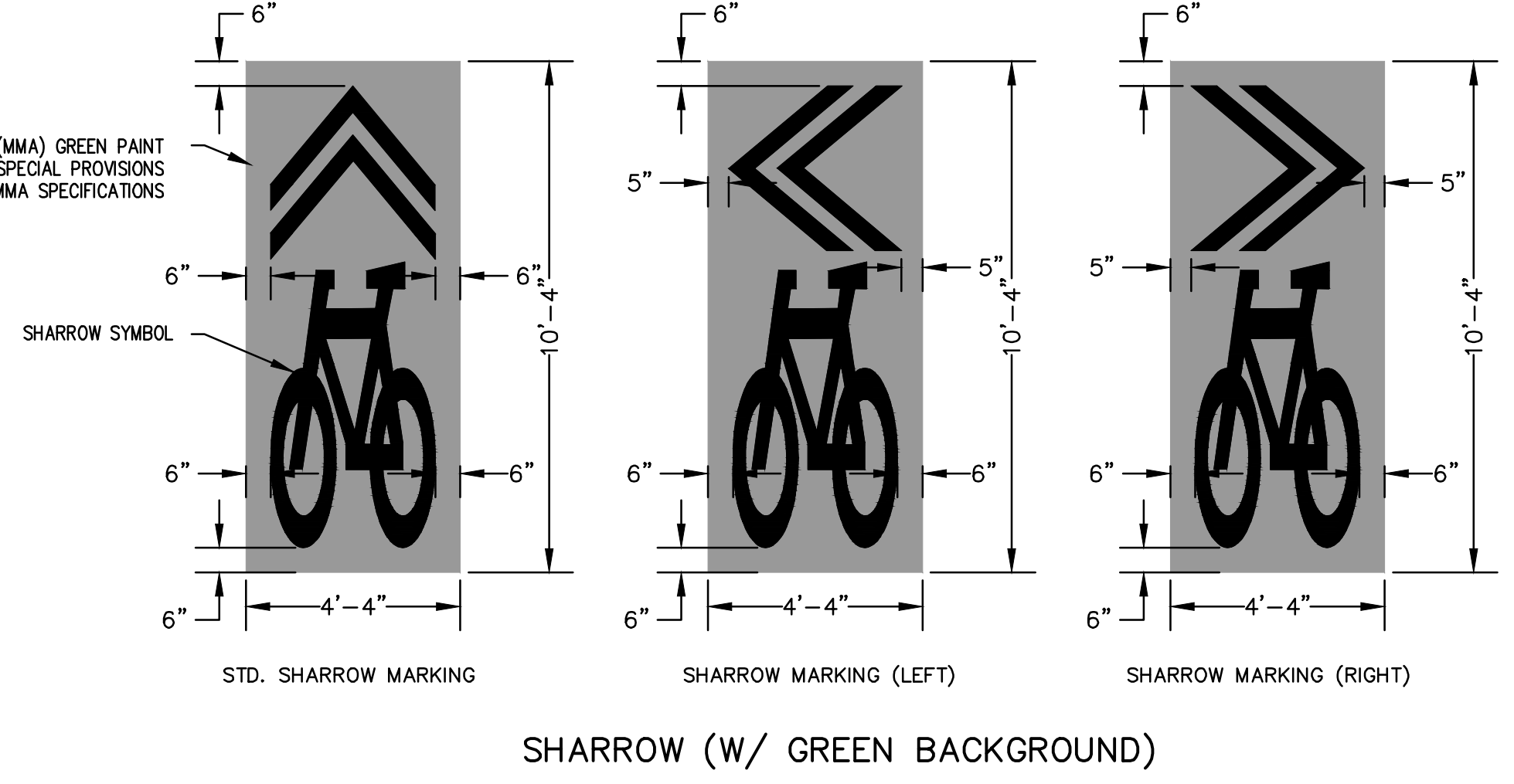
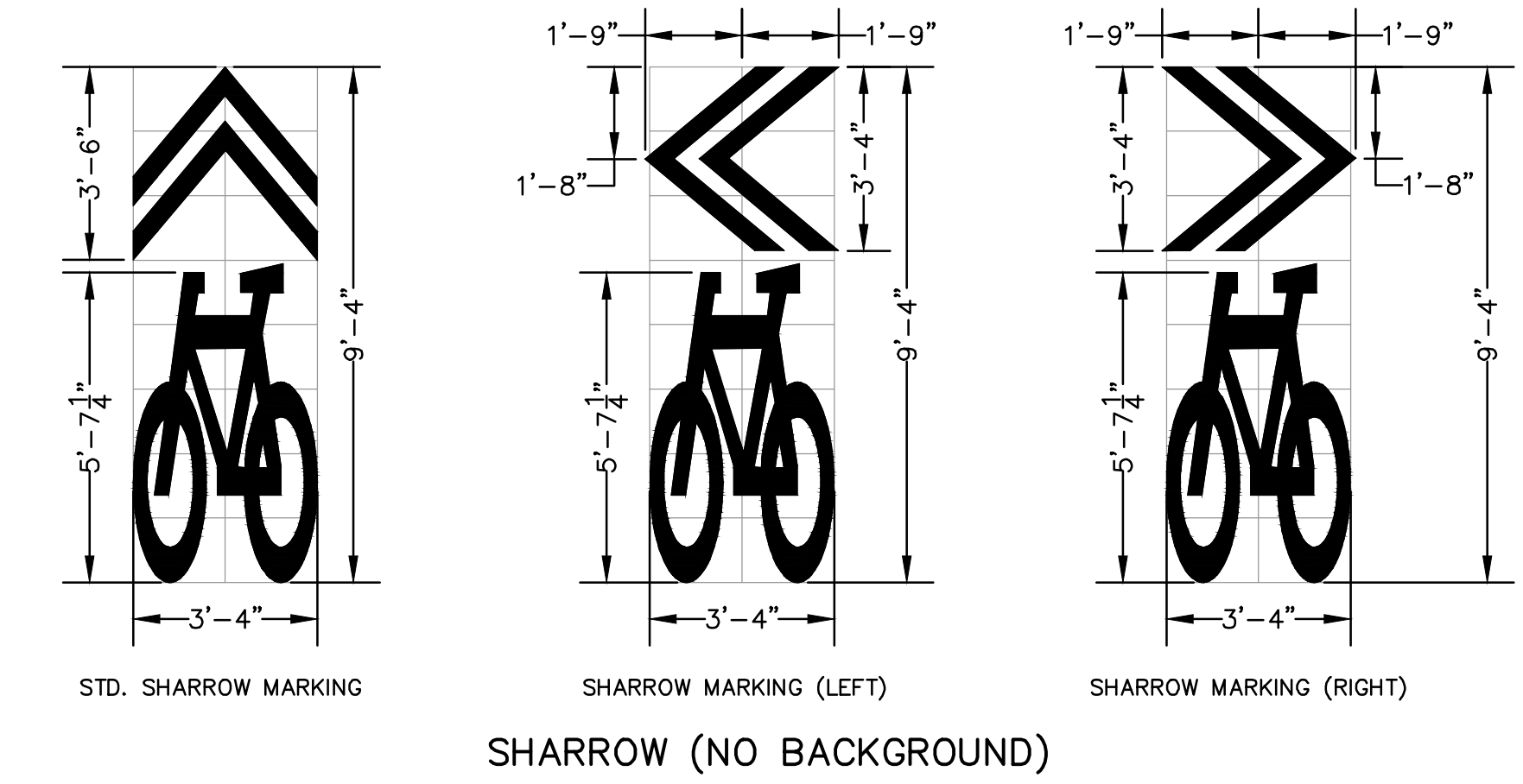

- SHARROWS SHALL BE LOCATED IN THE DRIVE LANES OF TRAFFIC WHERE THERE MAY OR MAY NOT BE ON-STREET PARKING.
- IN EACH CONDITION, SHARROWS SHALL BE LOCATED BASED ON THE DISTANCE BETWEEN THE FACE OF CURB AND THE TIP OF THE SHARROW.
 - ON-STREET PARKING: 14' FROM FACE OF CURB
 - NO PARKING: 6' FROM FACE OF CURB
- STREET CONDITIONS DEPICTED INCLUDE BOTH RESIDENTIAL AND 4-LANE ARTERIAL ROADWAYS.
- LANE STRIPING IS SHOWN FOR REFERENCE ONLY AND IS INTENDED TO SHOW THE RELATIONSHIP OF THE SHARROW TO DRIVE LANES, THE ROADWAY CENTER LINE, CENTER LINE STRIPING, AND PARKING STALL STRIPING LOCATIONS MAY VARY BY LOCATION.

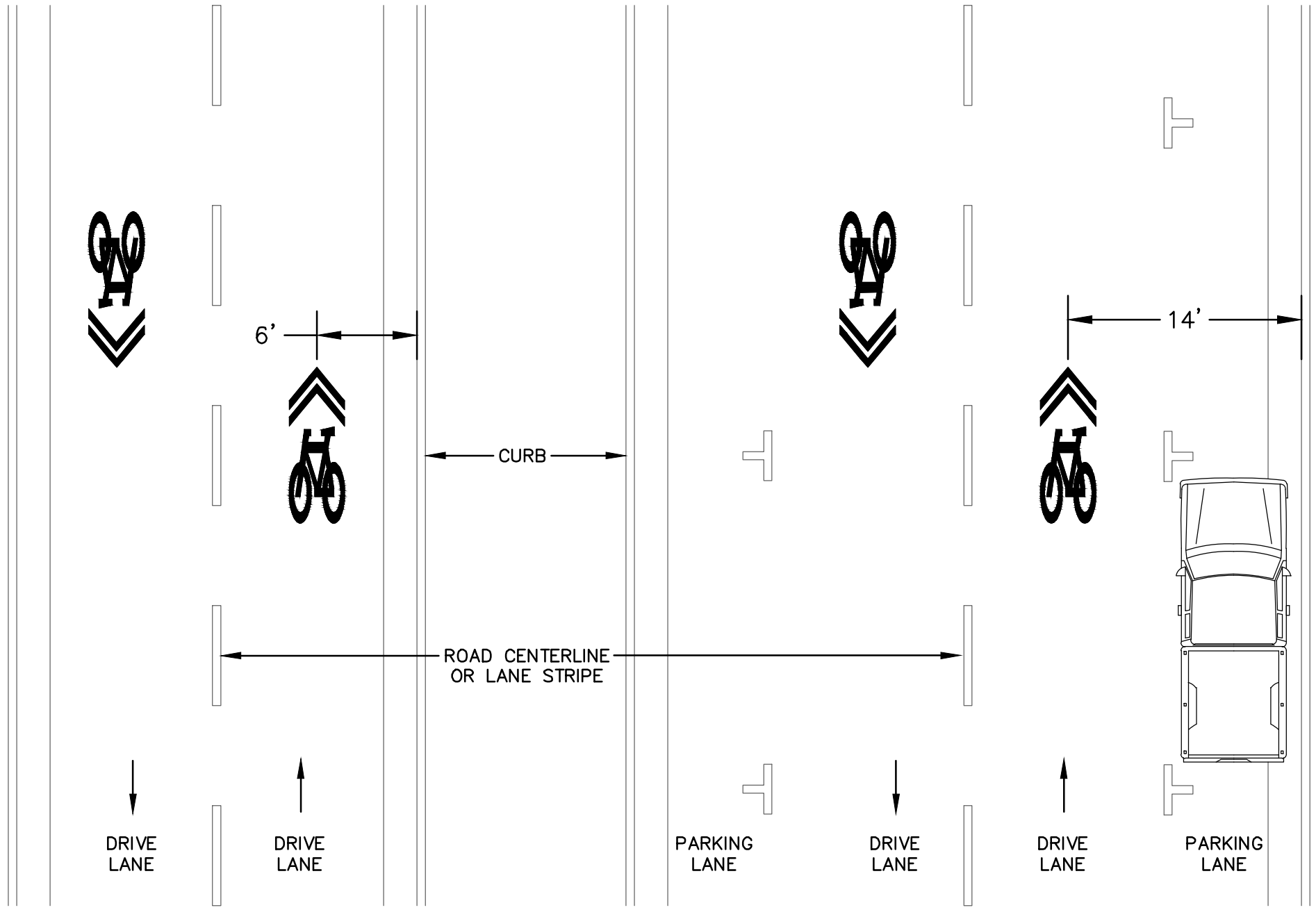

SHARROW W/ NO ON-STREET PARKING SHARROW W/ ON-STREET PARKING

RUGGLES & BOHM
INCORPORATED
 ARCHITECTS ENGINEERS LANDSCAPE ARCHITECTS PLANNERS
 1000 W. 17TH ST., SUITE 1000, WICHITA, KS 67202
 PH: 316.261.1100 FAX: 316.261.1101

DESIGN BDT UTILITY	DRAWN BDT DATE AUG 2014	REVIEWED BDT REVIEW AUG 2014
PROJECT NUMBER 472-5513		DRAWING FILE Base {0 Mkg Details}
PAVEMENT MARKING DETAILS SYCAMORE SHARED LANES WICHITA, KANSAS		
R6 JOB 4179H		
SHEET 10 OF 13		
© Copyright 2013, Ruggles & Bohm, P.A.		