

FHWA REGION NO	STATE	PROJECT NO	YEAR	SHEET NO	TOTAL SHEETS
7	KANSAS	54-87 K-4445-01	1996	36	73

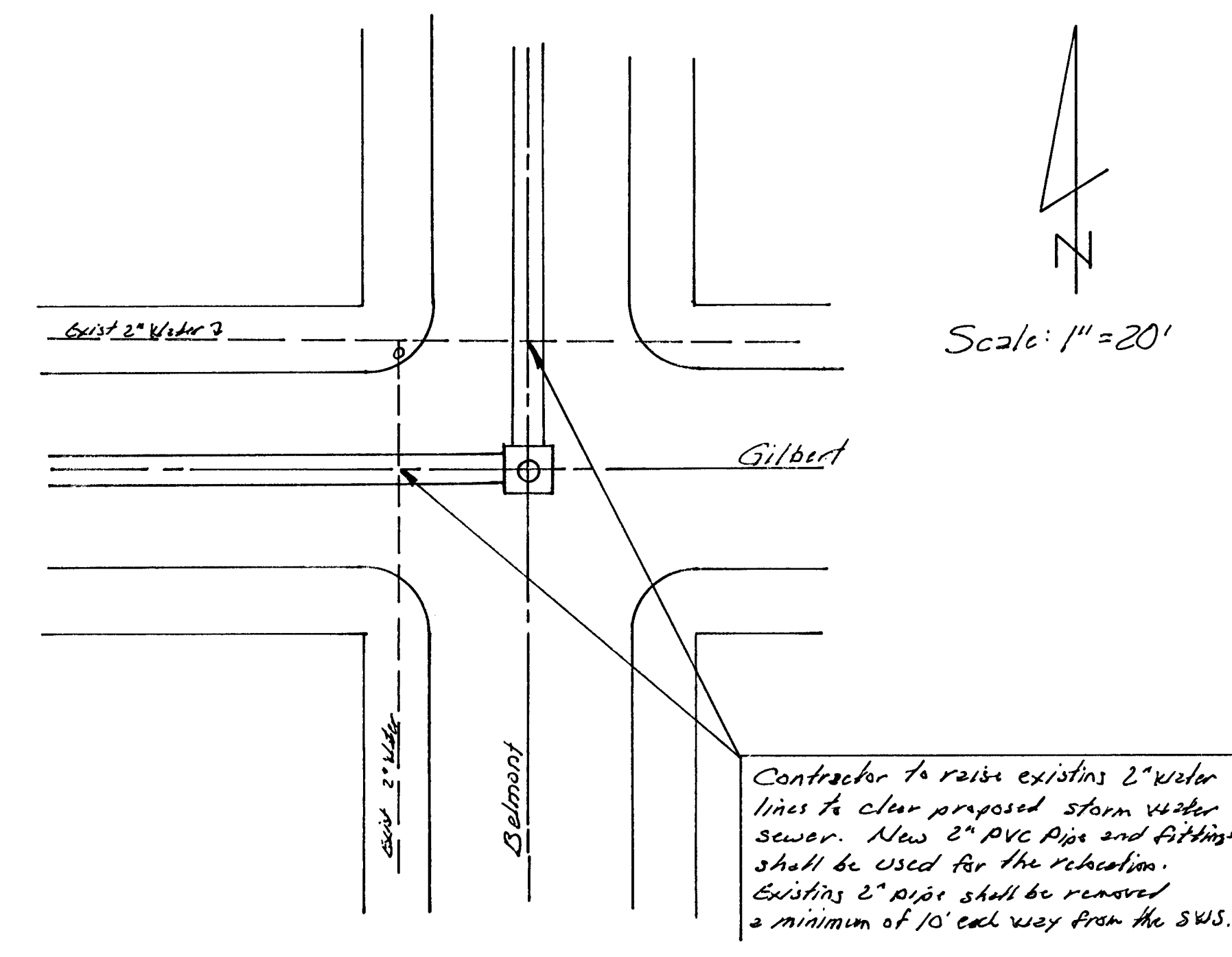

NOTE: 1. Contractor shall field verify existing water line locations and elevations prior to construction. New pipe shall be installed to clear the proposed SWS and provide a minimum of 3.5' of cover.
 2. For Water Assembly Details, See Sheet 37.

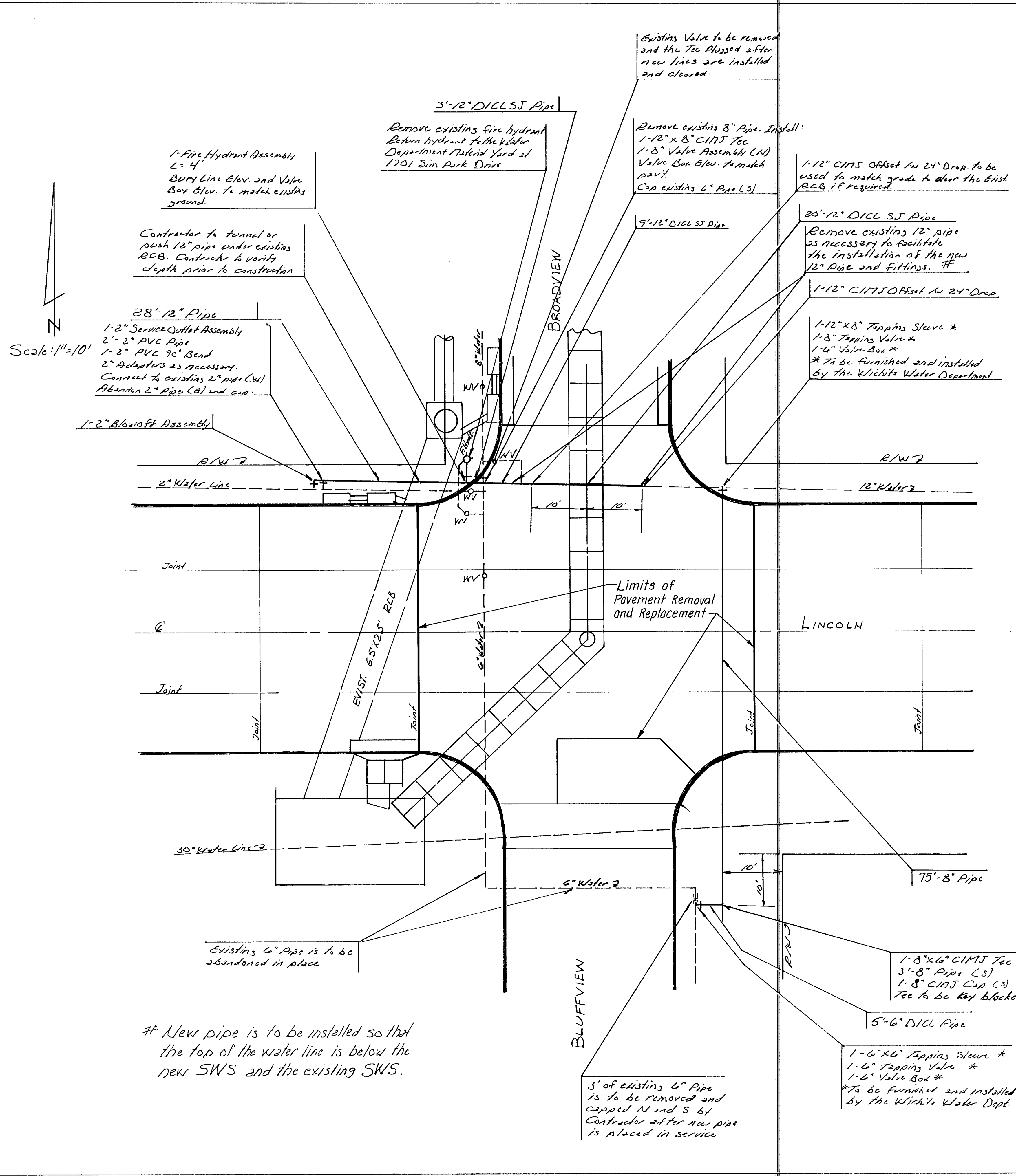
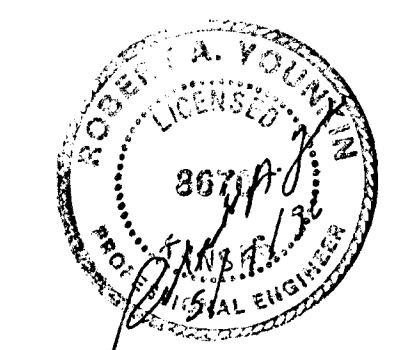

All material and installation methods shall be in conformance with Standard Specification #14533 for the installation of water mains for the City of Wichita.

CITY OF WICHITA
 RELOCATION AND ABANDONMENT
 OF EXISTING 12", 8", 6" AND 2"
 WATER MAINS AT LINCOLN AND
 BROADVIEW AND BELMONT AT GILBERT