

# LATERAL 40, DISTRICT 'T' SANITARY SEWER #20

## SANITARY SEWER EXTENSION TO SERVE

### LOT 36 MENLO PARK ADDITION

### PROJECT NO. 468-84968 OCA NO. 744369

#### GENERAL NOTES

- The Contractor shall comply with all applicable safety regulations and all current City of Wichita Standard Specifications and Special Provisions.
- Contractor will be required to provide notice to utility companies a minimum of seventy-two (72) hours prior to any excavation as follows:  
 Kansas One-Call 687-2470  
 The Contractor must notify the following in case of an emergency:  

Cox Communications	260-4270
Kansas Gas Service	1-888-482-4950
Westar	383-8650
Black Hills Energy	1-800-303-0357
AT&T	268-2245
City of Wichita Water Distribution	268-4563
City of Wichita Sewer Maintenance	268-4090
City of Wichita Stormwater Maint.	268-4090
City of Wichita Traffic Maint.	268-4034
Conoco Phillips Pipeline Co.	1-877-267-2290
Southern Star Pipeline Co.	529-6600
Kinder-Morgan Pipeline Co.	1-888-844-5658
- Utility service lines, poles, etc. are to be adjusted as necessary by others prior construction unless the plans specifically call for their adjustment by the Contractor or unless the plans specifically identify a utility to be adjusted by its owner during construction. Existing utilities and their location, as shown on the plans, represent the best information obtainable for design. The Contractor will be required to work around existing utilities within the right-of-way which do not conflict with proposed construction.
- Rubble from the removal of miscellaneous structures and excess excavation which is to be wasted shall be disposed of on sites to be provided by the Contractor. These sites shall be approved by the Engineer as to suitability, appearance and site location. Locations, in the opinion of the Engineer, that will leave an unsightly appearance will not be approved. All disposal sites must be approved by the Kansas Department of Health and Environment. Material either stockpiled or disposed of in a flood plain would require a Kansas State Board of Agriculture permit. Any material dumped in waters of the United States or wetlands is subject to U.S. Corps. of Engineers permitting regulations. Any material buried or stockpiled beyond approved construction limits would require additional archaeological investigations unless buried in a previously approved borrow location.
- Trees and shrubs in public right-of-way which are in direct conflict with proposed new construction shall be removed by the Contractor with the Engineer's approval. Trees and shrubs which are not in direct conflict with proposed new construction shall be saved and protected from damage.
- The Contractor shall give all property owners and/or tenants of developed property abutting the construction of this project a minimum of ten (10) days notice prior to start of construction.
- The Contractor shall be responsible for preserving property irons. The Contractor will be required to re-establish any property irons which are damaged or destroyed by his construction operations. Such irons shall be re-established by a licensed land surveyor in accordance with state laws.
- The water distribution department shall field locate water valves one time during construction when requested by the Contractor. It shall be the Contractor's responsibility to preserve such field locations during the construction process. Water valves, valve boxes or fire hydrants damaged during construction shall be repaired by Contractor at his own expense. Valve boxes and water meters within the Project limits shall be adjusted to match field grade.
- All elevations shown are U.S.G.S. Datum (NGVD 88).
- All areas disturbed during construction that will not be under proposed pavement shall be sodded.
- All Stubs and Plugged pipes shall be located with Green Plastic tape in the same manner as Risers.
- Connecting to Existing Manholes:  
 Prior to laying sewer lines using existing stubs in existing manholes, the Contractor shall expose and verify the Elevation, Grade and Alignment of Existing stubs and notify the Engineer of any deviation from the plan. Where connection to an existing manhole that does not have an existing stub or the stub is unusable due to elevation, grade, or alignment, the Contractor shall bore cut into existing manhole wall to make connection using approved water stop gasket, and reshape the existing manhole invert to provide smooth flow. The cost to connecting to existing manholes is incidental to the project.
- Contractor shall limit the extent of Trench open overnight and weekends to less than 50 feet.
- Contractor shall provide positive drainage away from all manhole covers.
- The Contractor shall prevent any construction debris from entering the existing sanitary sewer during construction.

Contractor: ..... Danco Enterprises  
 Foreman: ..... Robert Glasse  
 Inspector: ..... Tom Collins  
 Project Field Engineer: ..... Greg Baalman  
 Surveyor: ..... Bryce Kissinger

Pipe, 8", SDR35 ..... 18 lf.  
 Manhole, Standard, 4', Precast ..... 2 ea.  
 Sand Backfill, Flush & Vibrate ..... 18 lf.  
 Pavement Removed & Replaced ..... 12 lf.  
 Curb & Gutter Removed ..... 10 lf.

#### INDEX OF SHEETS

1. Titlesheet
2. Plan/Profile - LINE 1
3. Precast MH Details
4. MH Frame and Cover Details
5. Cleanout Riser Details
6. BMP

Release Date: 6/25/2015  
 : APRosas 7/13/2015

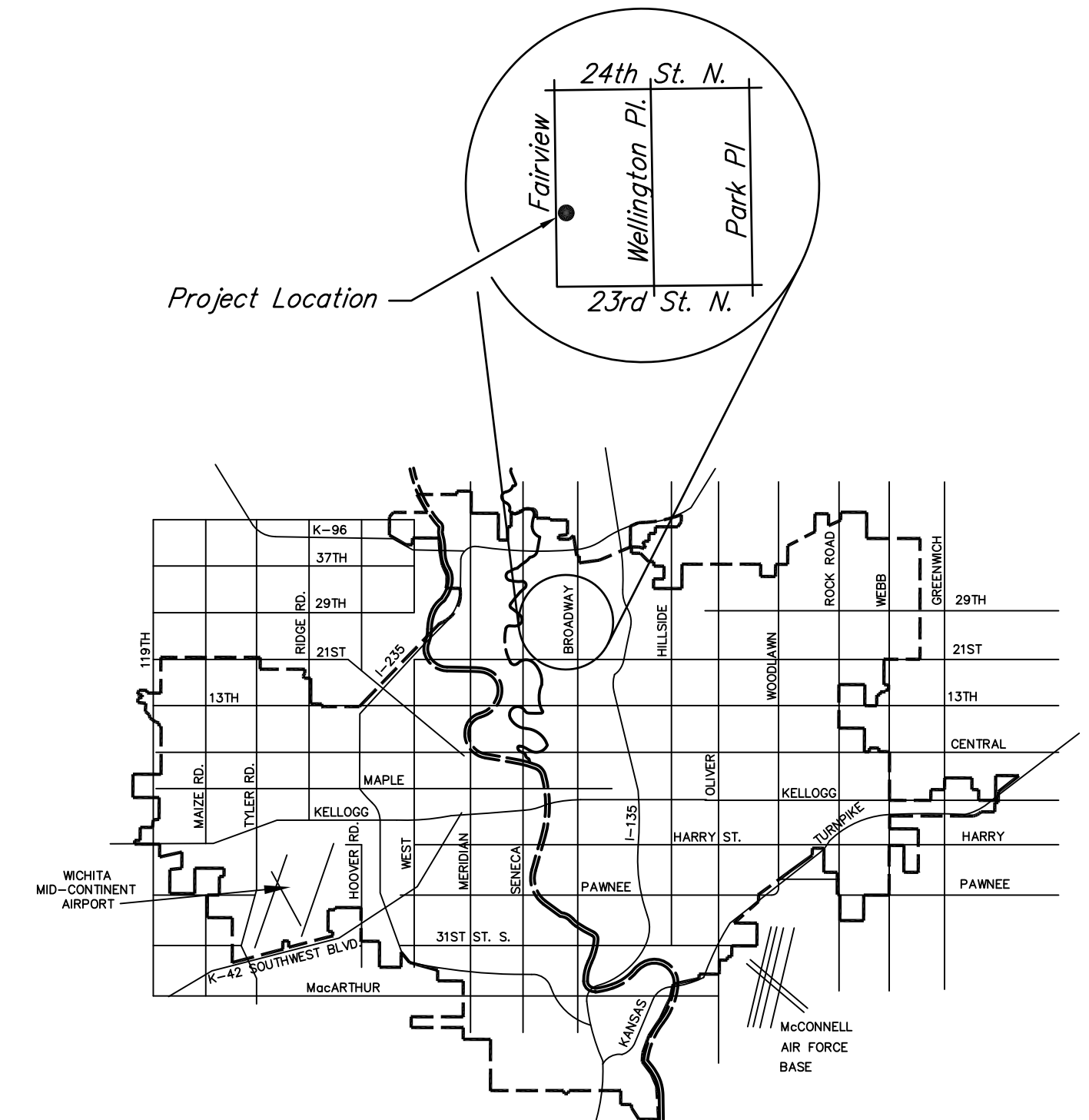
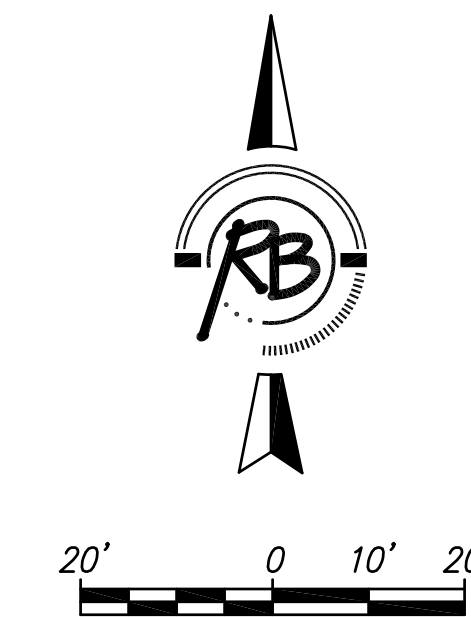
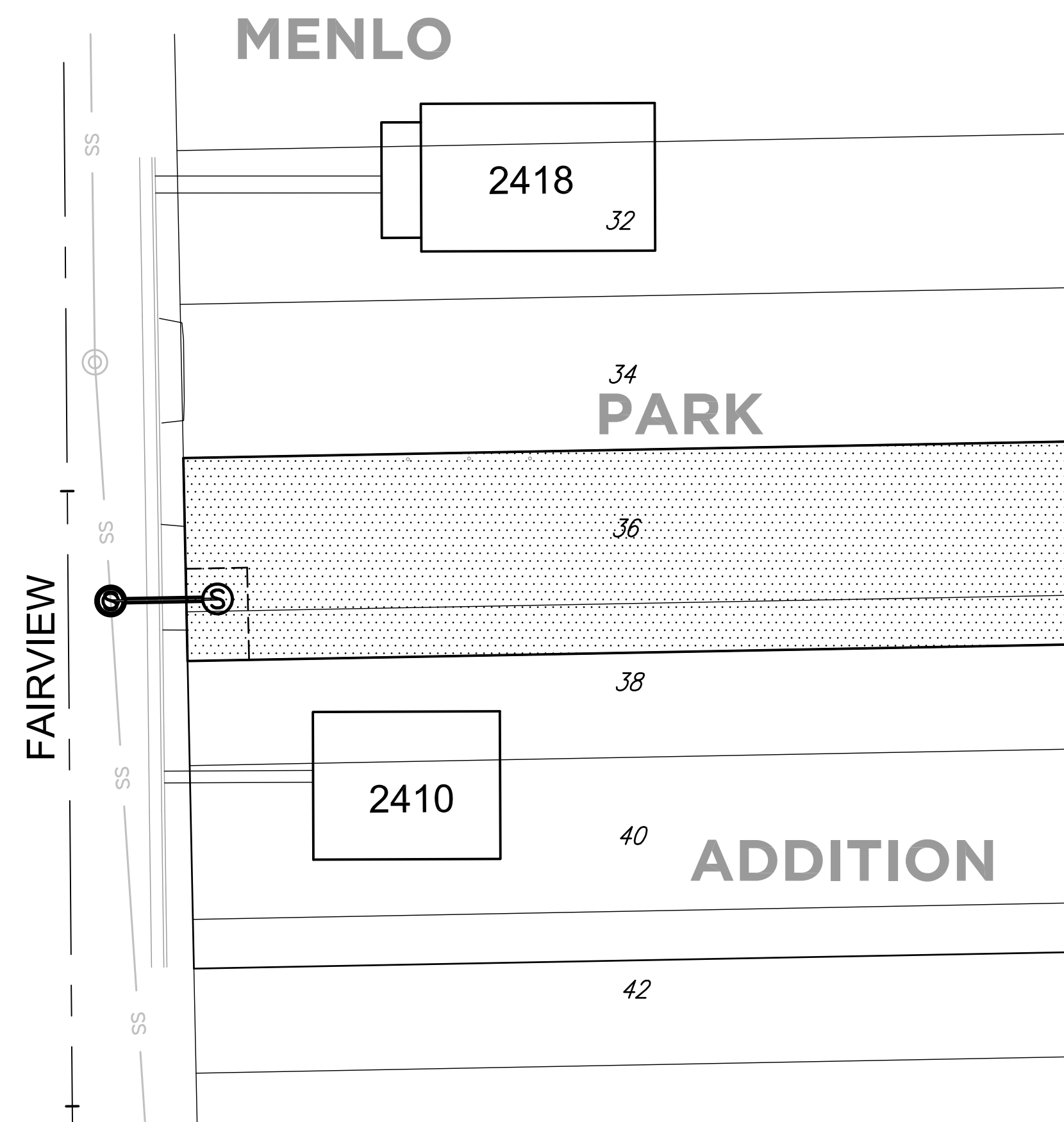

VICINITY MAP

- The Contractor shall be responsible for maintaining continuous flow of sewage through construction. Contractors proposed method for maintaining sewage flow shall be submitted and approved by the sewer maintenance division (316-268-4073) prior to starting and by-passing of sewage flows.
- Any over excavation from manhole and pipe removal shall be backfilled with AB-3 compacted to 90-95% ASTM D698.

CITY OF WICHITA, KANSAS  
 GARY JANZEN, P.E. - CITY ENGINEER



ENGINEERING | SURVEYING | LANDSCAPE ARCHITECTURE | GOVERNMENT  
 924 NORTH MAIN WICHITA, KANSAS 67203 P (316) 264-8008 F (316) 264-4621  
 WWW.RBKANSAS.COM



