

CHAPEL HILL

CITY OF WICHITA PRIVATE PROJECT

THE CITY OF WICHITA, KANSAS
 JAMES L. ARMOUR, CITY ENGINEER
 NO. 0133 PPD (607861)

Storm Water
 (Public Works)

[Signature] 11/28/12

Engineering

[Signature] 11-2-12

NOTE TO CONTRACTORS

Inspection and testing for the waterline is to be provided by a Licensed Consulting Engineering Firm under contract with the Owner/Developer. Said inspection to be in accordance with the City of Wichita Standard Construction Engineering Practices and certified by a Professional Engineer licensed in the state of Kansas. No work shall be performed in dedicated easements or public rights-of-way by the Contractor without such inspection, nor shall any work be commenced without written authorization by the City Engineer. All construction and materials shall comply with the City of Wichita Specifications and Standards (on file and available in the City Engineer's Office).

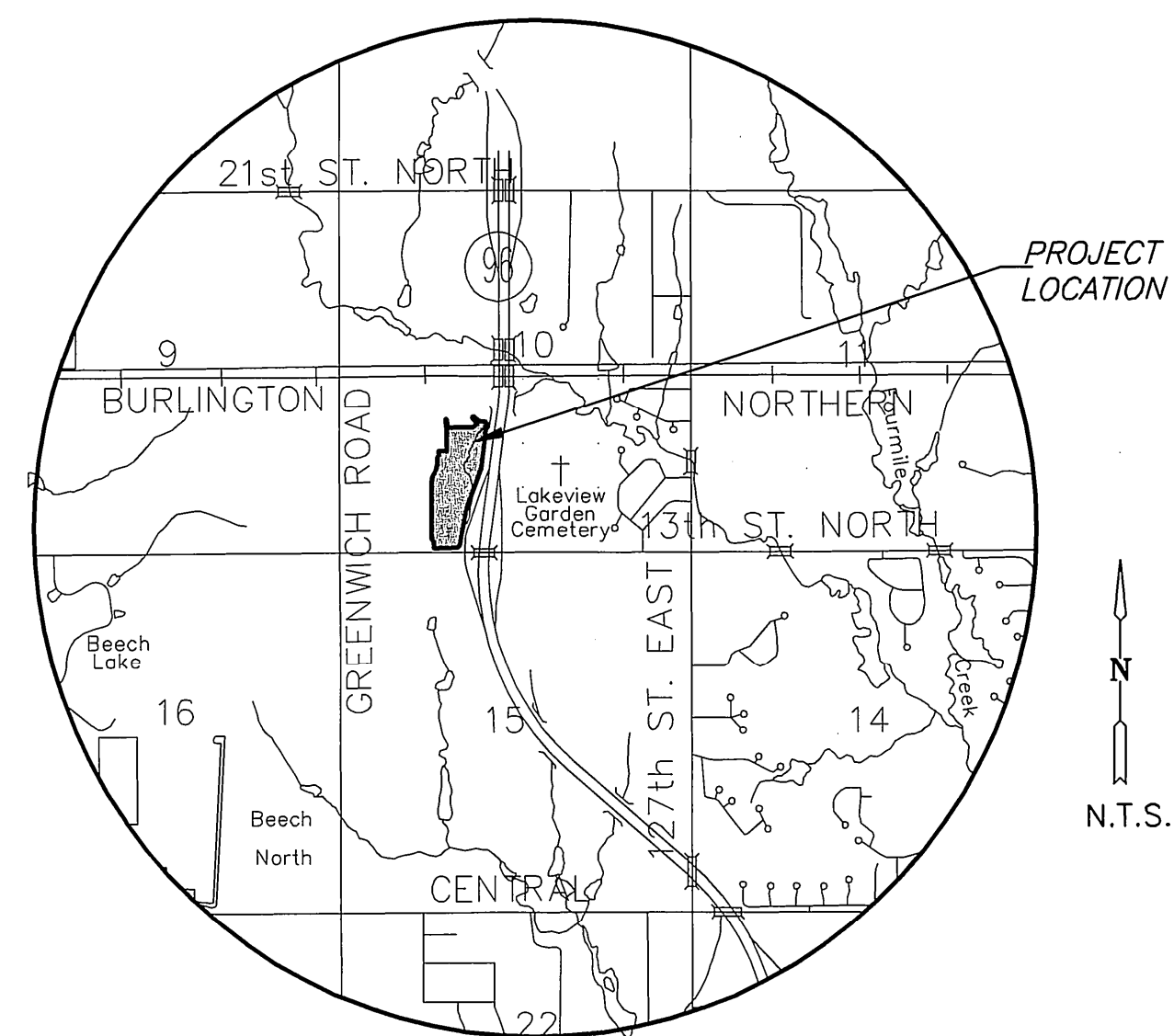

VICINITY MAP

DISTURBED PERVIOUS= 8.64 AC.
 PROPOSED IMPERVIOUS = 1.34 AC.
 WQV= 0.34 AC-FT
 CPV= 0.93 AC-FT

ELEVATION (FT.)	STORAGE (AC-FT.)	DISCHARGE (CFS)
1358	0	-
1359	2.38	1.67
1360	4.92	71.2
1361	7.65	100.8
1362	10.72	112.3

REMOVE EXISTING CATTLE GUARD GRATE PRIOR TO CUTTING NOTCH IN AREA INLET. GRATE TO BE REINSTALLED UPON COMPLETION OF NOTCH.

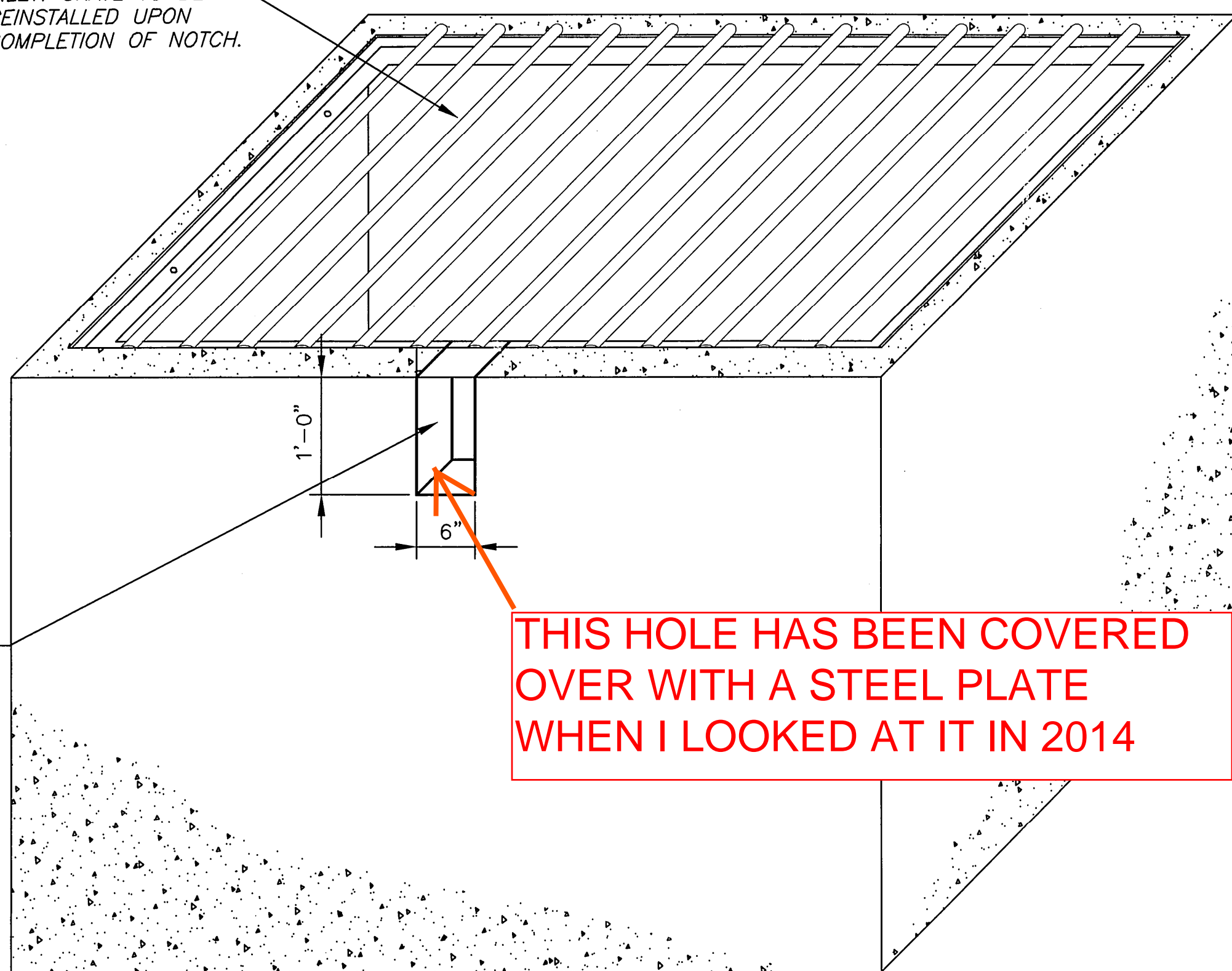

SAW CUT EXPOSED REBAR TO BE PROTECTED BY A THIN LAYER OF EPOXY

THIS HOLE HAS BEEN COVERED OVER WITH A STEEL PLATE WHEN I LOOKED AT IT IN 2014

STRUCTURE
 RIM ELEV.=1359.48
 INSIDE WIDTH=42"
 INSIDE LENGTH=78"
 DEPTH=5.21'
 PIPE 34"x53" ELLIPTICAL PIPE
 FL US=1354.27
 FL DS=1353.80

EXISTING DROP INLET

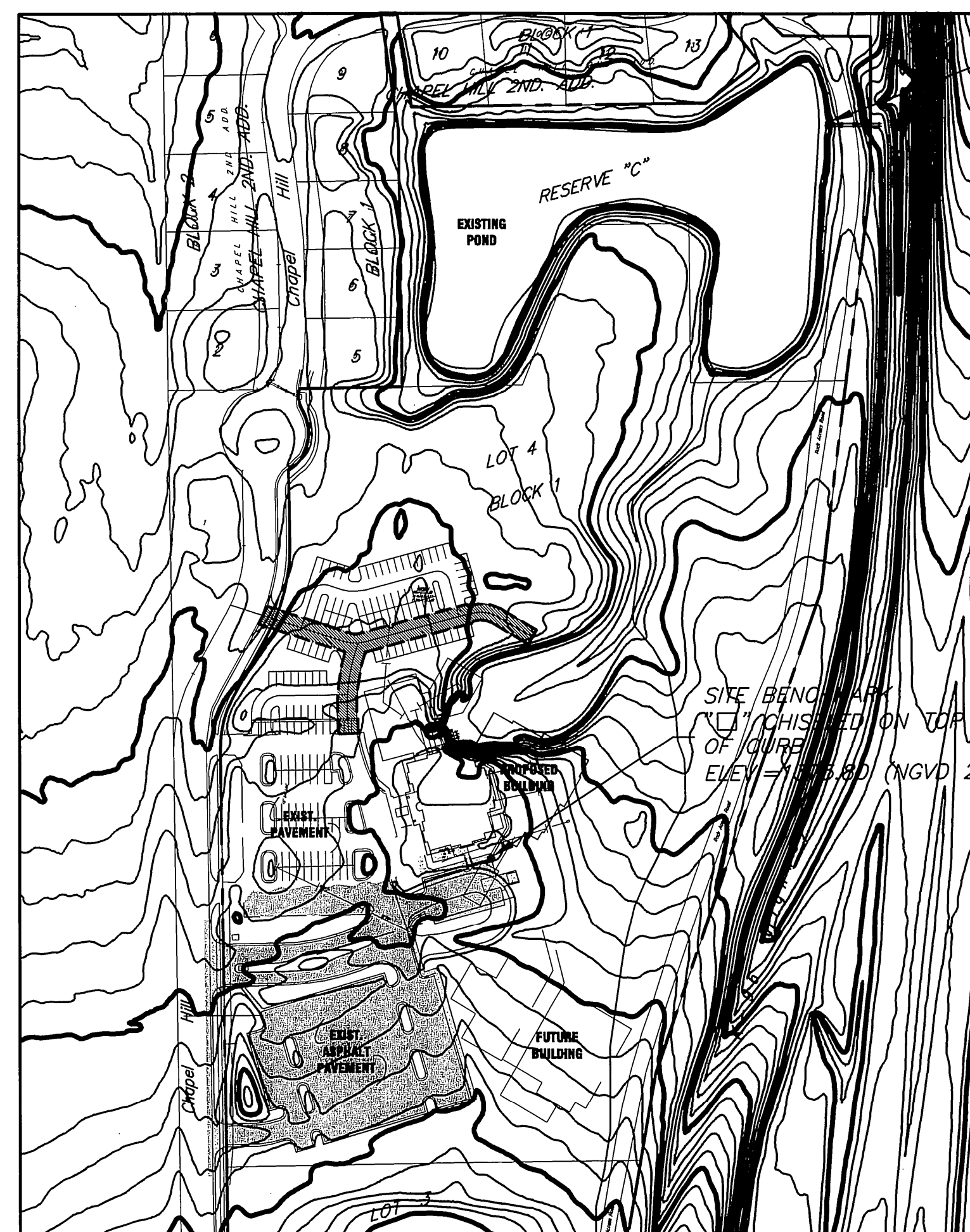

INLET TO BE MODIFIED

SITE BENCHMARK WITH THIS POINT ON TOP OF CURB ELEV=1353.80 (NGVD 29)

1"=150'

KEY MAP

MKEC
 ENGINEERING
 CONSULTANTS, INC.
 411 N. WEBB ROAD
 WICHITA, KS. 67206
 316-684-9600

JOSEPH KIRWAN
 LICENSED PROFESSIONAL ENGINEER
 20916
 11-1-12
 KANSAS

PPD FOR
Chapel Hill Fellowship UMC
 WICHITA, KANSAS

PPD PLAN
 SHEET TITLE
 1201060264
 PROJECT NUMBER

AJK / DM / GJA
 DESIGNED DRAWN CHECKED

ISSUED
 October 2012
 REVISED

SHEET NO.
 1 of 1

K:\PROJECTS\2012\1201060264_SUCF_WICHITA_CHAPEL_HILL_ADDITION\5-CIVIL\CAD\DRAWINGS\DRAWING_PPD_PLAN.DWG

PLOTTED: Friday, November 02, 2012 @ 11:01AM