

**GENERAL NOTES:**

1. WATERLINES AND APPURTENANCES SHALL BE INSTALLED IN ACCORDANCE WITH THE MOST RECENT EDITION OF THE CITY OF WICHITA STANDARD SPECIFICATIONS.

2. ALL ELEVATIONS SHOWN ARE BASED ON NAVD 88 DATUM.

3. CONTRACTOR WILL BE REQUIRED TO PROVIDE A MINIMUM ADVANCE NOTICE OF TWO FULL WORKING DAYS (48 HOURS) TO UTILITY COMPANIES PRIOR TO STARTING ANY EXCAVATION AS FOLLOWS:  
 KANSAS ONE CALL 1-800-344-7233  
 OR 1-316-887-2470

THE CONTRACTOR SHALL NOTIFY THE FOLLOWING IN CASE OF AN EMERGENCY:  
 COX COMMUNICATIONS 1-316-262-4270  
 OR 1-316-263-2061  
 AT&T 1-800-870-8390  
 KANSAS GAS SERVICE 1-888-482-4950  
 WESTAR 1-800-383-1183  
 BLACK HILLS ENERGY 1-800-303-0752  
 CITY OF WICHITA (WATER & SEWER) 1-316-268-4555

THE CONTRACTOR SHALL NOTIFY PIPELINE COMPANIES AT LEAST 24 HOURS IN ADVANCE OF ANY WORK BEING PERFORMED ACROSS AND/OR ADJACENT TO PIPELINES.

4. THE CONTRACTOR SHALL NOTIFY THE INSPECTOR FOR THIS PROJECT 48 HOURS PRIOR TO BEGINNING CONSTRUCTION. THE CONTRACTOR SHALL NOT START WORK ON THE PROJECT UNTIL THE PROJECT INSPECTOR ASSIGNED TO THE PROJECT IS PRESENT ON SITE. ANY WORK DONE WITHOUT INSPECTION WILL BE REQUIRED TO BE UNCOVERED FOR INSPECTION.

5. THE CONTRACTOR SHALL GIVE ALL PROPERTY OWNERS AND/OR TENANTS OF DEVELOPED PROPERTY DIRECTLY ABUTTING THE CONSTRUCTION OF THIS PROJECT A MINIMUM OF TEN (10) DAYS ADVANCE NOTICE PRIOR TO START OF CONSTRUCTION.

6. THE CONTRACTOR SHALL BE RESPONSIBLE FOR PRESERVING EXISTING PROPERTY IRONS AND RIGHT-OF-WAY MONUMENTS. THE CONTRACTOR SHALL BE REQUIRED TO RE-ESTABLISH ANY PROPERTY IRONS OR RIGHT-OF-WAY MONUMENTS WHICH ARE DAMAGED OR DESTROYED BY HIS CONSTRUCTION OPERATIONS. SUCH IRONS OR MONUMENTS SHALL BE RE-ESTABLISHED BY A LICENSED LAND SURVEYOR IN ACCORDANCE WITH STATE LAWS.

7. TRAFFIC AFFECTED BY THE CONSTRUCTION OF THIS PROJECT SHALL BE HANDLED IN ACCORDANCE WITH THE LATEST EDITION OF THE MANUAL ON UNIFORM TRAFFIC CONTROL DEVICES.

8. THE CONTRACTOR MUST EXAMINE THE CONSTRUCTION SITE PRIOR TO BIDDING AND BE SATISFIED AS TO THE WORK SHOWN FOR COMPLETION. AFTER BIDS HAVE BEEN RECEIVED, THE CONTRACTOR SHALL NOT ASSERT THAT THERE WAS A MISUNDERSTANDING OF THE QUANTITIES OF WORK OR OF THE NATURE FOR THE WORK TO BE COMPLETED

9. COST OF EXCAVATION, HAULING, AND DUMPING OF EXCESS EXCAVATION SHALL BE SUBSIDIARY TO OTHER ITEMS OF WORK.

10. SEEDING AND FERTILIZING OF ALL AREAS DISTURBED BY THE CONSTRUCTION OF THE WATERLINE AS SHOWN ON THE PLANS SHALL BE CONSIDERED SUBSIDIARY TO OTHER ITEMS OF WORK.

11. THE CONTRACTOR SHALL RESTORE ALL DITCHES, SWALES, ROAD SHOULDERS, ENTRANCES AND BANK LINES TO THEIR ORIGINAL SLOPES AND GRADES EXCEPT AS SHOWN OTHERWISE. ALL AREAS DISTURBED BY CONSTRUCTION INCLUDING STAGING AREAS, SHALL BE REPLANTED WITH GRASS SEED AT THE APPROPRIATE RATES APPROVED BY THE ENGINEER.

12. RUBBLE FROM THE REMOVAL OF MISCELLANEOUS STRUCTURES AND EXCESS EXCAVATION WHICH IS TO BE WASTED SHALL BE DISPOSED OF ON SITES TO BE PROVIDED BY THE CONTRACTOR. THESE SITES SHALL BE APPROVED BY THE ENGINEER AS TO SUITABILITY, APPEARANCE AND SITE LOCATION. LOCATIONS, THAT IN THE OPINION OF THE ENGINEER, WILL LEAVE AN UNSIGHTLY APPEARANCE WILL NOT BE APPROVED. ALL DISPOSAL SITES MUST BE APPROVED BY THE KANSAS DEPARTMENT OF HEALTH AND ENVIRONMENT. MATERIAL EITHER STOCKPILED OR DISPOSED OF IN A FLOODPLAIN WOULD REQUIRE A KANSAS STATE BOARD OF AGRICULTURE PERMIT. ANY MATERIAL DUMPED IN WATERS OF THE UNITED STATES OR WETLANDS IS SUBJECT TO U.S. CORPS OF ENGINEERS PERMITTING REGULATIONS. ANY MATERIAL BURIED OR STOCKPILED BEYOND APPROVED CONSTRUCTION LIMITS WOULD REQUIRE ADDITIONAL ARCHAEOLOGICAL INVESTIGATIONS UNLESS BURIED IN A PREVIOUSLY APPROVED BORROW LOCATION.

13. PAVED SURFACES OR SIDEWALK AREAS REMOVED FOR THE CONSTRUCTION OF THIS PROJECT SHALL BE REPLACED AT THE CONTRACTORS EXPENSE.

14. TREES IN CONFLICT WITH CONSTRUCTION SHALL BE REMOVED OR TRIMMED AS NECESSARY AT THE CONTRACTORS EXPENSE.

15. EXISTING UTILITIES AND THEIR LOCATION, AS SHOWN ON THE PLANS, REPRESENT THE BEST INFORMATION AVAILABLE FOR DESIGN. LOCATION INFORMATION HAS BEEN OBTAINED FROM THE VARIOUS UTILITY COMPANIES AND IS EITHER FROM COMPANY RECORD DRAWINGS OR COMPANY PROVIDED FIELD LOCATIONS. THE PLAN LOCATIONS ARE NOT GUARANTEED. ADDITIONAL EXISTING UTILITIES MAY ALSO BE ENCOUNTERED. THE CONTRACTOR WILL BE REQUIRED TO WORK AROUND EXISTING UTILITIES WHICH ARE ENCOUNTERED ON THIS PROJECT. THE CONTRACTOR SHALL EXERCISE EXTREME CAUTION DURING TRENCHING OPERATIONS TO AVOID DAMAGING THESE LINES. ANY LINES DAMAGED SHALL BE REPLACED OR REPAIRED IMMEDIATELY AS DIRECTED BY THE ENGINEER AT THE CONTRACTOR'S EXPENSE.

16. PROPERTIES WITHIN THE PROJECT LIMITS MAY HAVE UNDERGROUND SPRINKLER SYSTEMS IN THE PUBLIC RIGHT-OF-WAY WHICH CONFLICT WITH NEW CONSTRUCTION. CONTRACTOR WILL BE REQUIRED TO REMOVE SUCH IMPROVEMENTS SHOULD THEY NOT BE REMOVED BY THEIR OWNER AT THE TIME OF CONSTRUCTION OF THE PROJECT. THE CONTRACTOR WILL BE REQUIRED TO SALVAGE ALL SPRINKLER HEADS AND/OR VALVES AND GIVE SUCH MATERIAL TO THEIR OWNER. PORTIONS OF UNDERGROUND SPRINKLER SYSTEMS NOT IN CONFLICT WITH NEW CONSTRUCTION SHALL BE PROTECTED FROM DAMAGE AND SHALL REMAIN IN PLACE. ALL WORK IN CONNECTION WITH UNDERGROUND SPRINKLER SYSTEMS SHALL BE CONSIDERED AS SUBSIDIARY TO THE CONTRACT PAY ITEMS OF WORK.

17. THE CONTRACTOR SHALL INSTALL DEWATERING SYSTEMS AS NECESSARY TO KEEP TRENCHES FREE OF WATER. IN NO CIRCUMSTANCE WILL PIPE BE LAID IN STANDING WATER. DEWATERING SYSTEMS SHALL REMAIN IN OPERATION UNTIL THE TRENCH HAS BEEN BACKFILLED. THE COST FOR THIS WORK SHALL BE SUBSIDIARY TO THE INSTALLATION OF THE PIPE.

18. THE CONTRACTOR WILL DELIVER REMOVED FIRE HYDRANTS TO WATER DISTRIBUTION, 1703 SIM PARK DRIVE.

19. THE CONTRACTOR SHALL VERIFY HORIZONTAL AND VERTICAL LOCATION, TYPE, SIZE, AND CLASS OF EXISTING WATERLINES PRIOR TO CONSTRUCTION. EXISTING WATERLINE LOCATIONS AS SHOWN ON THE PLANS ARE APPROXIMATE. THE CONTRACTOR SHALL MAKE ADJUSTMENTS AS REQUIRED AND APPROVED BY THE ENGINEER. PROVISIONS FOR AND INSTALLATION OF PIPE ADAPTORS, SHORT SECTIONS OF PIPE, AND COUPLERS SHALL BE SUBSIDIARY TO OTHER PAY ITEMS OF WORK.

20. OPENING AND CLOSING WATER VALVES SHALL BE DONE SLOWLY TO PREVENT DAMAGE TO THE WATER DISTRIBUTION SYSTEM FROM WATER HAMMER. ALL VALVES CLOSED BY THE CONTRACTOR MUST BE REOPENED AS NEW CONSTRUCTION PERMITS. PROJECT INSPECTOR MUST ASCERTAIN THAT ANY VALVE CLOSED BY THE CONTRACTOR IS REOPENED. CONTRACTOR WILL BE PERMITTED TO OPERATE WATER VALVES ONLY WHEN THE PROJECT INSPECTOR ASSIGNED TO THE PROJECT IS PRESENT.

21. INSPECTOR WILL NOTE ON AS BUILT PLAN LOCATIONS OF ALL FITTINGS AND VALVES. LOCATIONS WILL BE MEASURED FROM PROPERTY LINES, CURB LINES, AND/OR CENTER LINES. HYDRANT BRANCH LENGTH AND HYDRANT BURY LINE ELEVATION ARE TO MATCH FIELD CONDITIONS AND BE APPROVED BY THE ENGINEER.

22. ALL PIPE JOINTS SHALL BE LAID AND PUSHED 'FULL HOME', WITH THE BEVELED END OF THE SPIGOT MAKING FULL CONTACT WITH THE CHAMFERED AREA AT THE THROAT OF THE BELL OR SOCKET, WITH NO SEPARATION BETWEEN THEM. IF SEPARATION IS DETERMINED, THE PIPE SHALL BE EXCAVATED AND RE-LAID ACCORDING TO SPECIFICATIONS AT THE CONTRACTOR'S EXPENSE.

# FIRE HYDRANT PRIVATE PROJECT PLANS FOR LOT 1, BLOCK 1, MILLER HEIGHTS ADDITION WICHITA, SEDGWICK COUNTY, KANSAS 1813 PPW (O.C.A. NO. 607853) GARY JANZEN, P.E., CITY ENGINEER JUNE 2014

**AS-BUILT PLANS**  
 Contractor: CK Contracting  
 Inspector: Levi Turner, Ruggles & Bohm  
 .pdf Date: 02/26/2015

SHEET INDEX	
Sheet Number	Sheet Title
1	Cover Sheet
2	Site Plan
3	Plan & Profile
4	Water Details
5	Miscellaneous Water Details

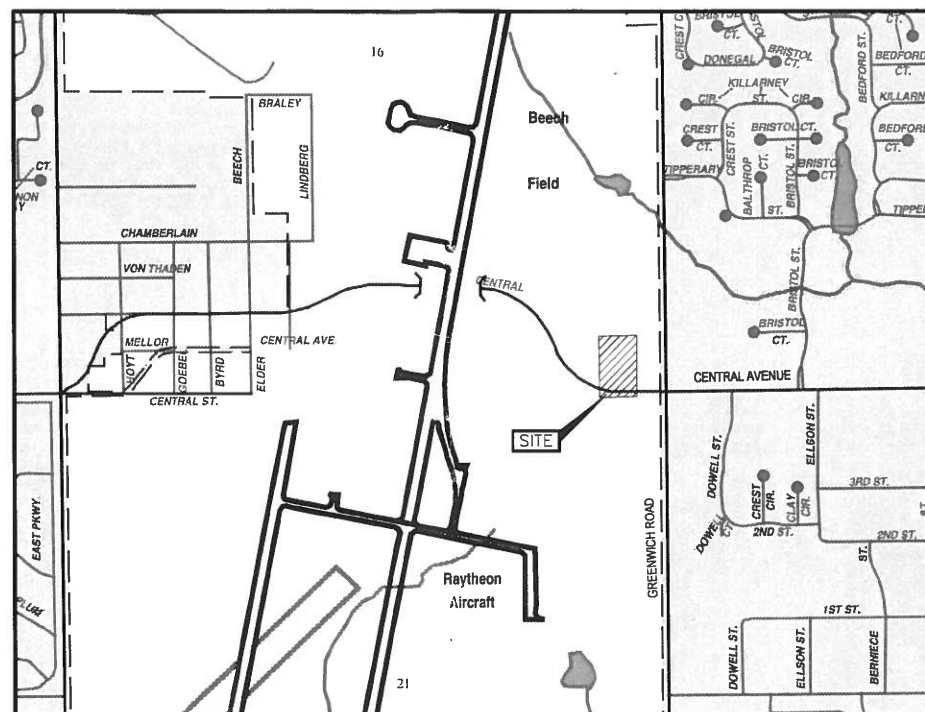

Vicinity Map  
 Not to Scale

22117

SITE BENCHMARK:  
 SQUARE CUT ON TOP OF CURB 30.0'  
 SOUTH OF THE S.E. CORNER OF LOT 1,  
 BLOCK 1, MILLER HEIGHTS ADDITION  
 ELEVATION = 1376.34 (NAVD88)

LEGAL DESCRIPTION:  
 LOT 1, BLOCK 1, MILLER HEIGHTS  
 ADDITION, WICHITA, SEDGWICK  
 COUNTY, KANSAS.



APPROVED AS NOTED  
 BY CITY ENGINEER OF WICHITA  
 & BY WICHITA FIRE DEPARTMENT

Water Mains (Engineering) *Rebecca Aul* 6/27/14  
 Water Mains (Water) *Ang Tolly* 6-27-14  
 Fire Prot. Line *Don* 6-26-14

NOTE TO CONTRACTORS

**PUBLIC PROPERTY:**  
 Inspection and testing for the waterline is to be provided by a Licensed Consulting Engineering Firm under contract with the Owner/Developer. Said inspection is to be in accordance with the City of Wichita standard construction engineering practices and certified by a Licensed Professional Engineer licensed in the State of Kansas. No work shall be performed in dedicated easements or public right-of-way by the Contractor without such inspection nor shall any work be commenced without written authorization by the City Engineer. All Construction and Materials shall comply with the City of Wichita Specifications and Standards (on file and available in the City Engineer's Office).

**PRIVATE PROPERTY:**  
 Installation and testing for the fire protection line is to be performed by a City of Wichita licensed fire protection contractor in accordance with the fire codes as adopted by the City of Wichita. All materials and construction practices for the fire protection line shall comply with the fire codes as adopted by the City of Wichita (available from the City of Wichita Fire Department). The Contractor shall not commence work without notification and approval of the Wichita Fire Department.  
 Inspection of the fire protection line is to be provided by the City of Wichita Fire Department and by a licensed Consulting Engineering Firm under contract with the Owner/Developer.  
 The contractor shall not start work until the project inspector is assigned to the project and present on the site. Any work done without inspection will be required to be uncovered for inspection.

REV.	DESCRIPTION	DATE

**PAPA JOHNS  
 WAREHOUSE**  
 11018 E. CENTRAL AVENUE  
 WICHITA, SEDGWICK COUNTY, KANSAS

CERTIFIED ENGINEERING DESIGN, P.A.  
 CIVIL ENGINEERING

**CED**

1935 WEST MAPLE  
 WICHITA, KANSAS 67213  
 PH.(316)262-8808 FAX.(316)262-1669



PRELIMINARY PLANS

PROJECT NO.: 20142159  
 ISSUE DATE: JUNE 2014  
 CONTACT: H. FORAKER, L. MILLS  
 CHECKED BY:

COVER SHEET

1 OF 5

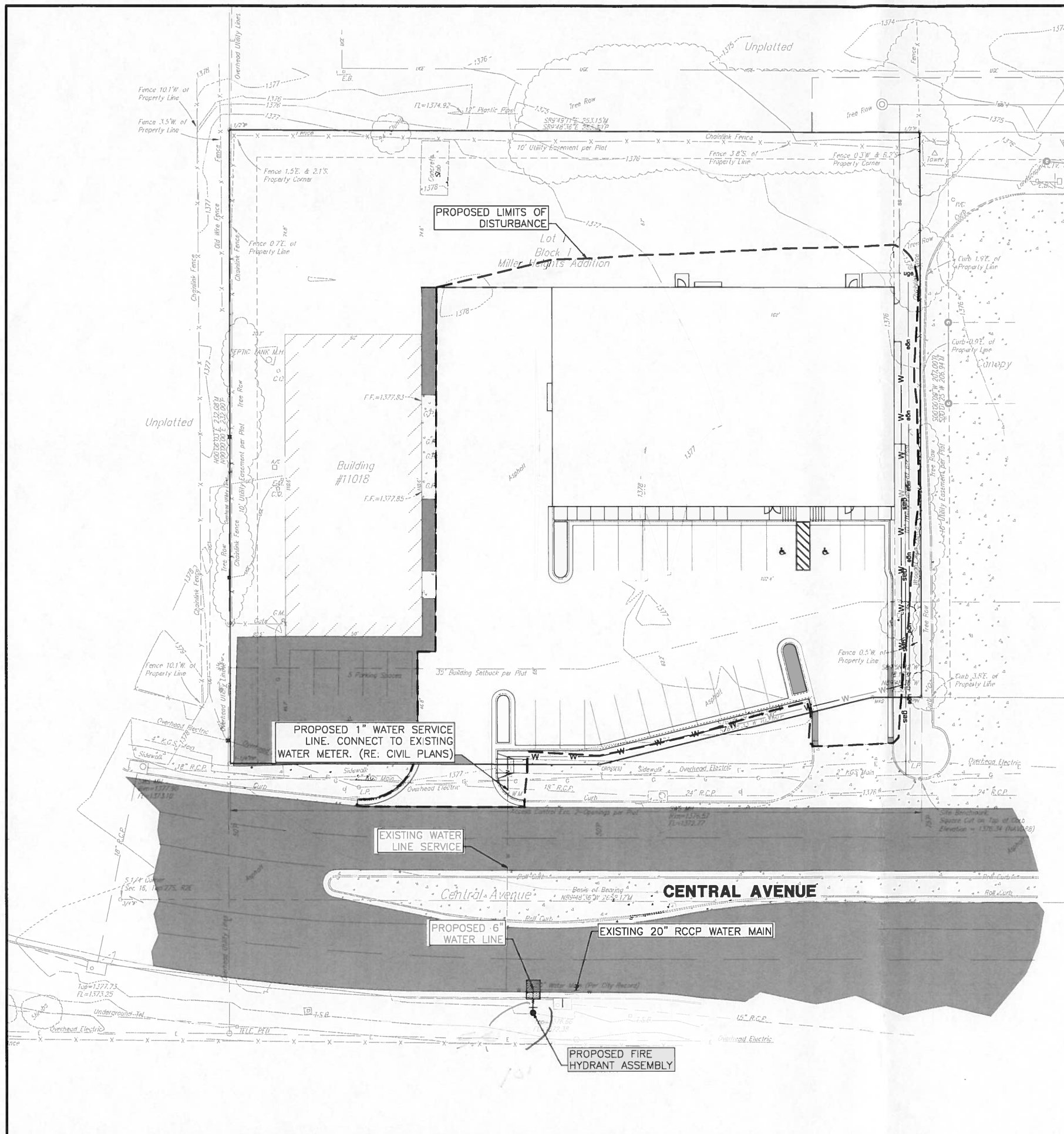

**AS-BUILT PLANS**  
 Contractor: CK Contracting  
 Inspector: Levi Turner, Ruggles & Bohm  
 .pdf Date: 02/26/2015

REV.	DESCRIPTION	DATE

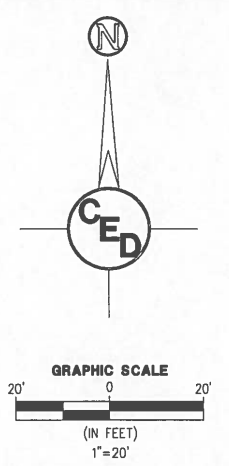

**PAPA JOHNS WAREHOUSE**  
 11018 E. CENTRAL AVENUE  
 WICHITA, SEDGWICK COUNTY, KANSAS

CERTIFIED ENGINEERING DESIGN, P.A.  
 CIVIL ENGINEERING



1935 WEST MAPLE  
 WICHITA, KANSAS 67213  
 PH.(316)262-8808 FAX.(316)262-1669



PRELIMINARY PLANS

PROJECT NO.: 20142159  
 ISSUE DATE: JUNE 2014  
 CONTACT: H. FORAKER, L. MILLS  
 CHECKED BY:

SITE PLAN

**SITE BENCHMARK:**  
 SQUARE CUT ON TOP OF CURB 30.0'  
 SOUTH OF THE S.E. CORNER OF LOT 1,  
 BLOCK 1, MILLER HEIGHTS ADDITION  
 ELEVATION = 1376.34 (NAVD88)

**SURVEY DISCLAIMER:**  
 TOPOGRAPHIC SURVEY AND CONTOUR MAP USED IN  
 PREPARING PLANS WAS PROVIDED BY SAVOY  
 COMPANY, P.A., 433 S. HYDRAULIC, WICHITA, KS.  
 ENGINEER DOES NOT GUARANTEE SURVEY  
 ELEVATIONS FOR ACCURACY. CONTRACTOR SHALL  
 VERIFY ELEVATIONS AND NOTIFY ENGINEER OF ANY  
 DISCREPANCIES.

UTILITIES SHOWN REPRESENT THE BEST  
 INFORMATION AVAILABLE FOR DESIGN. ADDITIONAL  
 UTILITIES MAY BE PRESENT ON THIS PROJECT.  
 THE CONTRACTOR SHALL BE RESPONSIBLE FOR  
 DETERMINING THE EXACT LOCATION, DEPTH AND  
 SIZE OF ALL UNDERGROUND UTILITIES PRIOR TO  
 CONSTRUCTION. THE CONTRACTOR SHALL BE  
 LIABLE FOR ANY DAMAGE CAUSED BY THE  
 FAILURE TO DO SO.



**AS-BUILT PLANS**  
 Contractor: CK Contracting  
 Inspector: Levi Turner, Ruggles & Bohm  
 .pdf Date: 02/26/2015

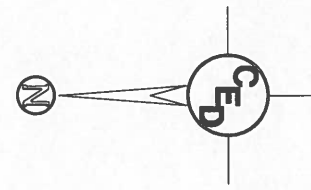

**SITE BENCHMARK:**  
 SQUARE CUT ON TOP OF CURB 30.0'  
 SOUTH OF THE S.E. CORNER OF LOT 1,  
 BLOCK 1, MILLER HEIGHTS ADDITION  
 ELEVATION = 1376.34 (NAVD88)

**GENERAL NOTES**  
 CUTS MADE TO PAVED SURFACES ON PUBLIC PROPERTY WILL BE REPAIRED BY THE CITY'S CONTRACTOR AND CHARGED AGAINST THE OWNER/APPLICANT. UNIT REPAIR PRICES ARE AVAILABLE FROM THE CITY AT (316)268-4418. A SURCHARGE MAY BE APPLICABLE; CALL (316)268-4118 FOR DETAILS. REPAIR COSTS TO BE PAID PRIOR TO RELEASE OF WATER SERVICE IF WATER SERVICE IS AFFECTED.

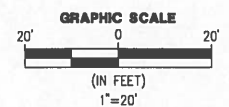

**SURVEY DISCLAIMER:**  
 TOPOGRAPHIC SURVEY AND CONTOUR MAP USED IN PREPARING PLANS WAS PROVIDED BY SAVOY COMPANY, P.A., 433 S. HYDRAULIC, WICHITA, KS. ENGINEER DOES NOT GUARANTEE SURVEY ELEVATIONS FOR ACCURACY. CONTRACTOR SHALL VERIFY ELEVATIONS AND NOTIFY ENGINEER OF ANY DISCREPANCIES.



KS: 1-800-344-7233  
 WICHITA: 316-687-2470

UTILITIES SHOWN REPRESENT THE BEST INFORMATION AVAILABLE FOR DESIGN. ADDITIONAL UTILITIES MAY BE PRESENT ON THIS PROJECT. THE CONTRACTOR SHALL BE RESPONSIBLE FOR DETERMINING THE EXACT LOCATION, DEPTH AND SIZE OF ALL UNDERGROUND UTILITIES PRIOR TO CONSTRUCTION. THE CONTRACTOR SHALL BE LIABLE FOR ANY DAMAGE CAUSED BY THE FAILURE TO DO SO.

REV.	DESCRIPTION	DATE

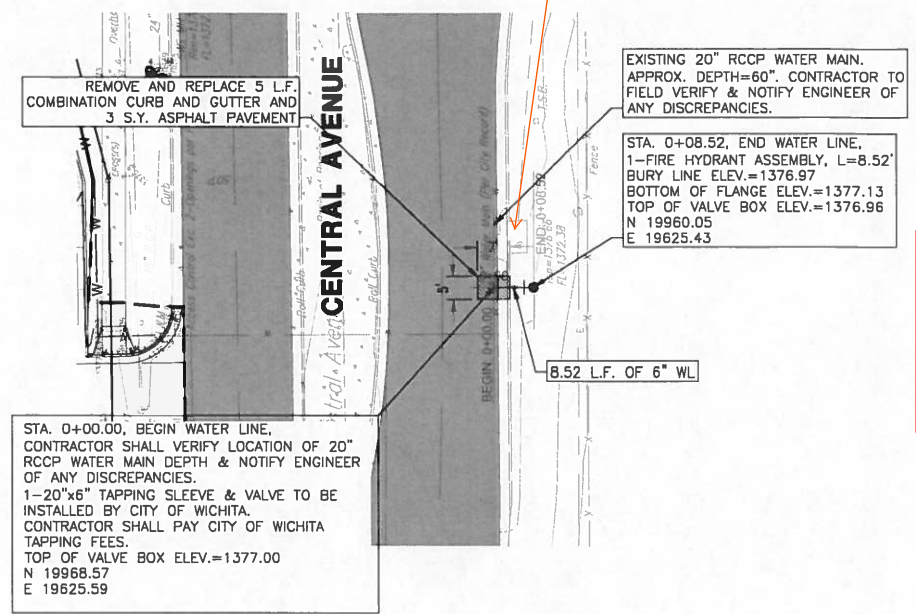

American Darling FH  
 Fire Hydrant valve is 5' south of FH,  
 valve is in the back of the curb.

Fire Hydrant is 36' south & 371' west of center line of Central & Greenwich.  
 Fire Hydrant is also 142' west of the center of the 2nd SWS inlet on south side of Central west of Greenwich and also 11' west of central of the 3rd SWS inlet on south side of Central west of Greenwich.

UNLESS NOTED OTHERWISE, ELEVATIONS SHOWN ARE TO TOP OF PIPE.

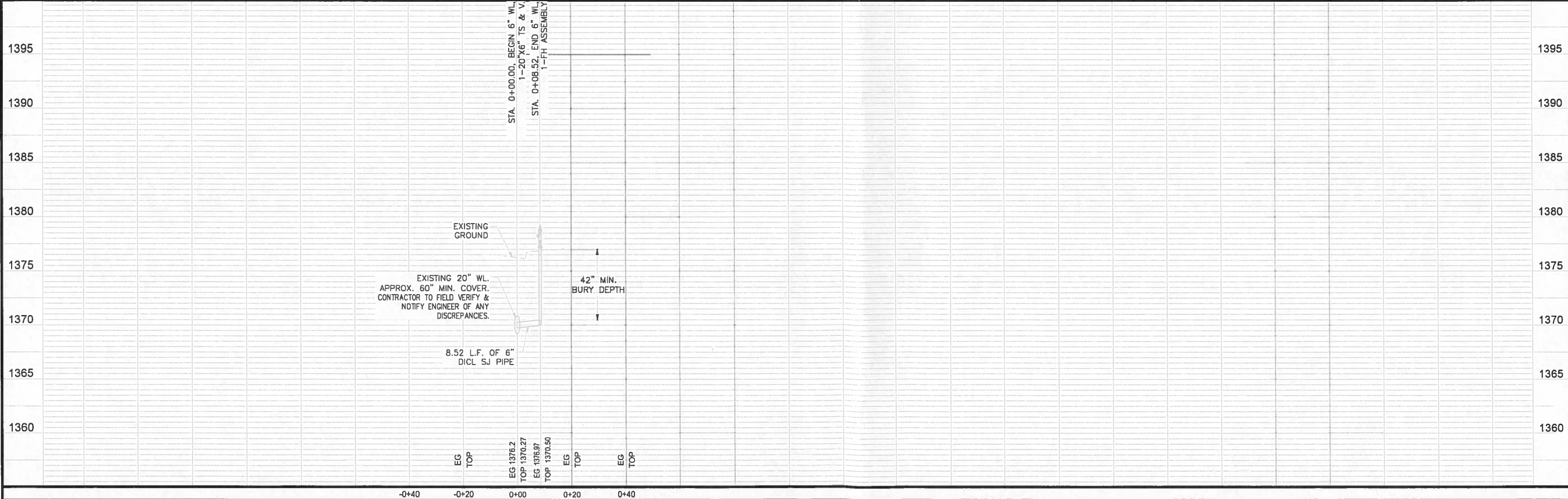

**PAPA JOHNS WAREHOUSE**  
 11018 E. CENTRAL AVENUE  
 WICHITA, SEDGWICK COUNTY, KANSAS

CERTIFIED ENGINEERING DESIGN, P.A.  
 CIVIL ENGINEERING  
  
 1935 WEST MAPLE  
 WICHITA, KANSAS 67213  
 PH.(316)262-8808 FAX.(316)262-1669

PRELIMINARY PLANS  
 PROJECT NO.: 20142159  
 ISSUE DATE: JUNE 2014  
 CONTACT: H. FORAKER, L. MILLS  
 CHECKED BY:

PLAN & PROFILE  
 3 OF 5



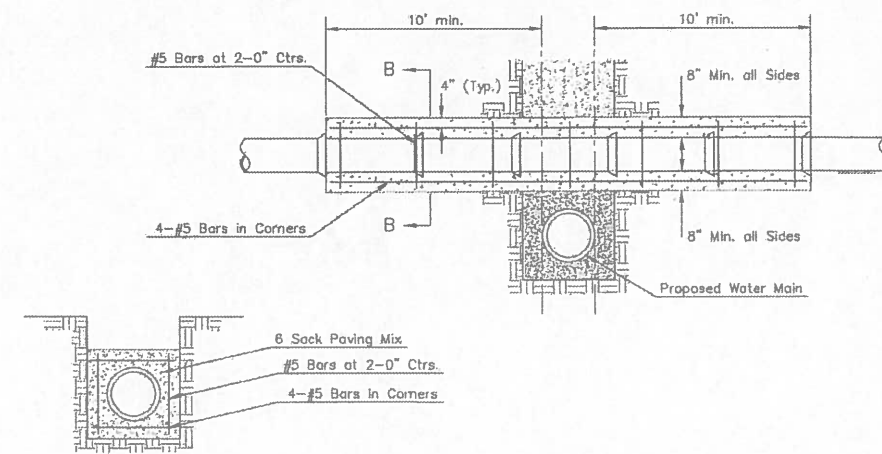
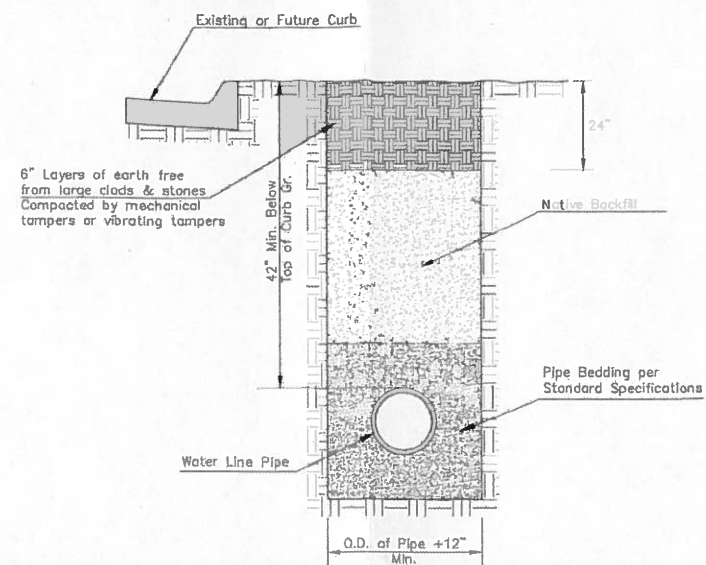
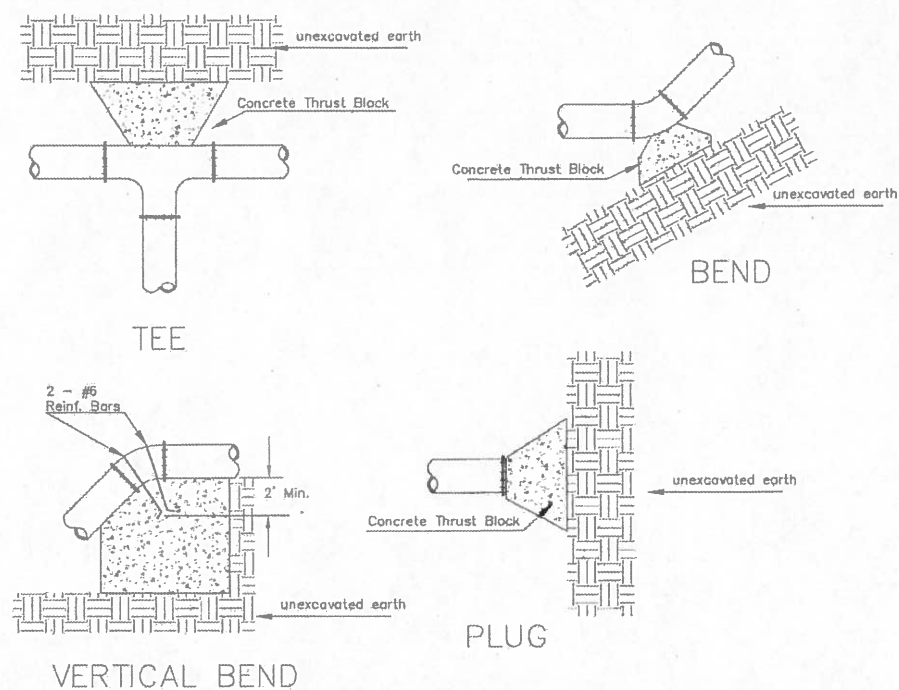

Note: Encasement to begin and end at a Bell on Sanitary Sewer Pipe.

SECTION B-B

REINFORCED CONCRETE ENCASEMENT OF SANITARY SEWER

PIPE SIZE	THRUST AT FITTINGS IN TONS—AT 150#/IN <sup>2</sup> P					
	PLUG	90°	45°	22 1/2°	11 1/4°	TEE
6"	2.8	3.95	2.15	1.09	.55	2.8
8"	4.9	6.95	3.75	1.90	.96	4.9
12"	11.4	16.1	8.75	4.45	2.25	11.4
16"	20.15	28.5	15.4	7.85	3.95	20.15
20"	31.15	44.0	23.85	12.15	6.10	31.15
24"	44.55	63.0	34.1	17.4	8.75	44.55

TYPICAL THRUST BLOCKS

**AS-BUILT PLANS**  
 Contractor: CK Contracting  
 Inspector: Levi Turner, Ruggles & Bohm  
 .pdf Date: 02/26/2015

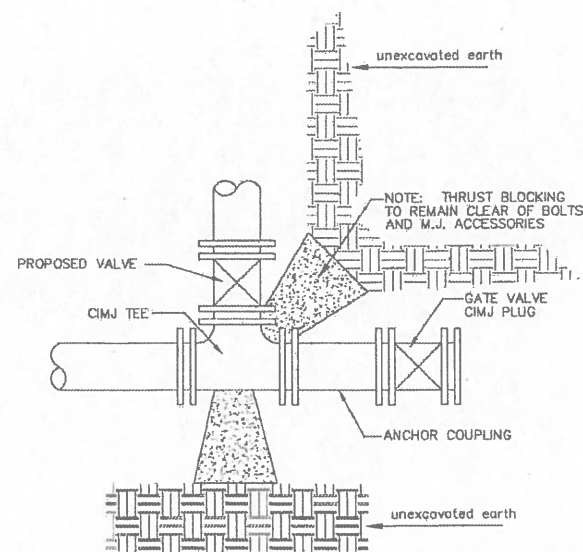

KEY BLOCK DETAIL

\* PLANS GOVERN UNLESS OTHERWISE NOTED ON PLANS

TRENCH COMPACTION IN ROAD RIGHT-OF-WAY

SIDE VIEW

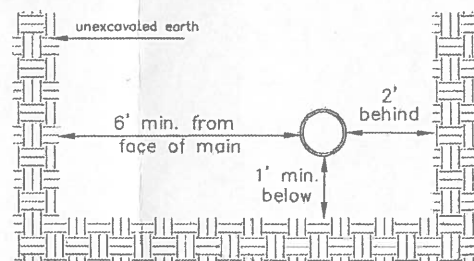

TOP VIEW

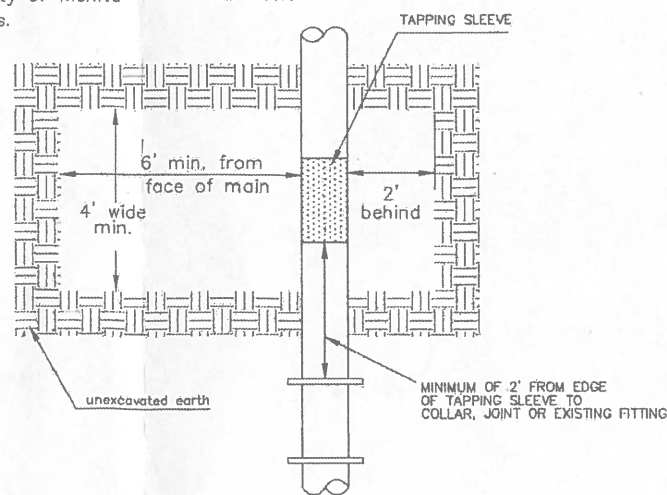

EXCAVATION FOR WET TAP

Note: When shoring is required it is to be per The City of Wichita Standard Specifications.

PAVEMENT REPLACEMENT & TRENCH COMPACTION UNDER EXISTING AND PROPOSED CITY ROADS

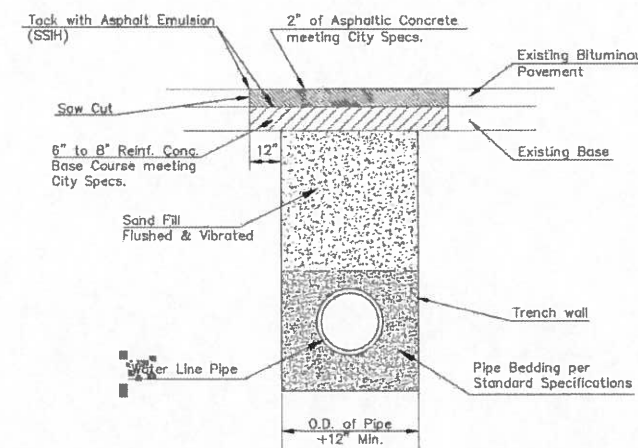

04/24/14

 <b>CITY OF WICHITA</b> PUBLIC WORKS & UTILITIES ENGINEERING DIVISION			<b>MISCELLANEOUS WATER DETAILS</b> CITY ENGINEER <b>GARY JANZEN, P.E.</b>	
			PROJECT NUMBER 1813 PPW	OCA NUMBER 607853
CITY ENGINEER'S OFFICE CITY HALL - SEVENTH FLOOR 455 NORTH MAIN STREET WICHITA, KANSAS 67202-1620 (316) 268-4501			SHEET <b>5 of 5</b>	