

BENCHMARKS:

BM #1: "□" cut in top of curb near intersection of 27th Street North & Woodridge, south of SE corner of Lot 24, Block C, Woods North 3rd Addition.
Elev. = 1392.97 NGVD29

BM #2: "□" cut in top of curb near intersection of Woodridge Court & Woodridge, south of SE corner of Lot 6, Block A, Woods North 3rd Addition.
Elev. = 1390.10 NGVD29

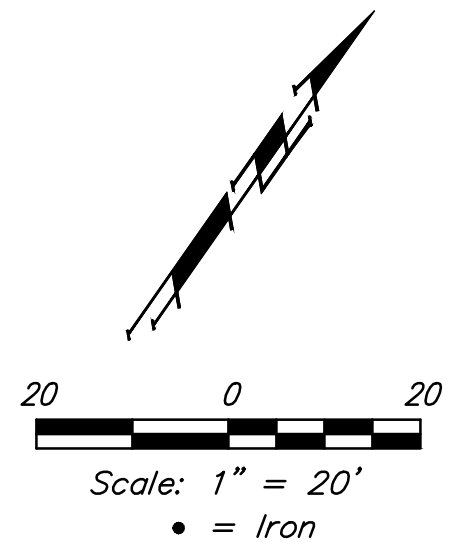

Curve #2
Curve Data Based on Centerline
Rad. = 120' Delta = 89°37'45" Tangent = 119.23'
Arc = 187.72' L.C. = 169.16' Def./Ft. = 14.32386 Min.

Station	Arc	Face Chord Lengths		Defl.	Total Defl.
		8' Left	8' Right		
9+18.04	-	-	-	0'00'00"	0'00'00"
9+25.00	6.96'	5.51'	8.41'	1'39'42"	1'39'42"
9+50.00	25.00'	19.76'	30.15'	5'58'05"	7'37'47"
9+53.11	3.11'	2.46'	3.76'	0'44'33"	8'22'20"
9+75.00	21.89'	17.31'	26.41'	5'13'33"	13'35'53"
10+00.00	25.00'	19.76'	30.15'	5'58'06"	19'33'59"
10+05.50	5.50'	4.35'	6.65'	1'18'47"	20'52'46"
10+25.00	19.50'	15.42'	23.54'	4'39'19"	25'32'05"
10+50.00	25.00'	19.76'	30.15'	5'58'06"	31'30'11"
10+75.00	25.00'	19.76'	30.15'	5'58'05"	37'28'16"
11+00.00	25.00'	19.76'	30.15'	5'58'06"	43'26'22"
11+05.76	5.76'	4.56'	6.96'	1'22'30"	44'48'52"

VALVE LOCATION TABLE

Valve Number	Baseline Station	Offset Distance	Offset Direction
1	1+16.00	26'	Lt.
2	9+58.55	23.85'	Lt.
3	11+38.75	26'	Lt.

SUBDIVISION BENCH MARKS

Street & Station	Location Description	Elevation
Woodridge 3+41.00, 17.25' Lt.	Adjacent to Fire Hydrant at NE Corner of Lot 31, Block D.	
Woodridge Ct 1+17.80, 14.25' Lt.	Adjacent to Fire Hydrant at NE Corner of Lot 16, Block C.	

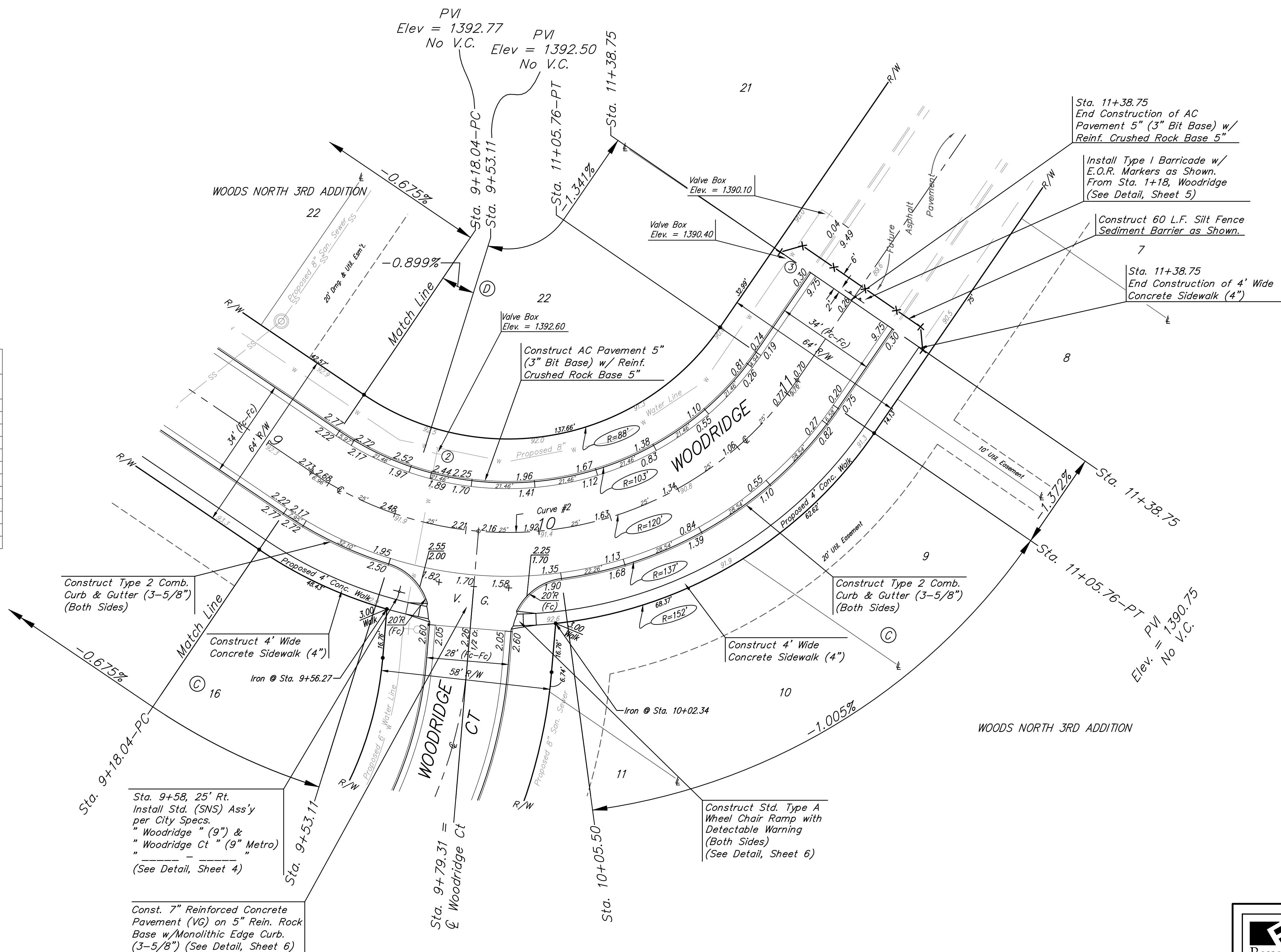

Sta. 9+58, 25' Rt. Install Std. (SNS) Ass'y per City Specs. "Woodridge" (9") & "Woodridge Ct" (9" Metro) (See Detail, Sheet 4)

Const. 7" Reinforced Concrete Pavement (VG) on 5" Rein. Rock Base w/Monolithic Edge Curb. (3-5/8") (See Detail, Sheet 6)

Type 2 Comb. Curb & Gutter (3-5/8") to be constructed on the pavement on this sheet. Top of curb elevation are given for full height curb (6-5/8").



Baughman Woods North Addition - Phase III
WOODRIDGE
Sta. 9+18.04 to Sta. 11+38.75

Baughman Company, P.A. 315 Ellis St. Wichita, KS 67211 P 316-262-7271 F 316-262-0149
ENGINEERING | SURVEYING | PLANNING | LANDSCAPE ARCHITECTURE

PROJECT NUMBER 472-85048	DESIGN AEG	DRAWN JAK
REVISIONS:	APPROVED	DATE 7/06/15
	SCALE Noted	SHEET 10 OF 22

E:\Projects\Woods North 3rd\11-12-P847\Engineering\Phase 3\STR_1503E227\STR PLANS.dwg