

- NOTE:**
- REFER TO THE WATER SERVICE TRANSFER TABLES, DRAWINGS C092 - C093 FOR METER RELOCATES.
 - INSTALL WATERMAIN BY DIRECTIONAL DRILLING UNLESS OTHERWISE NOTED.
 - FOR SANITARY SEWER CROSSINGS LESS THAN 24" VERTICAL CLEARANCE FROM WATERMAIN, REBUILD SANITARY SEWER PER SPECIFICATION 803.4a.
 - CONTRACTOR SHALL POT HOLE THE EXISTING SANITARY SEWER EVERY 250' PRIOR TO DIRECTIONAL DRILLING TO VERIFY LOCATION OF SANITARY SEWER ALONG LINE 2 (E 22ND ST N).
 - CONTRACTOR TO VERIFY METER LOCATION NOT PICKED UP BY SURVEY.
 - EXISTING SANITARY SEWER ALIGNMENT IS BELIEVED TO BE ADJACENT TO THE PROPOSED WATER MAIN ALIGNMENT AND IS SHOWN ON THE WATER MAIN PROFILE FOR THE PURPOSE OF PROVIDING ADDITIONAL CLARITY.

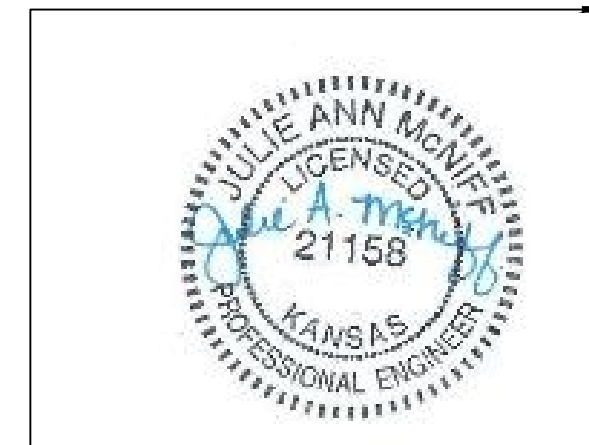

This document has been digitally signed.
05/08/15 9:39 AM

Name
Discipline
License No.

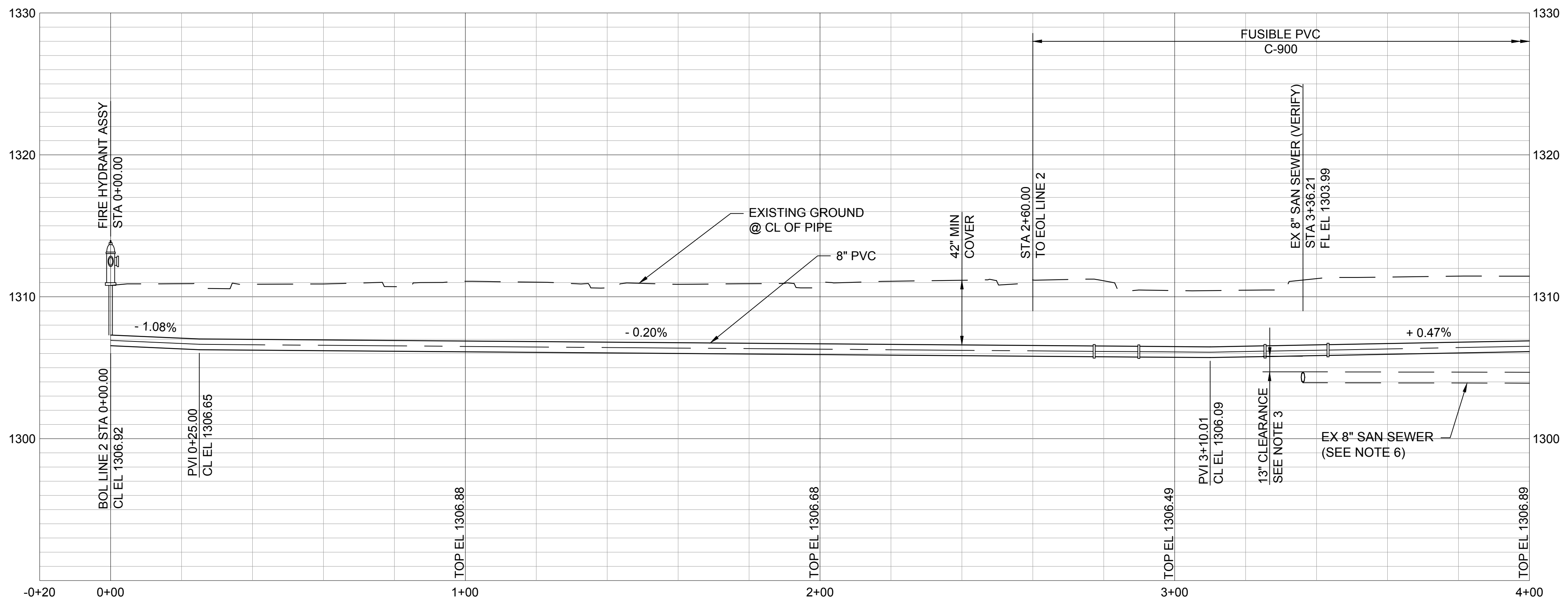
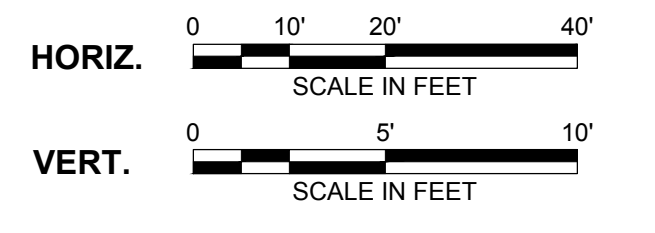

9400 WARD PARKWAY
KANSAS CITY, MO 64114
816-333-9400
LICENSEE NO. 000165

date	APRIL 24, 2014	detailed	M. CHARRETTE
designed	J. MCNIFF	checked	S. WILSON



**ETHEL NEIGHBORHOOD
WATER MAIN REPLACEMENT
LINE 2 - E 22ND STREET N**

project	77025	contract	448-90612
drawing	rev. C006 - 0		
sheet	13	of	101 sheets
file	LINE 2.dwg		