

CL ROAD STA 5+31.91, 17.53' LT
 = EOL LINE 18 STA 4+11.38
 = WL 15 STA 12+99.49
 CONNECT TO WL 15

PLUG AND ABANDON EX 2" WATERMAIN
 AT 2" TEE LOCATED 17.5' E OF SW
 CORNER OF HOUSE 3120 E 24TH ST N
 SEE DWG C039

Millimeters

Scale For Microfitting

Inches

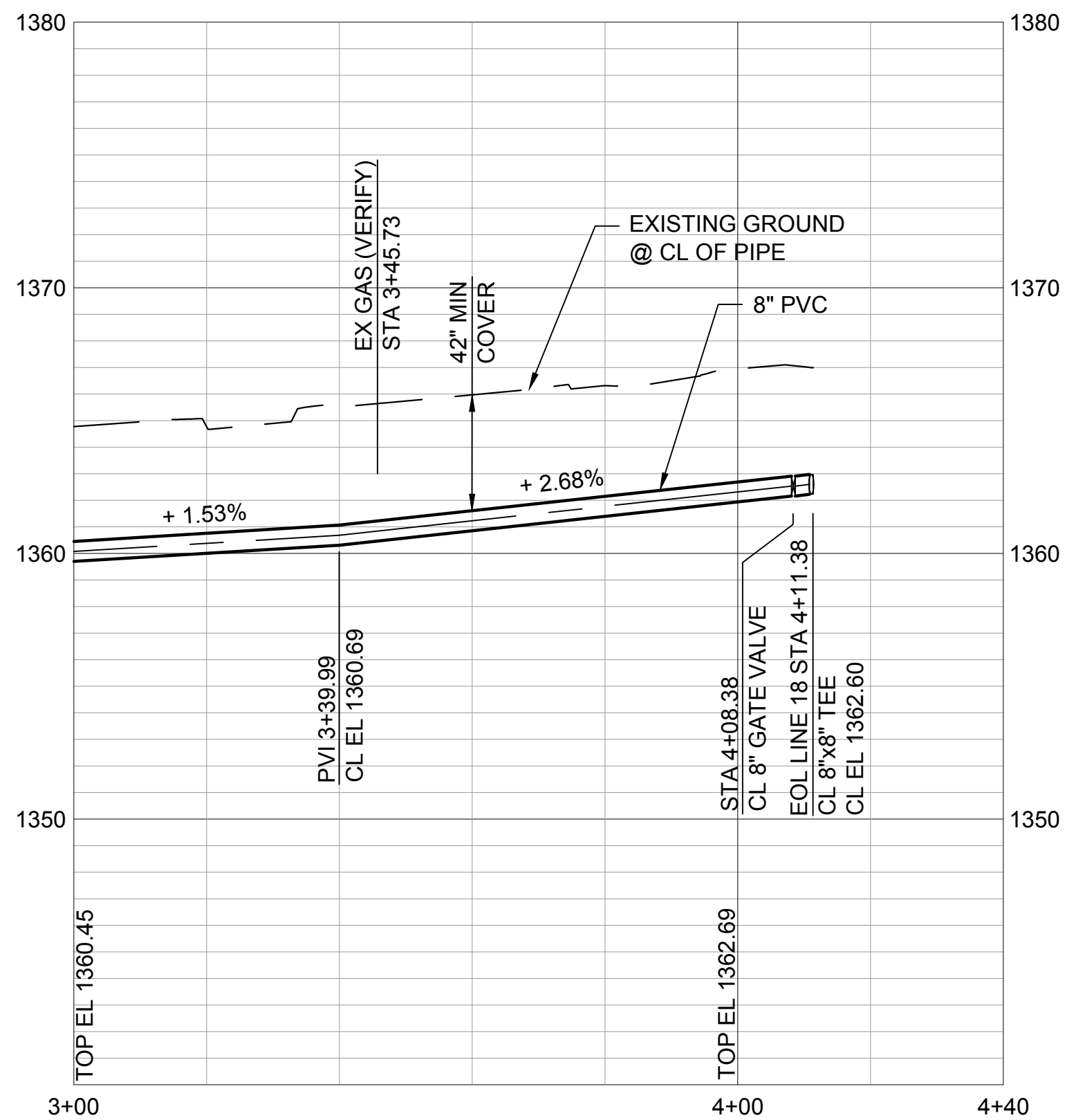

no.	date	by	ckd	description
-----	------	----	-----	-------------

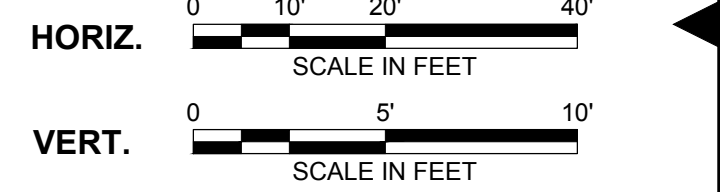

NOTE:

- REFER TO THE WATER SERVICE TRANSFER TABLES, DRAWINGS C092 - C093 FOR METER RELOCATES.
- INSTALL WATERMAIN BY DIRECTIONAL DRILLING UNLESS OTHERWISE NOTED.
- FOR SANITARY SEWER CROSSINGS LESS THAN 24" VERTICAL CLEARANCE FROM WATERMAIN, REBUILD SANITARY SEWER PER SPECIFICATION 803.4a.
- CONTRACTOR SHALL VERIFY 2487 N HILLSIDE ST WATER METER LOCATION AND TRANSFER TO NEW MAIN IF EXISTING SERVICE IS CONNECTED TO EXISTING WATER LINE ON N DERRICK ST.



9400 WARD PARKWAY
 KANSAS CITY, MO 64114
 816-333-9400
 LICENSEE NO. 000165

date	APRIL 24, 2014	detailed	M. CHARRETTE
designed	J. MCNIFF	checked	S. WILSON



This document has been digitally signed.
 05/08/15 9:52 AM

Name
 Discipline
 License No.



**ETHEL NEIGHBORHOOD
 WATER MAIN REPLACEMENT
 LINE 18 - N DERRICK STREET**

project	77025	contract	448-90612
drawing	C046 - 0		rev. 0
sheet	53	of	101 sheets
file	LINE 18.dwg		