

PLOTTED: Wednesday, July 22, 2015 @ 02:08PM

J:\PROJECTS\2011\101010577 PREMIER FOX RIDGE PLAZAS\CIVIL\CAD\PAV11577\_RN-0.DWG

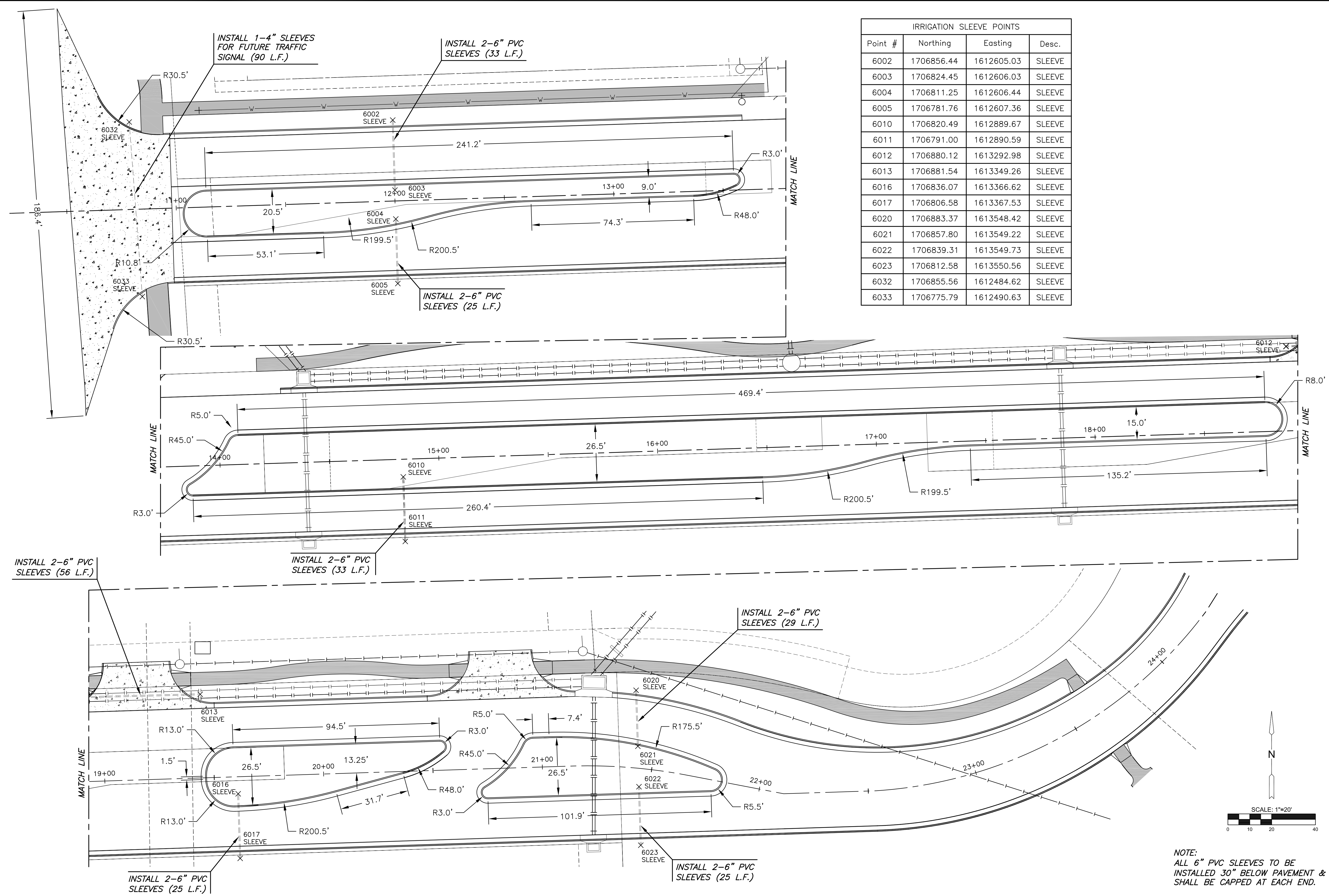

IRRIGATION SLEEVE POINTS			
Point #	Northing	Easting	Desc.
6002	1706856.44	1612605.03	SLEEVE
6003	1706824.45	1612606.03	SLEEVE
6004	1706811.25	1612606.44	SLEEVE
6005	1706781.76	1612607.36	SLEEVE
6010	1706820.49	1612889.67	SLEEVE
6011	1706791.00	1612890.59	SLEEVE
6012	1706880.12	1613292.98	SLEEVE
6013	1706881.54	1613349.26	SLEEVE
6016	1706836.07	1613366.62	SLEEVE
6017	1706806.58	1613367.53	SLEEVE
6020	1706883.37	1613548.42	SLEEVE
6021	1706857.80	1613549.22	SLEEVE
6022	1706839.31	1613549.73	SLEEVE
6023	1706812.58	1613550.56	SLEEVE
6032	1706855.56	1612484.62	SLEEVE
6033	1706775.79	1612490.63	SLEEVE



**PAVING FOR  
FOX RIDGE PLAZA ADDITION**

©2015 MKEC Engineering All Rights Reserved www.mkec.com  
 These drawings and their contents, including, but not limited to, all concepts, designs, & ideas are the exclusive property of MKEC Engineering (MKEC), and may not be used or reproduced in any way without the express consent of MKEC.

**MEDIAN DIMENSION PLAN**

PROJECT NO.	472-85166	
DATE	JULY 2015	
SCALE	1"=20'	
DESIGNED	DRAWN	CHECKED
DFL	JWC	GJA

NO.	REVISION	DATE

SHEET NO.  
13 OF 33

NOTE:  
ALL 6" PVC SLEEVES TO BE INSTALLED 30" BELOW PAVEMENT & SHALL BE CAPPED AT EACH END.

